

Brule River State Forest

Sale Name: HP PINE			Tract Number: 10-24		Estimated Volumes: TONS			
Twp: 46N	Range: 11W	Section: 26 & 27	Compartment: 18 & 19		Species	TONS 4" Top	TONS Whole Tree	Avg. DBH (inches)
Township: Bennett & Highland			Stand: 2, 8, 14	Red Pine (PR) 5650 NA 14				
Soil: Loamy Sand				Topography: Flat	Acres: 100			Minimum Bid: \$66,670
PR contains 4% white pine and 1% white spruce								

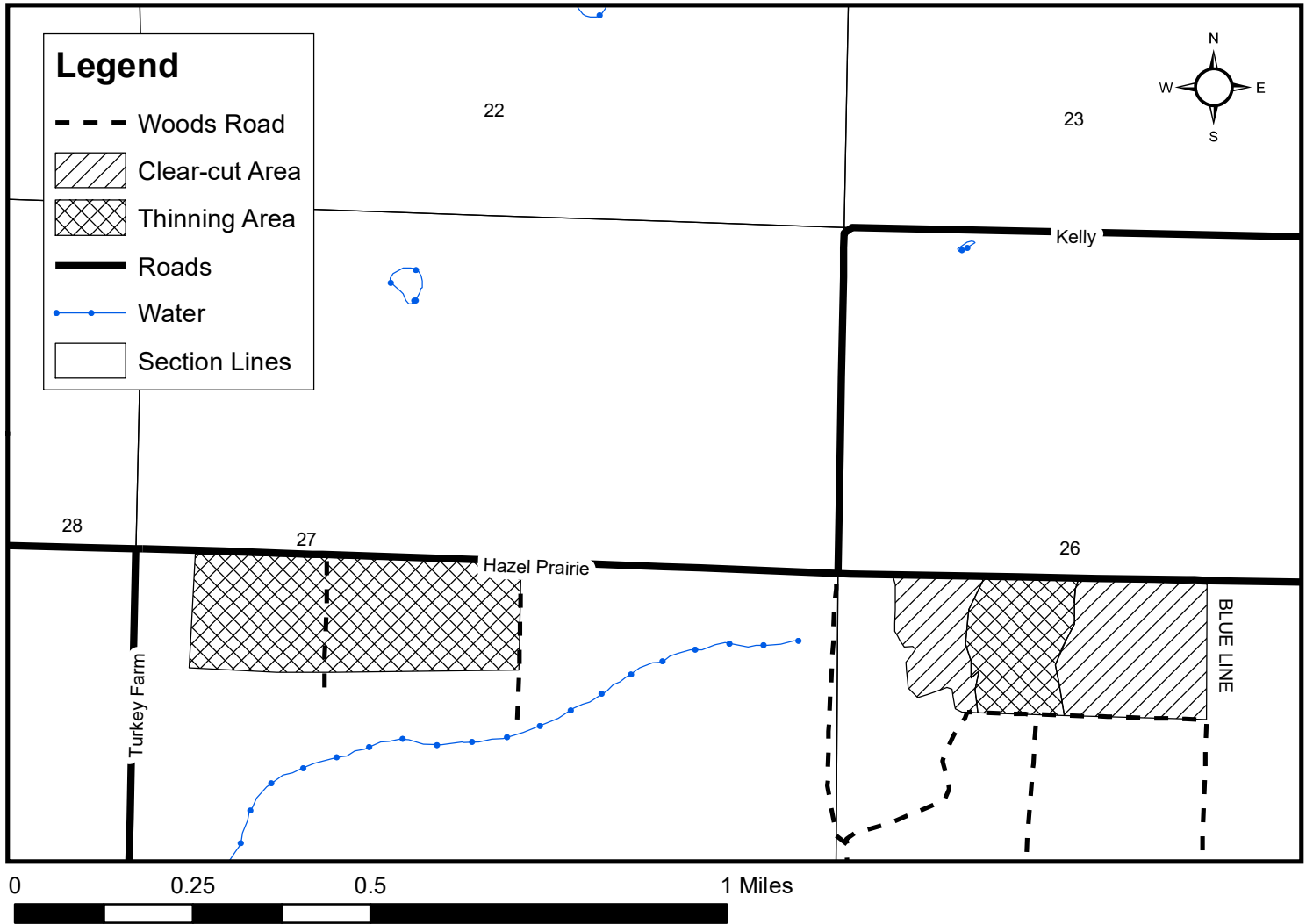

1. Sale Boundaries marked by blue paint, red paint, roads, or obvious type changes.
2. Thinning: Cut all trees marked in orange paint.
Clearcut: Cut all trees 2 DBH and larger.
3. Utilize all cut trees which contain one or more 100" stick to a 4" top diameter. Slash height must not exceed three feet in depth nor longer than 8 feet in length and must be spread evenly over site.
4. From May 15 through August 15 all cut pine products must be hauled off site within 2 weeks of harvest to mitigate pine bark beetle concerns.
5. New road and/or landing construction must be approved by property manager or contract administrator.