



# Dodo-Bird

## Tract #8002-02-22, 371 acres

### Good Neighbor Authority Sale Area Map Wisconsin Department of Natural Resources

Eagle River-Florence Ranger District  
Chequamegon-Nicolet National Forest  
T40N R11E, Section 22, 23, 26 - Vilas County, WI

DNR Contact: Kelsey Dencker: (715) 216-0286/Jason Headson: (715) 508-0129

### Legend

- Red Paint Line
- Orange Paint Line
- Double-Sided Orange Paint Line
- Seasonal Restrictions
- Aesthetic Reserve Area
- Purple-Lined Areas
- Private Boundary
- Town Roads
- CNNF Roads
- Woods Roads
- Survey Monument
- Section Corner
- Gate

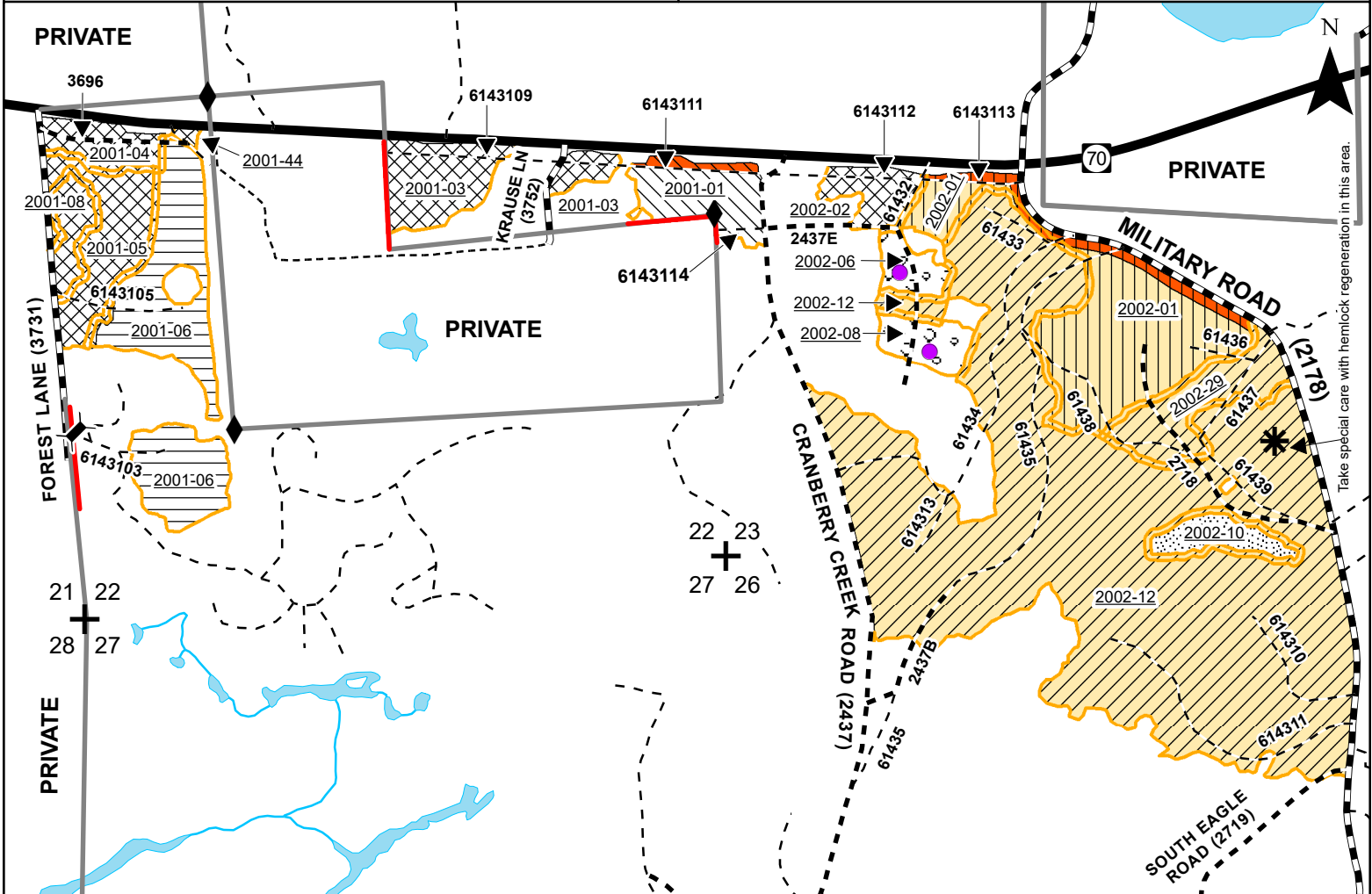

- Unit #1 - Thinning** – Stand 2001-03,04,05,08,44 & 2002-02 (50 acres): Harvest all trees marked with blue paint.
  - Unit #2 - Northern Hardwood Selection** – Stand 2002-12 & 29 (220 acres): Harvest all trees marked with blue paint. Within purple-painted gaps, harvest all trees greater than 1-inch diameter including purple-painted trees. In areas with hemlock regeneration, take special care to avoid unnecessary damage and cut balsam fir as needed for felling and skidding.
  - Unit #3 - Hemlock Hardwood** – Stand 2002-10 (5 acres): Harvest all trees marked with blue paint. Harvest during snow-free conditions if possible.
  - Unit #4 - Pine Thinning/Overstory Removal** – Stand 2002-06 & 08 (10 acres): Within the two-dot purple lined areas, harvest all merchantable trees. In the remainder of the stand, harvest all trees marked with blue paint.
  - Unit #5 - Shelterwood** – Stand 2002-01 (42 acres): Within the Aesthetic Reserve Area along Military Road and Highway 70, harvest all trees marked with blue paint. In the remainder of the stand, harvest all trees greater than 1-inch diameter except red oak and white pine saplings and trees marked with orange paint.
  - Unit #6 - Irregular Shelterwood** – Stand 2001-01 (12 acres): Within the Aesthetic Reserve Area along Military Road and Highway 70, harvest all trees marked with blue paint. In the remainder of the stand, harvest all trees marked with blue paint and all sub-merchantable trees except white pine and red oak.
  - Unit #7 - Mechanical Row Thinning** – 2001-06 (32 acres): Harvest every third row, marked with blue paint as needed to define rows.
- Stands 2002-01,12,29: Harvesting may only occur October 1st through April 15th due to oak wilt restrictions.
  - All other stands: Harvesting may occur during dry, firm, or frozen ground at the discretion of the timber sale administrator.
  - All pine products cut between May 1st and September 1st must be removed from the sale area within three weeks from time of cutting. Pine products cut during the remainder of the year must be removed prior to May 1st of each year.



**Good Neighbor Authority**  
**Wisconsin Department of Natural Resources**  
 Eagle River/Florence Ranger District  
 Chequamegon-Nicolet National Forest

**DODO-BIRD - Prospectus**  
**Tract #: 8002-02-22**

**Location:** Vilas County, WI      **Sale Area:** 371 acres

Town	Range	Section	Description
40N	11E	22	SWNW, NWSW, SWSW, S1/2NE
40N	11E	23	S½NW, SW¼, SE¼
40N	11E	26	NE¼, N½NW ¼

**Estimated Volumes and Values:**

Species	Volume
Mixed hardwood pulp <sup>1</sup>	5750 T
Aspen pulp	730 T
Balsam fir pulp	330 T
<b>Comingled red pine<sup>2</sup></b>	<b>1400 T</b>
<b>Comingled white pine<sup>3</sup></b>	<b>1400 T</b>
<b>Mixed hardwood logs<sup>4</sup></b>	<b>20 MBF</b>
<b>Red oak logs</b>	<b>15 MBF</b>
<b>Minimum advertised bid:</b>	<b>\$122,229.00</b>

All volume estimates were obtained using the 'sticks plus trees' volume estimating system. NHAL State Forest base stumpage rates used for all product values.

- Mixed hardwood pulp contains 49% red maple, 34% hard maple, 8% red oak, 5% mixed hardwoods, 4% paper birch, and 1% yellow birch.
- Comingled red pine contains 57% pulp and 43% logs.
- Comingled white pine contains 66% pulp and 34% logs (including 86% white pine, 13% jack pine and 1% hemlock).
- Mixed hardwood log volume includes 67% red maple and 33% sugar maple.

**General Harvest Information and Special Conditions:**

- No sale work may begin without prior notification and an on-site meeting with the sale administrator.
- Prior notification must be given to the sale administrator before harvesting 2002-06 & 08.
- Billing will use **mill scale ticket system. (Logs sold will be mill scaled.)**
- No bid bond required. A performance bond of 15% of the total sale bid value will be required.
- The contract period is **3 YEARS, ending June 30<sup>th</sup>, 2026.**
- Cutting areas are bounded by orange and red paint lines or established roads. See sale map for details.
- Harvesting in cutting areas (stands) must be completed prior to moving to another cutting area.
- Cutting must be concurrent for all species including required 1-5" diameter stems in the purple

gap areas.

- Reasonable care shall be taken to avoid unnecessary damage to residual trees and regeneration.
- Utilization to at least a 4-inch top.
- The harvesting of any portion of a tree that lies outside the physical ownership of the Forest Service will not be allowed. Trees lying across the property line must be bucked at the ownership line and all portions of the tree that reside on the private side of the line must be left in place. Conversely, the remaining portion of the tree that lies within the physical ownership of the Forest Service may be harvested and utilized.
- Equipment must be cleaned and inspected before entering and leaving sale area to prevent the introduction/spread of invasive species.
- All slash shall be lopped and scattered to lie within two feet of the ground for 100 feet from Highway 70, Cranberry Creek Road (2437) and Forest Lane (3731).
- Along Military Road (2178), all slash shall be lopped and scattered to lie within one foot of the ground within the Aesthetic Area (designated on the map) and shall be lopped and scattered to lie within two feet for 100 feet along the remainder of Military Road (2178).
- All other slash shall be pulled 10 feet from the edge of all roads, trails, private land, wetlands and riparian areas, and shall be lopped and scattered to lie within 4 feet of the ground.
- In all harvest areas, do not cut standing snags unless they pose a safety risk.
- **See cutting prescriptions and seasonal restrictions listed on the map.**

#### **Road and Skid Trails:**

- Purchaser is required to post signs on public trails and roads entering active harvest areas alerting recreationalists of harvest activities.
- Purchaser is responsible to obtain written permission from local town to deck wood on town roads. **No decking of wood is permitted on Military Road. No decking of wood is permitted on Forest Lane without prior permission from the Town and the DNR timber sale administrator.**
- Chequamegon-Nicolet Forest Plan requires that all native surfaced approaches to paved or graveled roads have 100 ft. of gravel, 6 in. deep, 12 ft. wide laid down when used during non-frozen conditions.
- All landings and skid trails will be blocked to vehicular access after use.
- Any new temporary roads or turn-arounds will need approval by the timber sale administrator.
- The location and clearing widths of all Temporary Roads shall be agreed to in writing before construction is started. "Temporary Roads" are roads other than Specified Roads that are constructed by Purchaser for the purpose of harvesting included timber.
- Temporary Roads shall have the road base constructed to a width of 12 feet or narrower, and with vegetative clearing of tree and brush not to exceed a width of 25 feet. Exceptions to the 12-foot maximum width of the road base may be granted by the sale administrator. Exceptions would typically be granted for sections of temporary roads where tight turns, curves, and terrain create a need so that trucks and equipment can be operated safely.
- **The following roads must be decommissioned if they are used for trucking: 614310, 6143103, 6143105, 6143108, 614311, 6143114, 614313, 61432, 61433, 61434, 61435, 61436, 61437, 61438, 61439.** In order to decommission roads as required, Purchaser shall, at locations designated by the Sale Administrator, construct two mounds at approximately 75-foot intervals with scattered slash and logging debris between the mounds. Mounds shall be at least four feet in height and shall be made with dirt mixed with rocks, stumps, logs, root-wads, or slash and shall be constructed without creating a defined trench.
- All road maintenance and rehabilitation post-harvest is the purchaser's responsibility. Please refer to the sample contract for this sale for specific road maintenance specifications. Contact DNR Forester Kelsey Dencker at the Crandon Ranger Station (715) 216-0286 for more information.

**Road Restrictions List:**

Road	Termini		Map Legend	Description of Restrictions
	From	To		
3696	Forest Lane (3731)	6143108	R, A	Hauling is prohibited on the Snowmobile Trails on Federal Holidays, weekends starting noon on Friday, through midnight Sunday, and between Christmas Day and New Year's Day. At all times during the snowmobile season, keep at least 4 inches of packed snow on the trail. Keep trail clearing (10 feet from the edge of the trail) cleared of debris resulting from purchaser's operations. Signage erected when sale is active.
6143109	6143108	Krause Lane (3752)		
6143111	Krause Lane (3752)	2437		
6143112	2437	61432		
6143113	61432	2178		
Krause Lane (3752)	HWY 70	Private Property	O, A	Road open to the public. May be used without restriction. Signage erected when sale is active.
Cranberry Creek Road (2437)	HWY 70	2437B		
2718	Military Road (2178)	End of Use		
2437B	Cranberry Creek Road (2437)	61435		
2437E	Cranberry Creek Road (2437)	End of Use		
614310	Military Road (2178)	End of Use	R	Use only during surface firm or frozen conditions.
6143103	6143102	End of Use		
6143105	Forest Lane (3731)	End of Use		
6143108	Hwy 70	Private Property		
614311	Military Road (2178)	End of Use		
6143114	Cranberry Creek Road (2437)	End of Use		
614313	61434	End of Use		
61432	2437E	6143112		
61433	61434	End of Use		
61434	Military Road (2178)	Cranberry Creek Road (2437)		
61435	2437B	Military Road (2178)		
61435	Cranberry Creek Road (2437)	2437B		
61436	61437	End of Use		
61437	Military Road (2178)	61439		
61438	61435	2718		
61439	2718	61437		

**Road Maintenance Requirements Summary:**

- Purchaser shall maintain roads, commensurate with Purchaser’s use. Roads must be left in as good or better condition than existed prior to harvest. Performance of road maintenance work by Purchaser may be required prior to, during, or after each period of use. The timing of work accomplishment shall be based on Purchaser’s operating schedule and road conditions. Specific required road maintenance specifications are included below.
- Purchaser shall maintain roads in accordance with the following Contract Road Maintenance Requirements Summary:

Road	Termini		Miles	Timing:	Applicable Road Maintenance Specifications		
	From	To		Pre Haul During Post Haul	8110	8420	8130
3696	Forest Lane (3731)	6143108	0.22 mi	All above	X	X	
6143109	6143108	Krause Lane (3752)	0.30 mi	All above	X	X	
6143111	Krause Lane (3752)	2437	0.30 mi	All above	X	X	
6143112	2437	61432	0.40 mi	All above	X	X	
6143113	61432	2178	0.10 mi	All above	X	X	
Krause Lane (3752)	HWY 70	Private Property	0.16 mi	All above	X	X	
Cranberry Creek Road (2437)	HWY 70	2437B	2.0 mi	All above	X	X	
2718	Military Road (2178)	End of Use	0.40 mi	All above	X	X	X
2437B	Cranberry Creek Road (2437)	61435	0.15 mi	All above	X	X	X
2437E	Cranberry Creek Road (2437)	End of Use	0.44 mi	All above	X	X	X
614310	Military Road (2178)	End of Use	0.20 mi	All above	X	X	
6143103	6143102	End of Use	0.20 mi	All above	X	X	
6143105	Forest Lane (3731)	End of Use	0.20 mi	All above	X	X	
6143108	Hwy 70	Private Property	0.10 mi	All above	X	X	
614311	Military Road (2178)	End of Use	0.50 mi	All above	X	X	
6143114	Cranberry Creek Road (2437)	End of Use	0.10 mi	All above	X	X	
614313	61434	End of Use	0.10 mi	All above	X	X	
61432	2437E	6143112	0.10 mi	All above	X	X	
61433	61434	End of Use	0.10 mi	All above	X	X	
61434	Military Road (2178)	Cranberry Creek Road (2437)	0.70 mi	All above	X	X	
61435	2437B	Military Road (2178)	1.00 mi	All above	X	X	
61435	Cranberry Creek Road (2437)	2437B		All above	X	X	
61436	61437	End of Use	0.10 mi	All above	X	X	
61437	Military Road (2178)	61439	0.20 mi	All above	X	X	
61438	61435	2718	0.30 mi	All above	X	X	
61439	2718	61437	0.20 mi	All above	X	X	

<u>Specification No.</u>	<u>Specification Title</u>
T-8110	Maintenance Blading/Grading
T-8130	Spot Surface Course Placement/Replenishment
T-8420	Cutting Roadway Vegetation

- T-8110: Maintenance Blading/Grading is keeping an aggregate surfaced roadbed in a condition to facilitate traffic and provide proper drainage. It includes maintaining the crown, inslope or outslope of the traveled way, turnouts, and shoulder; repairing berms; blending approach road intersections; and cleaning drainage dips and lead-off ditches.
- T-8130: Spot Surface Course Placement/Replenishment includes subgrade preparation, furnishing, hauling, spreading and shaping materials in accordance with the requirements.
- T-8420: This work includes removal of brush, trees and other vegetative growth from within the clearing limits. This may include brush mowing of shoulders to prevent larger growth which would inhibit travel in the future.

Last modified by KD: 01/10/2022

**Notice:** Completion of this form is mandatory. The Department will not recognize your bid unless you complete and submit this form. Personal information collected will be used for program administration and may be provided to requesters as required by Wisconsin's Public Records law [ss. 19.31-19.39, Wis. Stats.].

Date

Bidder Name

Street Address	City	State	ZIP Code
----------------	------	-------	----------

Property Name (if any) Chequamegon-Nicolet National Forest - Eagle River - Florence District	Timber Sale Name Dodo-Bird	Tract Number 8002-02-22
---	-------------------------------	----------------------------

Date and Hour of Bid Opening 09/15/2022 1:30 PM	Minimum Acceptable Bid (optional) \$122,229.00
--	---

Species-All bids including Lump Sum bids must be by species	Utilization Specifications (4 inch/Whole Tree/Logs)	Estimated Volume	Volume Units (tons/cords/mbf)	Price Bid Per Unit	Total Bid Value on Estimated Volume
Mixed Hardwood Pulp	Pulp	5,750	T		
Aspen Pulp	Pulp	730	T		
Balsam Fir Pulp	Pulp	330	T		
Comingled Red Pine	Pulp	1,400	T		
Comingled White Pine	Pulp	1,400	T		
Mixed Hardwood Logs	Logs	20	MBF		
Red Oak Logs	Logs	15	MBF		

The award shall be based on this TOTAL BID AMOUNT:

**Performance Bond**

Will be in the form of: (select one)

- |  |   |
|--|---|
| <input type="radio"/> Personal Check               | <input type="radio"/> Assurance Bond                |
| <input type="radio"/> Certified Check/Money Order  | <input type="radio"/> Certificate of Deposit        |
| <input type="radio"/> Irrevocable Letter of Credit | <input type="radio"/> Assignment of Savings Account |

I understand that any or all bids may be rejected and that consideration and awarding of a contract will be based upon my past performance and ability to complete contracts. **I also understand that if I am the winning bidder, I have 6 weeks from the date of the bid opening to submit an acceptable performance bond. I also understand that if I am awarded the contract and fail to execute it or work under it, I will be required to forfeit to the Department an amount equal to 10% of my total bid amount.** Failure to forfeit the 10% penalty will result in being considered ineligible to bid on any state timber sales for a two-year duration. In the event the highest bidder can not or will not sign the contract, the award may be made to the next highest qualified bid.

By checking this box, I certify that I hold a Wisconsin Master Logger Certification.

**Notice:** I understand:

Utilization specifications and estimated volumes are listed in the prospectus which is available upon request from the Department.

A copy of the standard timber sales contract which must be entered into is available upon request from the Department.

Signature of Bidder
Bidder's Name (Please Print or Type)
Phone Number (include area code)
Email Address