

Good Neighbor Authority Sale Area Map
Wisconsin Department of Natural Resources

Joe Creek/Homestead Red Pine Sale
 Medford-Park Falls Ranger District
 Chequamegon-Nicolet National Forest
 T32N-R2W, Sec 10 & 15
 Taylor County
 Tract Number: 8001-03-18

NORTH UNIT
60 ACRES

Legend

- ⊕ Section Corner
- Orange Boundary Paint
- ▬ Town Roads
- ⋯ USFS Roads
- Streams

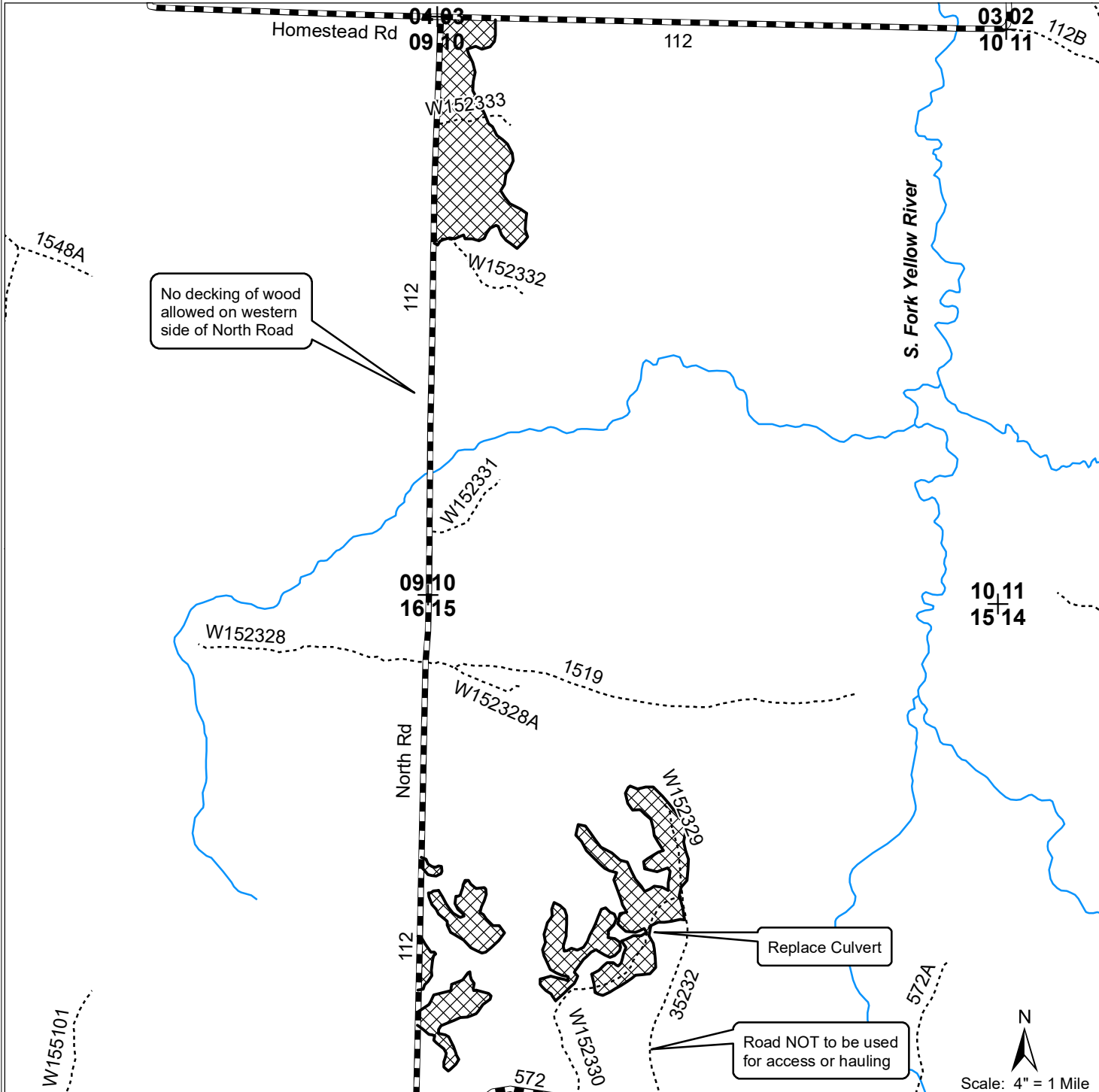

Red Pine Thinning (60 Acres): Harvest all 1) blue marked trees, 2) merchantable aspen, 3) balsam fir with one or more 100 inch sticks. Do NOT cut trees marked with orange paint.

***In all stands - Harvesting will be conducted during frozen ground conditions only.**

Scale: 4" = 1 Mile
 1:15,840



Map produced by
 Scott Lindow &
 Paul Schultz 07/10/2018

Good Neighbor Authority Sale Area Map







Wisconsin Department of Natural Resources

Joe Creek/Homestead Red Pine Sale
 Medford-Park Falls Ranger District
 Chequamegon-Nicolet National Forest
 T31N-R2W, Sec 5 & 8
 T32N-R2W, Sec 10 & 15
 Taylor County
 Tract Number: 8001-03-18

OVERVIEW MAP

114 ACRES

Legend

-  Section Corner
-  Orange Boundary Paint
-  USFS Roads
-  Town Roads
-  Lakes and Rivers
-  Streams
-  Sale Areas

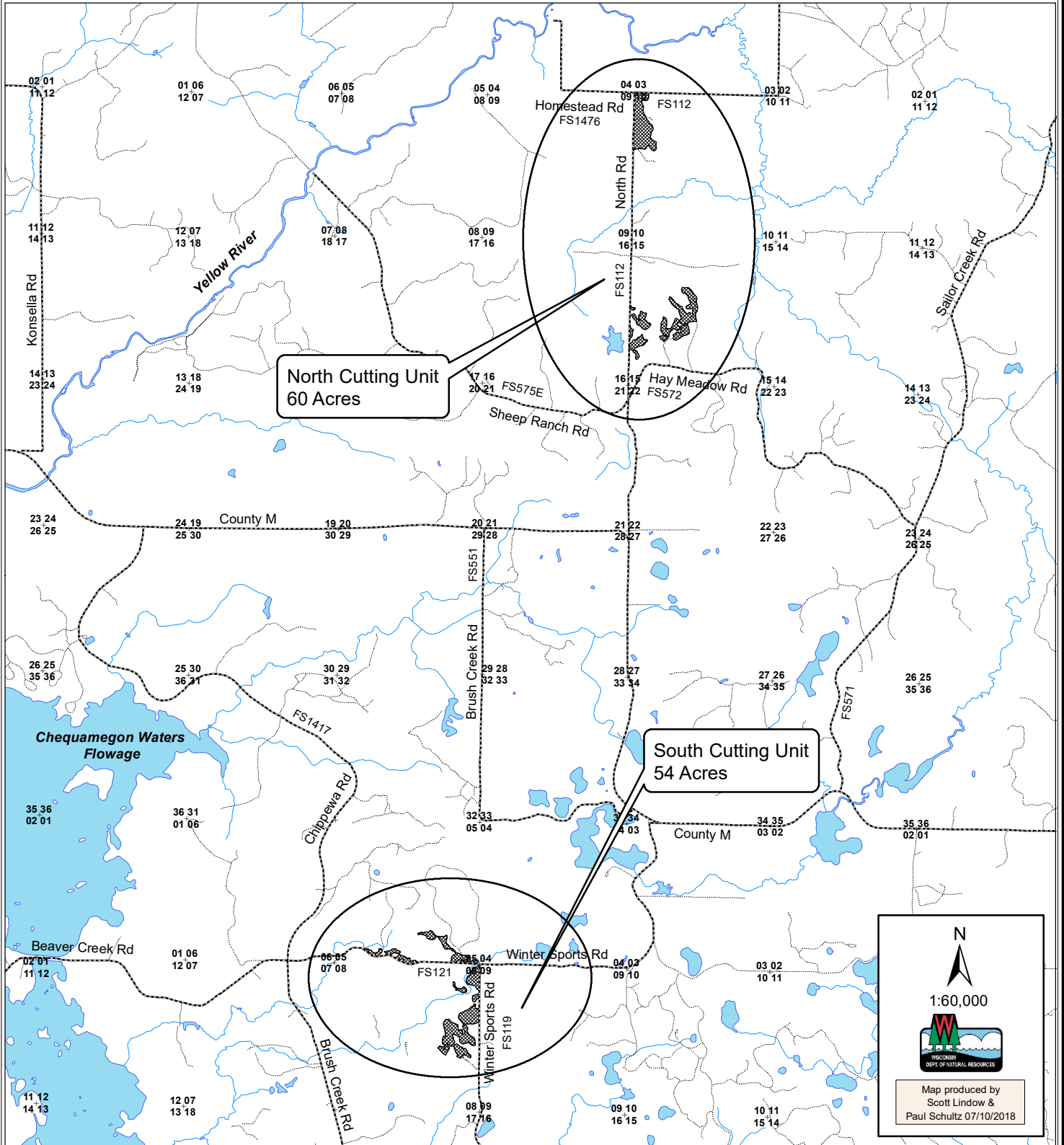

Map produced by
 Scott Lindow &
 Paul Schultz 07/10/2018

Good Neighbor Authority Sale Area Map
Wisconsin Department of Natural Resources

Joe Creek/Homestead Red Pine Sale
 Medford-Park Falls Ranger District
 Chequamegon-Nicolet National Forest
 T31N-R2W, Sec 5 & 8
 Taylor County
 Tract Number: 8001-03-18

SOUTH UNIT
54 ACRES

| Legend | |
|--------|-----------------------|
| + | Section Corner |
| — | Orange Boundary Paint |
| —●— | ATV/Recreation Trails |
| —+—+— | Town Roads |
| --- | USFS Roads |
| ++++ | Temporary Roads |
| ■ | Lakes and Rivers |
| — | Streams |

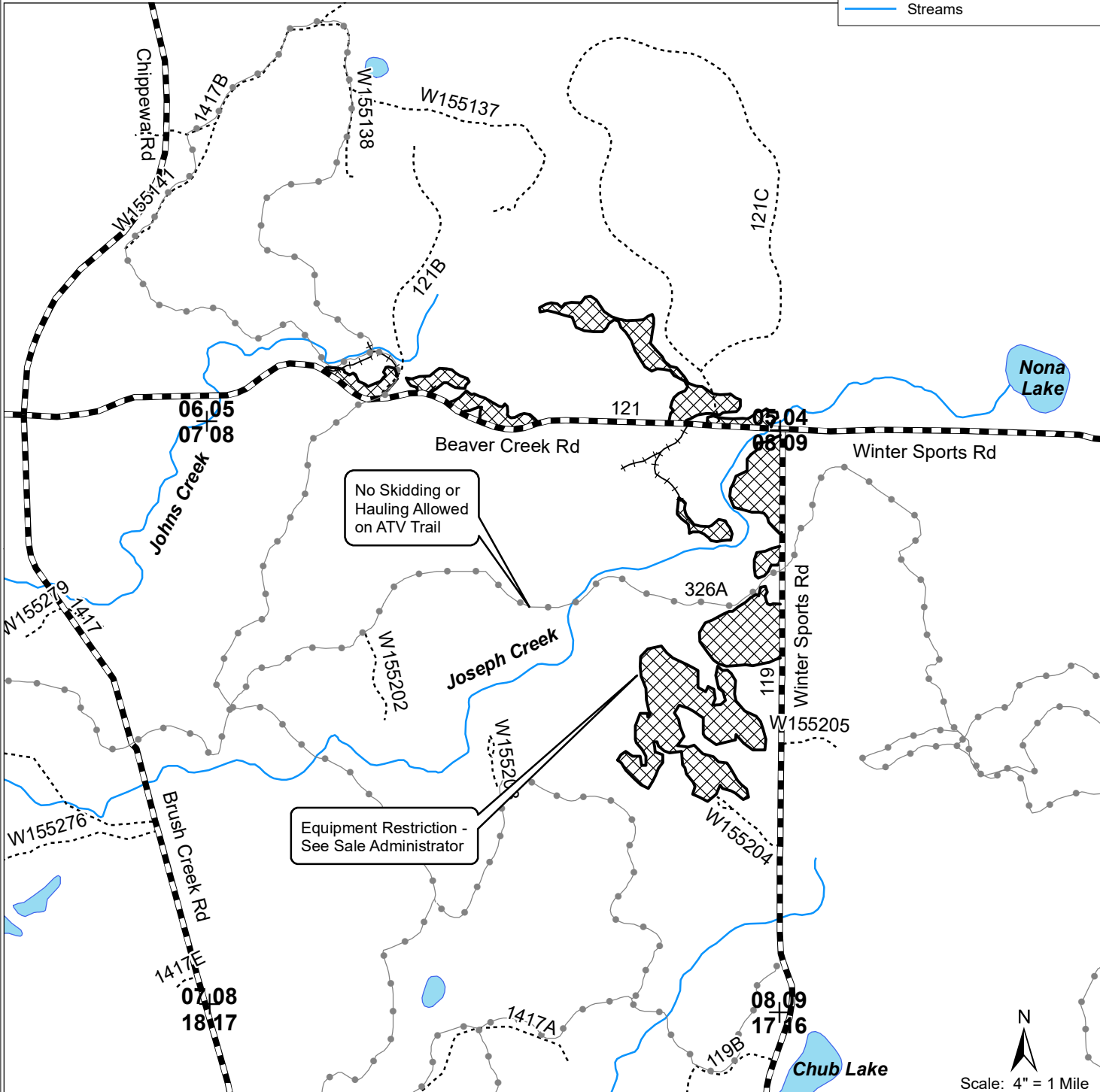

 Red Pine Thinning (54 Acres): Harvest all 1) blue marked trees, 2) merchantable aspen, 3) balsam fir with one or more 100 inch sticks. Do NOT cut trees marked with orange paint.

***In all stands - Harvesting will be conducted during frozen ground conditions only.**

N
 Scale: 4" = 1 Mile
 1:15,840



Map produced by
 Scott Lindow &
 Paul Schultz 07/10/2018



**WISCONSIN DEPARTMENT OF NATURAL RESOURCES
GOOD NEIGHBOR AUTHORITY PROJECT
Medford/Park Falls Ranger District
Chequamegon-Nicolet National Forest
TRACT #8001-03-18**

SALE NAME: Joe Creek/ Homestead

Location: T31N R2W portions of Section 5&8, T32N-R2W Sections 10&15, all in the Town of Grover, Taylor County, WI

Sale Area: 114 Acres

Sale Type: Scaled Sale. (Mill scale for all products.)

| <u>SPECIES</u> | <u>ESTIMATED VOLUME</u> | <u>ADVERTISED VALUE</u> |
|-----------------------|------------------------------------|--------------------------------|
| ¹ RED PINE | 4500 TONS | \$15.10/TON |
| ² MX HW | 190 TONS | \$6.80/TON |
| ASPEN | 110 TONS | \$7.70/TON |
| BALSAM | 20 TONS | \$4.30/TON |
| SPRUCE | 80 TONS | \$6.80/TON |

Minimum Acceptable Bid: \$70,719.00

¹Red pine volume includes an estimate 570 MBF of sawtimber with an average cut DBH of 12-14 inches.

²MX HW volume includes approx. 85% red maple, 9% hard maple, and 6% basswood. Including 7 MBF red maple, 1 MBF basswood, and 4 MBF hard maple.

-Conversion rates utilized: Red pine- 2.250, Balsam-2.125, Aspen-2.250, MX-2.413, Spruce-2.000

-Sawlog conversions: 2.44 cds/MBF for softwoods, 2.20 cds/MBF for hardwoods.

-Species not mentioned will be charged the MX price.

-Species product bids may be less than advertised value, but more than \$0.00 and bid must meet or exceed the total Minimum Acceptable Bid of \$70,719.00.

Harvest Requirements-General:

- Do not cut orange marked trees.
- Harvest all 1) blue marked trees, 2) merchantable aspen, 3) balsam fir with one or more 100" sticks.
- The sale's boundaries are indicated by orange paint, Winter Sports Road, Beaver Creek Road, North Road, and Homestead Road.
- Leave all standing snag and den trees that do not pose a safety hazard.

Harvest Requirements-Seasonal Restrictions:

- Harvesting will be conducted during **frozen ground conditions only**.
- **Special Heterobasidial Root Disease (Annosum) Treatment Provision:** To prevent the introduction and/or spread of Heterobasidial Root Disease, a borax-based product, such as Cellu-Treat or a biofungicide treatment of RotStop C shall be applied (according to label instructions and FS special provision R9-CT6.41#) to all pine stumps within 24 hours of harvest. Treatment is required during harvest activities from **April 1 to Dec. 31**. Harvest areas must be treated concurrently with harvesting by a DATCP Certified Pesticide Applicator. Proof of Certification will be required. Blue dye (such as Hi-Light) shall be added to the liquid chemical treatment in a manner consistent with the label. The DNR forester may inspect any or all stumps and must be able to validate that treatment has been done successfully. Slash, sawdust and other debris shall be kept off treated stumps so that these inspections can be done. The DNR reserves the right to inspect and test the contractor's chemical tank at any time during the harvesting operations to make sure that proper treatment procedures are being followed. Missed stumps, poor chemical coverage, or stumps that are inaccessible for inspection may be considered a contract violation and may lead to termination of harvesting operations until the situation can be remedied to the satisfaction of the DNR. Additionally, the type and amount of chemical used will need to be reported to the DNR on forms provided by the Department.

Harvest Requirements:

- Sale will be mill scale using a 30-day billing period.
- No bid bond required. A performance bond of 15% of the total sale value will be required. 2-year contract length. Utilization to at least a 4" top.
- All logging debris shall be kept within sale boundaries.
- Equipment must be cleaned and inspected by DNR Staff before entering and leaving the sale area to prevent the introduction/spread of invasive species.
- Logging Operations Ahead signs (DOT approved) are required to be placed along town roads during harvest and hauling operations.
- All decked wood must be removed from the sale prior to April 1st of each year.
- Additional areas with skidding and decking restrictions are shown on the map.
- Care must be used while felling, bucking, and skidding to protect the residual stand.
- No decking on North Road, Winter Sports Road, Beaver Creek Road, or Homestead Road without permission from the Town of Grover.

Slash Requirements:

- A 10-foot slash removal zone and slash height less than 24" will be applied within 100 feet of all town maintained roadways.

Road/Trail Requirements:

- ATV trails are **NOT** to be utilized for harvesting operations on this sale.
- Purchaser is responsible for the purchase and installation of (1)- 15"x20' double-walled plastic culvert at location indicated on map. Installation will require approximately 12 yards of gravel fill to cover culvert.
- Contractor is responsible for attaining decking permission along town maintained roads. Decking locations will be discussed at pre-sale meeting.
- Chequamegon-Nicolet Forest Plan requires that all native surfaced approaches to paved or graveled roads have 100 ft. of gravel, 6 in. deep, 12 ft. wide put down when used during non-frozen conditions.
- **NO** wood shall be decked on the west side of North Road. (FR 112)
- If Temporary roads are used they will need to be closed. Berm height will be 4-5 feet high to detour the use of off road travel. Berm material can be: soil or rocks (large boulders unable to move with manpower or truck, as well as slash and/or stumps piled

within temporary road corridor for a distance of at least 100 feet, beginning at the location of where berm will be established. Slash and/or stumps shall be in enough quantity to discourage vehicle traffic. Do not dig a depression that will collect and hold water when constructing berms.

- All road maintenance and rehabilitation post-harvest is the purchaser's responsibility. A sample contract including road maintenance specifications can be obtained by request.

Maggie Lorenz- Forester, (715) 492-1970, **email:** Margaret.Lorenz@wisconsin.gov
Park Falls Service Center
875 S. 4th Ave.
Park Falls, WI 54552