

Appendix M

Figures from Eastern Expansion Feasibility Report

TRC - GIS

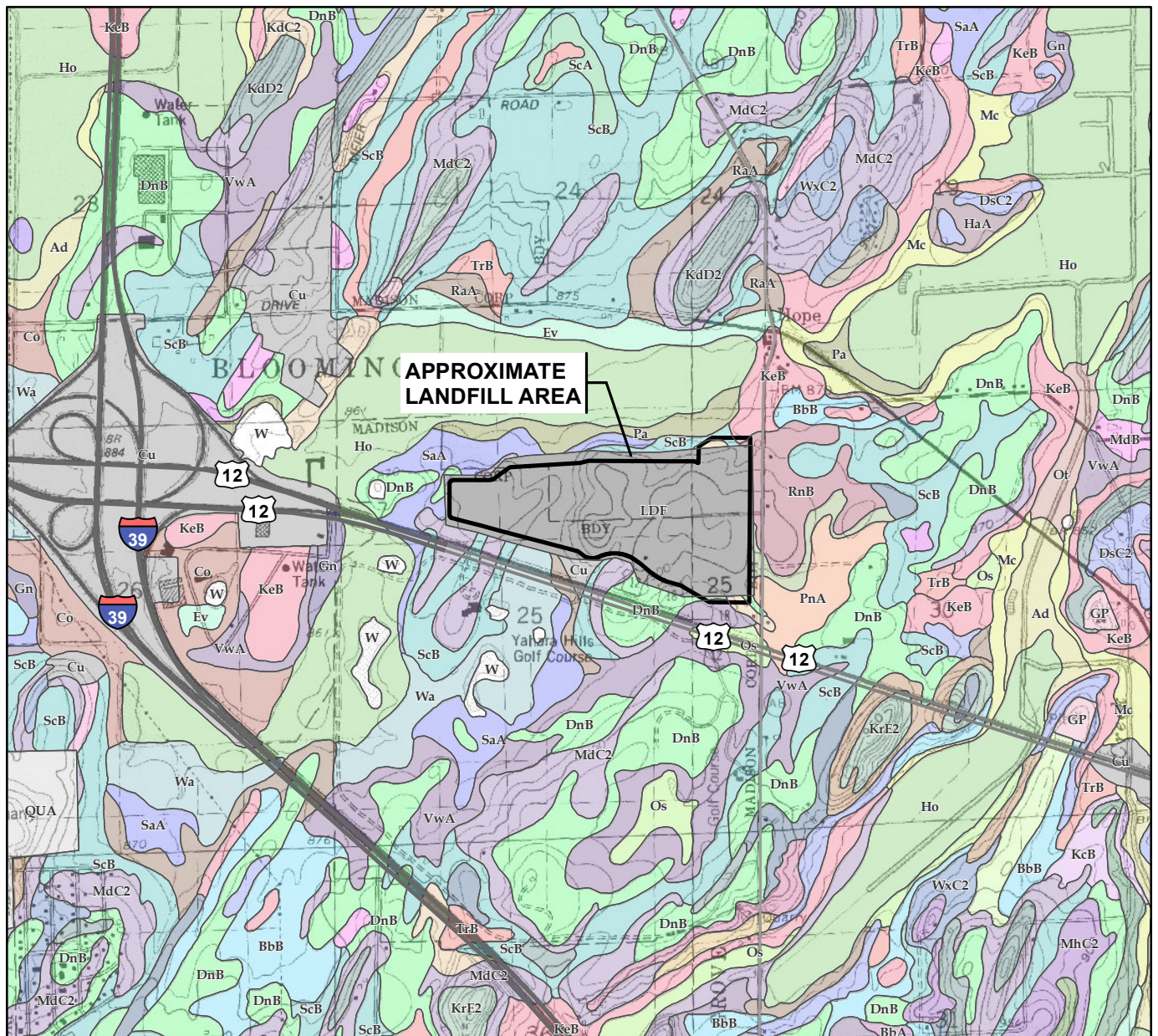

SOIL TYPES

- Ad - Adrian muck
- BbA - Batavia silt loam, gravelly substratum, 0 to 2 percent slopes
- BbB - Batavia silt loam, gravelly substratum, 2 to 6 percent slopes
- Co - Colwood silt loam
- DnB - Dodge silt loam, 2 to 6 percent slopes
- DnC2 - Dodge silt loam, 6 to 12 percent slopes, eroded
- DrD2 - Dresden loam, 12 to 20 percent slopes, eroded
- DsB - Dresden silt loam, 2 to 6 percent slopes
- DsC2 - Dresden silt loam, 6 to 12 percent slopes, eroded
- DuD2 - Dubarton silt loam, 12 to 20 percent slopes, eroded
- Ev - Elvers silt loam
- GP - Gravel pit
- Gn - Granby loamy sand
- HaA - Hayfield silt loam, 0 to 3 percent slopes
- Ho - Houghton muck
- KcB - Kickapoo fine sandy loam, 2 to 6 percent slopes
- KdC2 - Kidder loam, 6 to 12 percent slopes, eroded

SOIL DATA FROM USDA - NRCS, SOIL SURVEY GEOGRAPHIC DATABASE (SSURGO).

- KdD2 - Kidder loam, 12 to 20 percent slopes, eroded
- KeB - Kegonsa silt loam, 2 to 6 percent slopes
- KrD2 - Kidder soils, 10 to 20 percent slopes, eroded
- KrE2 - Kidder soils, 20 to 35 percent slopes, eroded
- Mc - Marston silt loam
- MdB - McHenry silt loam, 2 to 6 percent slopes
- MdC2 - McHenry silt loam, 6 to 12 percent slopes, eroded
- MdD2 - McHenry silt loam, 12 to 20 percent slopes, eroded
- MhC2 - Military loam, 6 to 12 percent slopes, eroded
- MhD2 - Military loam, 12 to 20 percent slopes, eroded
- Os - Orion silt loam, wet
- Ot - Otter silt loam
- Pa - Palms muck
- PeC2 - Pecatonica silt loam, 6 to 12 percent slopes, eroded
- PnA - Plano silt loam, 0 to 2 percent slopes
- PnB - Plano silt loam, 2 to 6 percent slopes
- RaA - Radford silt loam, 0 to 3 percent slopes
- RnB - Ringwood silt loam, 2 to 6 percent slopes
- SaA - Sable silty clay loam, 0 to 3 percent slopes
- ScA - St. Charles silt loam, 0 to 2 percent slopes
- ScB - St. Charles silt loam, 2 to 6 percent slopes
- ScC2 - St. Charles silt loam, 6 to 12 percent slopes, eroded
- TrB - Troxel silt loam, 1 to 3 percent slopes
- VrB - Virgil silt loam, 1 to 4 percent slopes
- VwA - Virgil silt loam, gravelly substratum, 0 to 3 percent slopes
- Wa - Wacousta silty clay loam
- WxB - Whalan silt loam, 2 to 6 percent slopes
- WxC2 - Whalan silt loam, 6 to 12 percent slopes, eroded
- WxD2 - Whalan silt loam, 12 to 20 percent slopes, eroded
- Cu - Cut and fill land
- LDF - Landfill
- QUA - Quarry
- W - Water

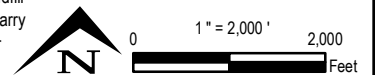

708 Heartland Trail
Suite 3000
Madison, WI 53717
Phone: 608.826.3600

FEASIBILITY REPORT DANE COUNTY NO. 2 (RODEFELD) LANDFILL EASTERN EXPANSION

SITE AREA SOILS

DRAWN BY:	PAPEZ J
APPROVED BY:	DM/JO
PROJECT NO:	194528-02-05
FILE NO.	194528-02-05-006soil.mxd
DATE:	MAY 2013

FIGURE 6-1

TRC - GIS

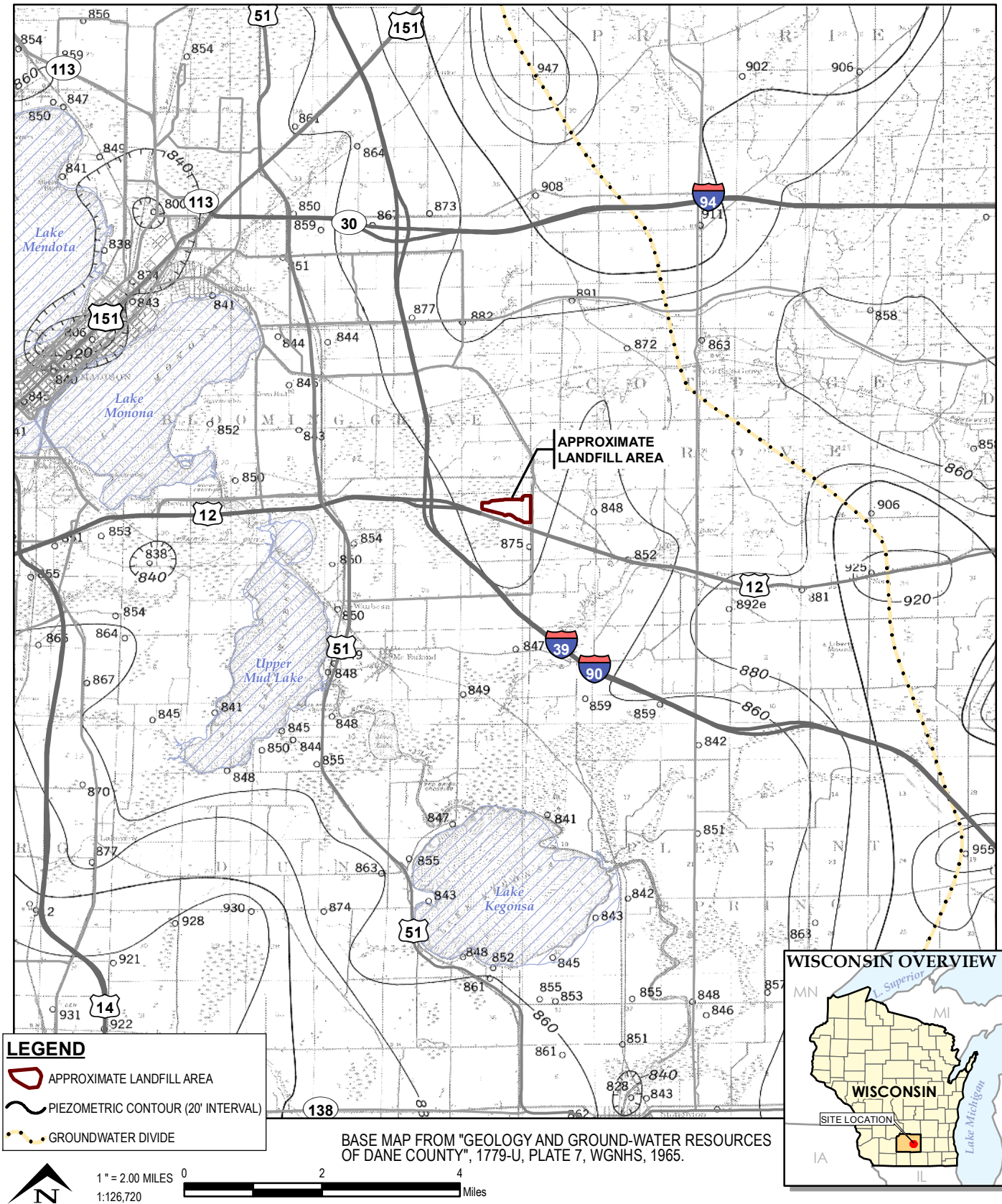

708 Heartland Trail
Suite 3000
Madison, WI 53717
Phone: 608.826.3600

DANE COUNTY NO. 2 (RODEFELD) LANDFILL EASTERN EXPANSION

REGIONAL PIEZOMETRIC SURFACE

DRAWN BY:	PAPEZ J
APPROVED BY:	JO
PROJECT NO:	194528
FILE NO.	194528-02-05-007piez.mxd
DATE:	MAY 2013

FIGURE 6-2