

State of Wisconsin  
 Department of Natural Resources  
[dnr.wi.gov](http://dnr.wi.gov)

**Motorized Recreation Grant Application**

**For:** (choose all that apply) Form 8700-159 (R 02/2024)

- ATV/UTV Trail Aid
- Snowmobile Trail Aid

**Due Date: April 15**

**Notice:** Completion of this form is required under Wisconsin Statutes 23.09(26) and 23.33. Failure to complete this form will result in denial of financial assistance. Personally identifiable information found on this form is not intended to be used for any other purpose. The Department of Natural Resources (DNR) may provide this information to requesters as required by Wisconsin's Public Records law (ss. 19.31 – 19.39, Wis. Stats.).

**Instructions:** Applications may combine more than one source of funds. They may be submitted for consideration of traditional ATV, UTV, Snowmobile and Motorized Stewardship funding. Submit one copy of all forms and attachments. See Page 2 for necessary attachments. Send applications to your [Community Services Specialist](#).

DNR Use Only	
Category	Number

**Section 1: Applicant Information**

Applicant / Organization Name Outagamie County Parks			Check Recipient: Individual other than authorized individual to act on behalf of the applicant. <input type="checkbox"/> Select if the same as applicant.		
Individual Authorized to Act on Behalf of Applicant per Resolution Sarah Sura			Check Recipient Name (Name to Appear on Check) Outagamie County Parks - Loren Dieck		
Title Program Manager			Title Parks Director		
Address 1375 E Broadway Dr			Address 1375 E Broadway Dr		
City Appleton	State WI	ZIP Code 54913	City Appleton	State WI	ZIP Code 54913
Telephone Number 920-832-4791		Email Address sarah.sura@outagamie.org			

**Section 2: Project Information Required for all Projects**

Project Title Bridge Redecking					Current Funded Miles 20	New Miles (if applicable)
County Outagamie	Township 22 N	Range 17	Section 19	¼ ¼ NW	¼ SW	GPS Coordinates: Lat. 44.36720 Long. 88.49545

**Project Description Summary**

Redeck planking on bridge. Install 2 I-Beams to carry more weight as recommended by engineer.

I certify that all maintenance land use agreements are on file.

**Estimated Cost**

Maintenance	Acquisition	Insurance	Development	Bridge Rehab.	Trail Rehab.	Total Estimated Cost
Leave Blank – DNR Use Only						

**Applicant Certification**

Printed Name of Authorized Official Loren Dieck	Official's Title Parks Director
--	------------------------------------

As the applicant's authorized official, I certify that, to the best of my knowledge, the information in this application is true and correct.

  
 Signature of Authorized Official

4/10/24  
 Date Prepared

**Motorized Recreation Grant Application**

Form 8700-159 (R 02/2024)

Page 3 of 5

**Appendix A – Required for Bridge Rehab/Replace, New, or Reroute with New Bridge**

Bridge Rehab/Replace     New Bridge     Reroute with new bridge

County Outagamie	Township 22 N	Range 17	<input checked="" type="radio"/> E <input type="radio"/> W	Section 19	¼ ¼ NW	¼ SW	GPS Coordinates: Lat. 44.36720 Long. 88.49545
Water Body Name Bear Creek				Bridge Name Outagamie Conservation Club Bridge		County Inventory Number	
Funded Trail Name or Number (SNARS if applicable) 25-2-HV				Has this bridge site ever received development or rehabilitation funds in the past? <input type="radio"/> Yes <input checked="" type="radio"/> No    Year: _____ \$ _____			
Bridge is located on: <input checked="" type="radio"/> Private property <input type="radio"/> Public property				Old Bridge/Culvert Size 40 foot New Bridge/Culvert Size 40 Foot			
Landowner Where Bridge is Located Outagamie Conservation Club				Telephone Number 920 739-9211		Length of Trail Use Agreement (5 year minimum) Endless	
Current maximum load 5000 lbs.		Age of Bridge 33		Bridge Material			
Proposed maximum load 25000 lbs.		Steel Frame- Wood Decking					
Sponsoring Club Name Hill & Valley Riders				Club Contact Gary Timm		Telephone Number 920 841-6177	
Do you have your trail bridges posted as to maximum load? <input type="radio"/> Yes <input checked="" type="radio"/> No				What is the maximum load of the other bridges on the system if groomed with this bridge?			
What is the weight of your puller & drag/grading equipment? 20000				1 Other Bridge that carries 60000. That is a farm bridge On property owned by Gary Timm			
What other recreational trail uses are planned for this bridge? no							
If there are other Recreational uses planned, how much of the bridge cost will be paid for by non-snowmobile or non-ATV users?							

- Yes     No    Have you contacted your local [DNR Water Management Specialist \(WMS\)](#) regarding a permit?
- Yes     No    Is a permit needed? (Please provide any written correspondence from WMS.)
- Yes     No    Have you contacted your County Zoning Dept. regarding a floodplain determination?
- Yes     No    Will an H & H (hydrologic and hydraulic) study be required?

**Bridge Project Detailed Description**

Old Decking will be removed. 2 more I- beams will be installed.

New decking will be installed

Labor mostly will be by Snowmobile club

May need to hire a welder to weld I- beams in place

Appendix A (continued)

Summarize Costs in Appropriate Categories:

<b>Bridge Structure</b>	
-------------------------	--

	Quote 1	Quote 2
	<input type="radio"/> Steel <input checked="" type="radio"/> Wooden 40 X 14	<input type="radio"/> Steel <input checked="" type="radio"/> Wooden 40 X 14
Bridge Dimensions:	_____	_____
Bridge Manufacturer:	_____	_____
Design Weight Load	_____ 25000 lbs.	_____ 25000 lbs.
Cost of Structure:		
1. Engineering	\$ 0	\$ 0
2. Structure	\$ 5645	\$ 7327.87
<b>Subtotal</b>	<b>\$ _____</b>	<b>\$ _____</b>

	Quote 1	Quote 2
	<input type="radio"/> Contractor or <input checked="" type="radio"/> Sponsor Estimate	<input type="radio"/> Contractor or <input checked="" type="radio"/> Sponsor Estimate
<b>Installation Costs:</b>		
1. Engineering	\$ 0	\$ 0
2. Site Preparation	\$ _____	\$ _____
3. Abutments	\$ _____	\$ _____
4. Pilings/Piers	\$ _____	\$ _____
5. Approaches	\$ _____	\$ _____
6. Riprap	\$ _____	\$ _____
7. Labor	\$ 500	\$ 500
8. Equipment Rental	\$ _____	\$ _____
9. Culverts	\$ _____	\$ _____
10. H & H Study	\$ _____	\$ _____
11. Wetland Delineation	\$ _____	\$ _____
12. Other _____	\$ _____	\$ _____
<b>Subtotal</b>	<b>\$ _____</b>	<b>\$ _____</b>
<b>Total Cost</b>	<b>\$ _____</b>	<b>\$ _____</b>

**For the application grant, you must take the lowest of the two quotes.**

<b>Entire Deck and Railing Projects</b>	<input type="radio"/> Contractor <input type="radio"/> Sponsor <input checked="" type="radio"/> Club
---	--

Bridge Dimensions:	_____ 40 X 14
Design Weight Load	_____ 25000 lbs.
1. Materials	\$ _____
2. Labor	\$ 500.00
<b>Total</b>	<b>\$ _____</b>

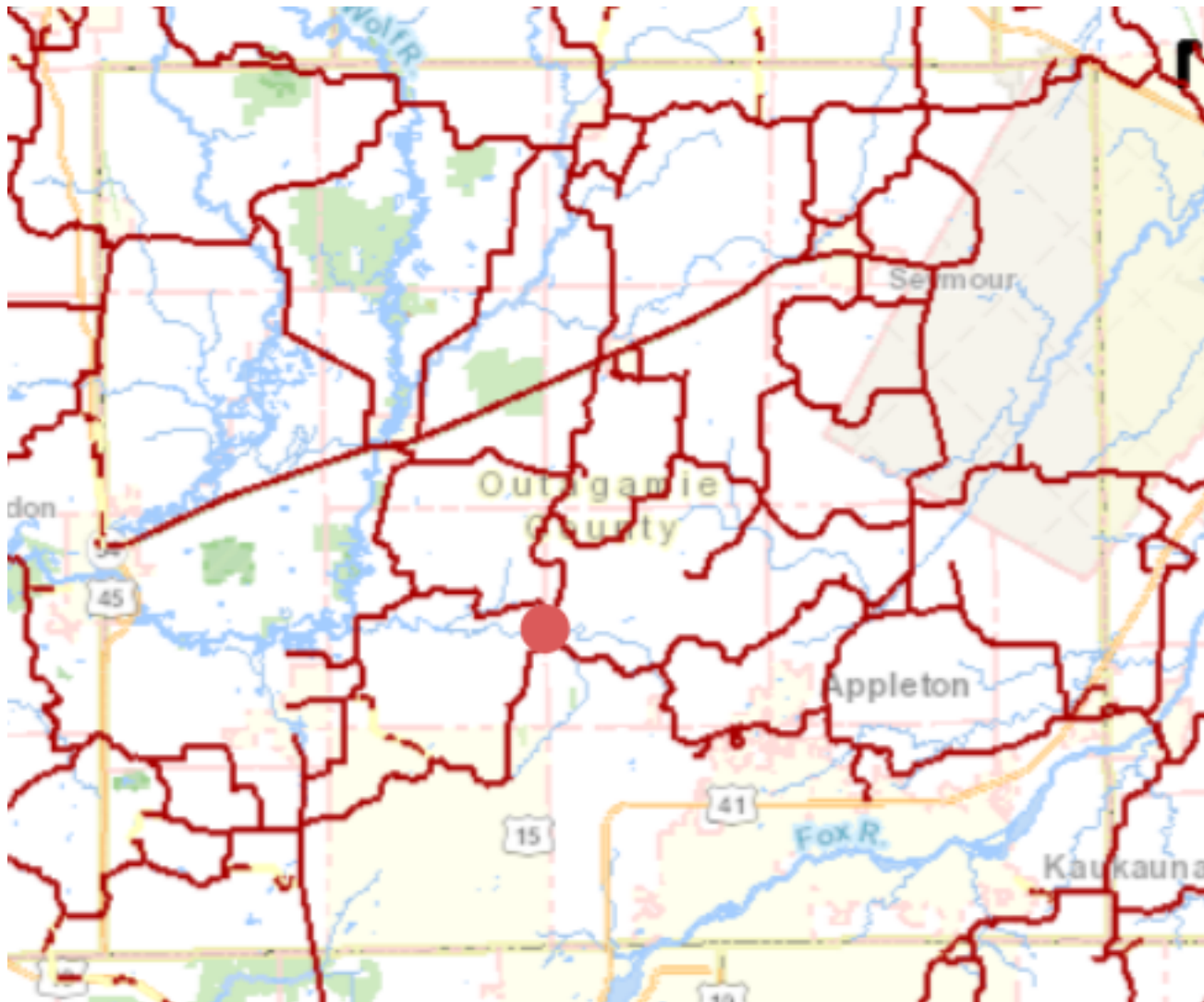
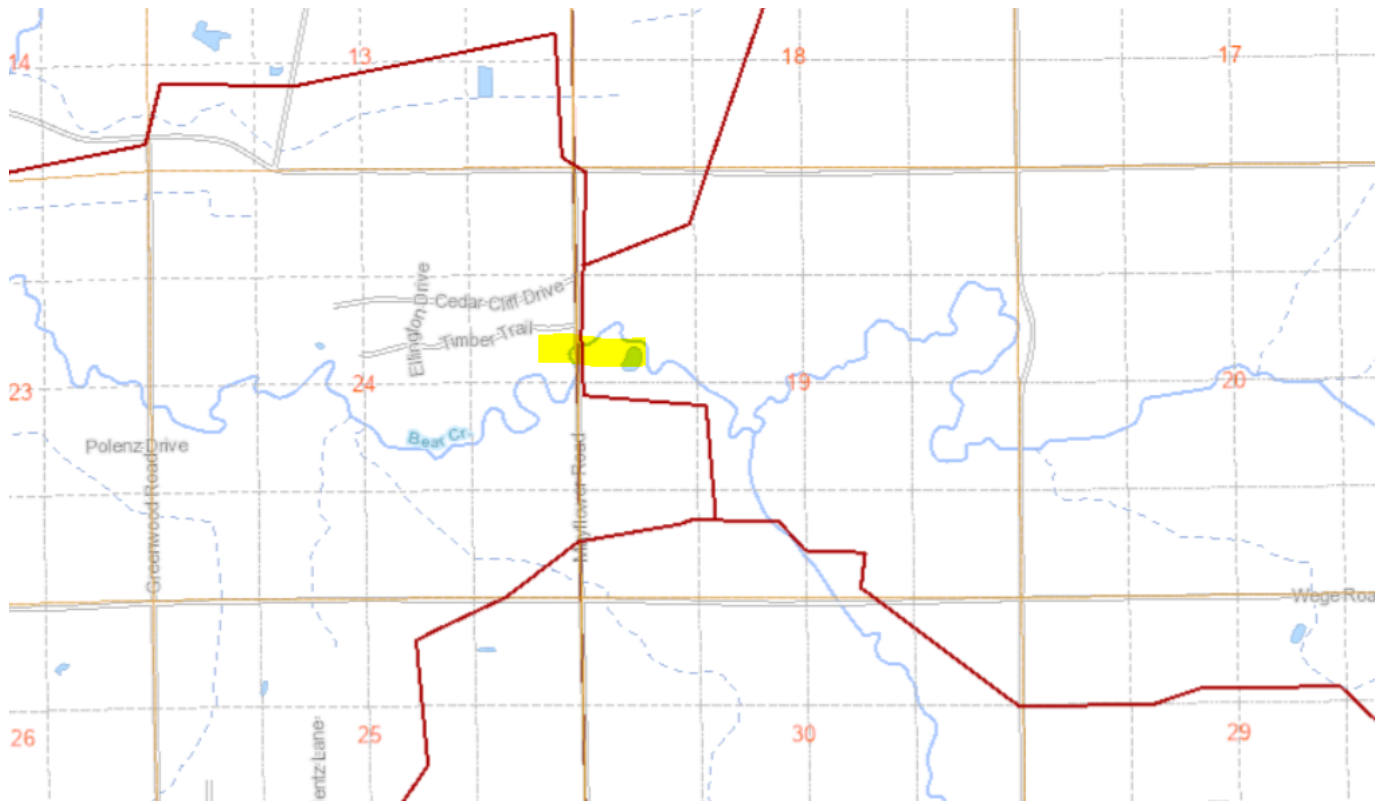

Guidelines for Applicant

Complete this form for each bridge structure you are submitting a grant application for. Provide any additional documents not requested on application checklist to substantiate your points, including actual deeded easements.

Category		Possible Points	Actual Points
1	<b>Condition of the Structure</b> (max of 10 points)		
	Has a certified bridge inspection report that supports the project & demonstrates need (see example, must provide copy of report by August 1 for 2024 only)	10	10
2	<b>Permits</b> (maximum points 4)		
	Consultation with DNR Water Mgmt Specialist has occurred & permit is likely, if needed	1	
	Permit in hand / Bridge already permitted	3	
3	<b>Funding</b> (maximum points 2) Are other funds already committed?		
	50% or greater from other funding source(s)?	2	
	11% - 49% from other funding source(s)?	1	
4	<b>Length of Written Easements or Land Use Agreement</b> (max points 5)(ch. 23.09(26)(am)1 WI Stats)		
	On public land (County, State, Federal)	5	
	10 or more year <b>deeded easement</b> on private land or other public land, for <u>all portions of that trail to the nearest road on each side of the bridge</u>	5	
	3-9 year <b>deeded easement</b> on private land or other public land, for <u>all portions of that trail to the nearest road on each side of the bridge</u>	4	
	10 or more year <b>deeded easement</b> on private land or other public land, for <u>just the bridge site</u>	3	
	3-9 <b>deeded easement</b> on private land or other public land, for <u>just the bridge site</u>	2	
	10 or more year land use agreement (LUA, not deeded) on private land or other public land	1	
	3-9 year land use agreement (LUA, not deeded) on private land or other public land	0	
5	<b>Miles Impacted</b> – How many miles will need to rerouted if the structure is not replaced? Measured from nearest intersection on both sides of the bridge. (max 4 points)		
	Less than 20 miles	1	
	20 miles or more	3	3
	No other snowmobile trails connect. Explain:	4	
<b>DEDUCTIONS</b>			
6	<b>County Active Project Deduction</b> (maximum deduction 1 point) A snowmobile active project is one that has exceeded it's initial grant period.		
	Two or more active projects - deduct 1 point	-1	
<b>GRAND TOTAL</b>			13

Comments/Notes:





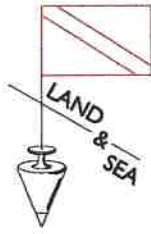

BEYOND 24 LEAGUES, LLC

March 23, 2024

Outagamie Co. Conservation Club  
% Gary Timm  
N3502 Mayflower Rd.  
Hortonville, WI 54944



MARCH 25<sup>TH</sup> 2024

**BRIDGE INSPECTION**



Prepared for

Outagamie Co. Conservation Club  
N3502 Mayflower Rd.  
Hortonville, WI 54944

Professional Engineering and Under Water Diving Services

David Pheifer, P.E.  
1120 W. Cecil St  
Neenah, WI 54956

(920) 378-1719  
dpheifer@gmail.com



A foundation and structure inspection was performed on March 21, 2024, for a steel beam structure with a wood deck and concrete and stone abutments. The structure is on the property of the Outagamie County Conservation Club and serves as the crossing of Bear Creek on the service road between the two halves of the property. The inspection was conducted by David Pheifer, P.E. of Beyond 24 Leagues, LLC. at the request of Gary Timm, Trail Boss, of the club.

The structure was constructed approximately 30 years ago and consists of two concrete abutments poured on the stone foundation of a previous structure. Superstructure is a 40-foot span with a 12-foot width and span is supported by 2-S24"x 90# beams with an additional S12" x 31# beam that supports the 3x8 timber wood deck. (6) 20' long by 4' wide wood pads have been added to the deck riding surface to reinforce the existing timber decking. Railing is 4 runs of 4x4s with a 6x6 curb, supported on 6 steel posts on 8-foot spacings. Approaches and roadway are gravel aggregate.



VIEW OF ABUTMENT AND UNDERSIDE OF SUPERSTRUCTURE

Abutments are in sound condition.

Railings are solid and will meet requirements for pedestrian hand rail.

Steel superstructure is in excellent condition and has been well maintained.

Loading capacity of structure is 100#/SF snow / Pedestrian load and 25,000 LB. Vehicle load.

Timber deck needs to be replaced. The size of timber decking will determine long term maximum vehicle load.

- 3"x8" deck timbers 5000# (F150 pickup)
- 4"x8" deck timbers 7500# (F250 pickup)
- 6"x8" deck timbers 17,000#

Place new deck timbers to match existing bolt spacing in existing beams.

To utilize the full capacity of the structure (25,000#) or to upgrade the lighter plank capacity, there are several options available.

1. Longitudinal running planks could be added.
2. Laminated planking stood on edge could be used.
3. Add a 12" beams between the outside S24 beams and the S12 center beam. This would not be too difficult if done when the existing timber deck is removed during replace.

If you would like to pursue any of these options, I would be happy to work with you. Please feel free to contact me at (920)378-1719 to discuss.

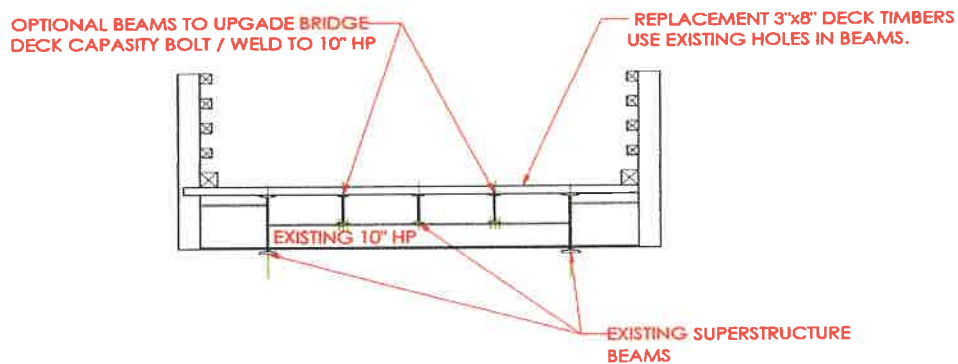

Beyond 24 Leagues, LLC.

David Pheifer, P.E.



# Liebovich Steel & Alum North

3801 Electric City Blvd  
Kaukauna, WI 54130

Attn: GARY TIMM

Page: 1  
4/04/24

800/646-2790  
920/759-3500

Fax: 920/759-6269

99999 GARY TIMM  
3801 ELECTRIC CITY BLVD  
KAUKAUNA WI 54130-9606

Quotation #: 9510689  
Ordered By: GARY TIMM  
Purch Ord#:  
Date Req:  
Inside Contact: Laura Hietpas  
Outside Contact: \*\*\* House \*\*\*

Item#		Weight	Footage	Unit Price	Extended Price
1	2 WF BEAM A992 PC 12 X 35.00 X 40'-0'' (480.000)	2800		1500.00 EACH	3000.00

Freight Included 2800

Sub-Total:	3,000.00
Tax:	165.00
Total:	3,165.00

Quote Does Not Include 2.5% Credit Card Surcharge.

All Prices Valid for 24 Hours  
- or -  
Subject to Availability

This quotation is made subject to and in accordance with Liebovich Bros., Inc. Terms and Conditions of Sale, which can be found on our website at [www.liebovich.com](http://www.liebovich.com). Your acceptance of this quotation shall indicate an acceptance of these Terms and Conditions.

8:12

1:56



100

RAIDIES  
SAW  
MILL

BIG FALLS  
WISCONSIN  
715-851-1689

### Board Feet Calculator



Price/BF

Quantity

Height  '  "

Width  '  "

Length  '  "

Board Feet **1792.00**

Total Cost **\$2240.00**

[Clear All](#)



# Liebovich Steel & Alum North

3801 Electric City Blvd  
Kaukauna, WI 54130

Attn: GARY TIMM

Page: 1  
4/04/24

800/646-2790  
920/759-3500

Fax: 920/759-6269

99999 GARY TIMM  
3801 ELECTRIC CITY BLVD  
KAUKAUNA WI 54130-9606

Quotation #: 9510689  
Ordered By: GARY TIMM  
Purch Ord#:  
Date Req:  
Inside Contact: Laura Hietpas  
Outside Contact: \*\*\* House \*\*\*

Item#		Weight	Footage	Unit Price	Extended Price
1	2 WF BEAM A992 PC 12 X 35.00 X 40'-0'' (480.000)	2800		1500.00 EACH	3000.00

Freight Included 2800

Sub-Total:	3,000.00
Tax:	165.00
Total:	3,165.00

Quote Does Not Include 2.5% Credit Card Surcharge.

All Prices Valid for 24 Hours  
- or -  
Subject to Availability

This quotation is made subject to and in accordance with Liebovich Bros., Inc. Terms and Conditions of Sale, which can be found on our website at [www.liebovich.com](http://www.liebovich.com). Your acceptance of this quotation shall indicate an acceptance of these Terms and Conditions.

Date 01/11/2022 :  
**Quotation**



**Company:** Miller Electric  
**Address:** 1635 W. Spencer Street  
**City:** Appleton, WI 54914  
**Attn:**

We are pleased to submit the following quotation to you for your consideration

QTY.	U/M	PART NUMBER	DESCRIPTION	UNIT PRICE	EXTENDED
400	ea	K520	1/2-13X5 CARRIAGE BOLT FULL THREAD TRIVALENT CLEAR ZINC	\$ 0.5100	\$ 204.00
400	ea	NAF5	1/2-13 FINISHED HEX FULL NUT ZINC	\$ 0.0400	\$ 16.00
400	ea	WU55	1/2 STANDARD FLAT WASHER ZINC (.557X1.368X.086)	\$ 0.0500	\$ 20.00
Total					\$ 240.00

Bill Timm  
SALES REPRESENTATIVE



# ZABEL'S

Sawmill & Forest Products

E9491 Cty Rd T New London, WI 54961

(920) 982-2534 250-2303



CUSTOMER ORDER NO.			PHONE	DATE		
Gary Timm			920-841-6177			
NAME Hill Valley Riders						
ADDRESS Snowmobile Club						
CITY		STATE		ZIP		
PAYMENT DUE WITHIN 30 DAYS. 1 1/2% PER MONTH AFTER 30 DAYS.			SHIPPING INV. #	CASH	C.O.D.	CHARGE ON ACCT.
PCS.	SIZE	L'GTH	DESCRIPTION	FEET	PRICE	AMOUNT
64			3x8x14			
			ASH or OAK			
			OAK		100.00	6400.00
			ASH		48.00	<del>4800</del>
			4" x 8" ASH		64.00	3072.00
						4096.00
TAX EXEMPT			<input type="checkbox"/> MFG.	<input type="checkbox"/> RESALE	<input type="checkbox"/> GOV'T SALES	5.5% TAX
RECEIVED BY					TOTAL	

6059

All claims and returned goods MUST be accompanied by this bill.

Thank You

# FASTENAL®

Price Quotation  
CONFIDENTIAL

03/26/2024

CURRENCY CASH ACCT  
1050 N. Perkins St.  
Appleton, WI 54914 USA  
Phone: 920.841.6177  
Fax: (920)738-7266  
ATTN: Cash Sale

The store serving you is:  
Fastenal Company  
5790 Midwest Dr  
GRAND CHUTE, WI 54914 USA  
Phone: 920/738-0300  
Fax: 920/738-1924  
Email: WIAPP@stores.fastenal.com

Account #: APPLCASH  
Quote #: 150727

PO #: Hill & Valley Riders Snowmobil  
Job #: Gary Timm

Due Date:  
Expiration Date: 04/26/2024

<u>Part #</u>	<u>Customer Part #</u>	<u>Description</u>	<u>Quantity</u>	<u>Price/C</u>	<u>Extended Price</u>
21573		CB1/2-13X5 Z KEG	400	\$99.0000	\$396.00
33012		USS F/W 1/2 Z	400	\$16.9000	\$67.60
36310		1/2"-13 FHN Z 5	400	\$16.9600	\$67.84
<b>TOTAL (USD):</b>					<b>\$531.44</b>

Jason

Thank you!



\*Shipping & Handling charges are subject to change.



3243 French Road  
De Pere, WI 54115  
Phone: (920) 532-4227  
Fax: (920) 532-4787  
www.simetals.com



April 01, 2024  
10:24:57AM  
Page 1 of 1

**Quotation No. 401202410**

Bill To CASH - De Pere  
          , WI

Ship To CASH  
          , WI  
          Phone:  
          ATTN: gary timm

Customer P.O. #: quote  
Terms: COD  
Sales 1: Andy Schmidt  
Contract:

F.O.B.: Customer Pick up  
Sales 2:

Ship Via: Will Call  
Due Date: 04/01/2024  
Quote Date: 04/01/2024

Order Qty	Description	Width	Length	Weight	Price	UM	Extension Tax
2	12 X 31.8# - HR S BEAM		40' 0"	2,544.00	\$ 2,017.00	E	\$4,034.00 T

Total Weight 2,544.00

Subtotal Non taxable **\$0.00**  
Subtotal taxable **\$4,034.00**  
Brown County: 5.50% **\$221.87**  
Total **\$4,255.87**

Unloading Instructions:  
Receiving Hours:  
Max Bundle Weight: 0  
Spacers

Messages: