

**Motorized Recreation Grant Application**

For: (choose all that apply)

ATV/UTV Trail Aid

Snowmobile Trail Aid

**Due Date: April 15**

**Notice:** Completion of this form is required under Wisconsin Statutes 23.09(26) and 23.33. Failure to complete this form will result in denial of financial assistance. Personally identifiable information found on this form is not intended to be used for any other purpose. The Department of Natural Resources (DNR) may provide this information to requesters as required by Wisconsin's Public Records law {ss. 19.31 – 19.39, Wis. Stats.}

**Instructions:** Applications may combine more than one source of funds. They may be submitted for consideration of traditional ATV, UTV, Snowmobile and Motorized Stewardship funding. Submit one copy of all forms and attachments. See Page 2 for necessary attachments. Send applications to your Community Services Specialist.

DNR Use Only	
Category	Number

<b>Section 1: Applicant Information</b>					
Applicant / Organization Name Monroe County			Check Recipient: Individual other than authorized individual to act on behalf of the applicant. <input type="checkbox"/> Select if the same as applicant.		
Individual Authorized to Act on Behalf of Applicant per Resolution Chad Ziegler			Check Recipient Name (Name to Appear on Check) Monroe County Treasurer		
Title Snowmobile Coordinator			Title		
Address 14345 County Highway B, STE 5			Address 14345 County Highway B, STE 5		
City Sparta	State WI	ZIP Code 54656	City Sparta	State WI	ZIP Code 54656
Telephone Number (608) 269-8635		Email Address chad.ziegler@co.monroe.wi.us			

<b>Section 2: Project Information Required for all Projects</b>							
Project Title Wells Bridge					Current Funded Miles 322.1	New Miles (if applicable)	
County Monroe	Township 16 N	Range 3	Section 29	1/4 1/4 NE	1/4 SW	GPS Coordinates: Lat. 43.834929 Long. -90.761293	

**Project Description Summary**  
Replace the snowmobile bridge between Leon and Melvina across the Little La Crosse River. The existing bridge was not built to hold the weight of the current grooming units. The groomer operators have to drive off trail to the nearest town road to cross the river and get back on the trail.

**Abutments on south end washing out. Project would rebuild abutments, widen bridge and add railings to make a safer crossing.**

I certify that all maintenance land use agreements are on file.

Estimated Cost						
Maintenance	Acquisition	Insurance	Development	Bridge Rehab.	Trail Rehab.	Total Estimated Cost
Leave Blank – DNR Use Only						

<b>Applicant Certification</b>	
Printed Name of Authorized Official Chad Ziegler	Official's Title Snowmobile Coordinator

As the applicant's authorized official, I certify that, to the best of my knowledge, the information in this application is true and correct.

Chad M Ziegler  
Signature of Authorized Official

4/12/23  
Date Prepared

<b>Checklist for Maintenance and Projects</b>		
<b>Snowmobile</b>	<b>ATV/UTV</b>	
<input checked="" type="checkbox"/>	<input type="checkbox"/>	
<input type="checkbox"/>	<input type="checkbox"/>	Project is on public land and I will be applying for RTP funds for this project. \$
<input type="checkbox"/>	<input type="checkbox"/>	Land Acquisition – consult your Regional Grant Specialist for required procedures
<b>Maintenance</b>		
<input type="checkbox"/>	<input type="checkbox"/>	Current trail map identifying funded/unfunded miles.
<input type="checkbox"/>	<input type="checkbox"/>	Troutes – identify gas tax or no gas tax
<b>Bridge Rehab/Replace/New, Re-Route w/bridge – Must complete Appendix A</b>		
<input checked="" type="checkbox"/>	<input type="checkbox"/>	Quality photos showing need for rehabilitation (no snow photos)
<input checked="" type="checkbox"/>	<input type="checkbox"/>	County wide trail map showing bridge location on the funded trail
<input checked="" type="checkbox"/>	<input type="checkbox"/>	Aerial, wetland, topo, and plat maps showing bridge location with trails overlaid
<input checked="" type="checkbox"/>	<input type="checkbox"/>	Detailed construction plans (show length, width, rail height and approaches)
<input type="checkbox"/>	<input type="checkbox"/>	
<input type="checkbox"/>	<input type="checkbox"/>	Reroute - trail map showing old trail and proposed new trail with bridge location
<input type="checkbox"/>		
<input type="checkbox"/>		
	<input type="checkbox"/>	Identify season - Summer, Winter, Year-Round (Winter include rules)
<b>Trail Rehab/Qualified Route – Must complete Appendix B</b>		
<input type="checkbox"/>	<input type="checkbox"/>	Quality photos showing need for rehabilitation
<input type="checkbox"/>	<input type="checkbox"/>	County wide trail map showing the segment proposed for rehabilitation on the funded trail
<input type="checkbox"/>	<input type="checkbox"/>	Aerial, wetland, topo, and plat maps with the trails overlaid
<input type="checkbox"/>	<input type="checkbox"/>	
	<input type="checkbox"/>	Depth and location of gravel to be used
	<input type="checkbox"/>	Identify season - Summer, Winter, Year-Round (Winter include rules)
<b>New Miles – Must complete Appendix B if development funds are requested</b>		
<input type="checkbox"/>	<input type="checkbox"/>	Current county trail map identifying all requested segments.
<input type="checkbox"/>	<input type="checkbox"/>	Aerial and topo site maps for each segment requested. Include Town-Range-Section.
<input type="checkbox"/>	<input type="checkbox"/>	
<input type="checkbox"/>	<input type="checkbox"/>	Construction plans for bridges or other structures. Include Appendix A
<input type="checkbox"/>		
	<input type="checkbox"/>	Troutes – identify gas tax or no gas tax
	<input type="checkbox"/>	Identify season - Summer, Winter, Year-Round (Winter include rules)
<b>Intensive Use Area</b>		
	<input type="checkbox"/>	County, plat, wetland, topo maps showing project boundaries, trails, and elements
	<input type="checkbox"/>	Site plans showing any existing facilities along with proposed new construction including trails, riding courses, bridges, culverts, shelters, parking lots and toilets
	<input type="checkbox"/>	Preliminary construction plans for new trails, major grading, buildings, bridges, etc.
	<input type="checkbox"/>	
<b>New Support</b>		
<input type="checkbox"/>	<input type="checkbox"/>	Campgrounds, shelter, etc. Please provide detailed information.
<input type="checkbox"/>	<input type="checkbox"/>	

**Appendix A – Required for Bridge Rehab/Replace, New, or Reroute with New Bridge**

Bridge Rehab/Replace     New Bridge     Reroute with new bridge

County Monroe	Township 16 N	Range 3	<input type="radio"/> E <input checked="" type="radio"/> W	Section 29	¼ ¼ NE	¼ SW	GPS Coordinates: Lat. 43.834929 Long. -90.761293
Water Body Name unnamed creek				Bridge Name Wells Bridge		County Inventory Number	
Funded Trail Name or Number (SNARS if applicable) 32				Has this bridge site ever received development or rehabilitation funds in the past? <input type="radio"/> Yes <input checked="" type="radio"/> No    Year: _____ \$ _____			
Bridge is located on: <input checked="" type="radio"/> Private property <input type="radio"/> Public property				Old Bridge/Culvert Size <del>12' x 27'</del> 10' x 27'			
New Bridge/Culvert Size 12' x 27'							
Landowner Where Bridge is Located James Wells				Telephone Number (608) 633-0717		Length of Trail Use Agreement (5 year minimum)	
Current maximum load    15,000    lbs.		Age of Bridge 25 years		Bridge Material steel/wood			
Proposed maximum load    25,000    lbs.							
Sponsoring Club Name Leon Valley Riders				Club Contact J. Wells		Telephone Number (608) 633-0717	
Do you have your trail bridges posted as to maximum load? <input checked="" type="radio"/> Yes <input type="radio"/> No				What is the maximum load of the other bridges on the system if groomed with this bridge? 25000			
What is the weight of your puller & drag/grading equipment? 22,000 pounds							
What other recreational trail uses are planned for this bridge? none							
If there are other Recreational uses planned, how much of the bridge cost will be paid for by non-snowmobile or non-ATV users?							

- Yes     No    Have you contacted your local DNR Water Management Specialist (WMS) regarding a permit?
- Yes     No    Is a permit needed? (Please provide any written correspondence from WMS.)
- Yes     No    Have you contacted your County Zoning Dept. regarding a floodplain determination?
- Yes     No    Will an H & H (hydrologic and hydraulic) study be required?

**Bridge Project Detailed Description**

The Wells Bridge is a "farm fabricated" bridge that crosses an unnamed creek located between Leon and Melvina. The Leon Valley Riders would like to replace the snowmobile bridge because it was not built to hold the weight of the current grooming units. The groomer operators have to drive off trail to the nearest town road to cross the river and get back on the trail.

The bridge will be replaced with one of the same width and length, however, this one will be engineered to handle a load of 25,000 pounds which will meet the needs of our current grooming units.

Appendix A (continued)

Summarize Costs in Appropriate Categories: WELLS BRIDGE

**Bridge Structure**

	Quote 1	Quote 2
	<input checked="" type="radio"/> Steel <input type="radio"/> Wooden	<input type="radio"/> Steel <input type="radio"/> Wooden
Bridge Dimensions:	<u>12x27</u>	_____
Bridge Manufacturer:	<u>ERYS PORTABLE WELDING + FABRICATION</u>	
Design Weight Load	<u>25000</u> lbs.	_____ lbs.
Cost of Structure:	1. Engineering	\$ _____
	2. Structure	\$ <u>27000.00</u>
	Subtotal	\$ <u>27000.00</u>

	Quote 1	Quote 2
	<input checked="" type="radio"/> Contractor or <input type="radio"/> Sponsor Estimate	<input type="radio"/> Contractor or <input type="radio"/> Sponsor Estimate
<b>Installation Costs:</b>		
1. Engineering	\$ <u>1000.00</u>	\$ _____
2. Site Preparation	\$ <u>2500.00</u>	\$ _____
3. Abutments	\$ _____	\$ _____
4. Pilings/Piers	\$ _____	\$ _____
5. Approaches	\$ _____	\$ _____
6. Riprap	\$ _____	\$ _____
7. Labor	\$ <u>9000.00</u>	\$ _____
8. Equipment Rental	\$ <u>500.00</u>	\$ _____
9. Culverts	\$ _____	\$ _____
10. H & H Study	\$ _____	\$ _____
11. Wetland Delineation	\$ _____	\$ _____
12. Other _____	\$ _____	\$ _____
Subtotal	\$ <u>13000.00</u>	\$ _____
Total Cost	\$ <u>40000.00</u>	\$ _____

**For the application grant, you must take the lowest of the two quotes.**

**Entire Deck and Railing Projects**       Contractor    Sponsor    Club

Bridge Dimensions: \_\_\_\_\_

Design Weight Load \_\_\_\_\_ lbs.

1. Materials      \$ \_\_\_\_\_

2. Labor          \$ \_\_\_\_\_



Total \$ \_\_\_\_\_

County has requested quotes from Custom and Northwoods with no response as of 07/25

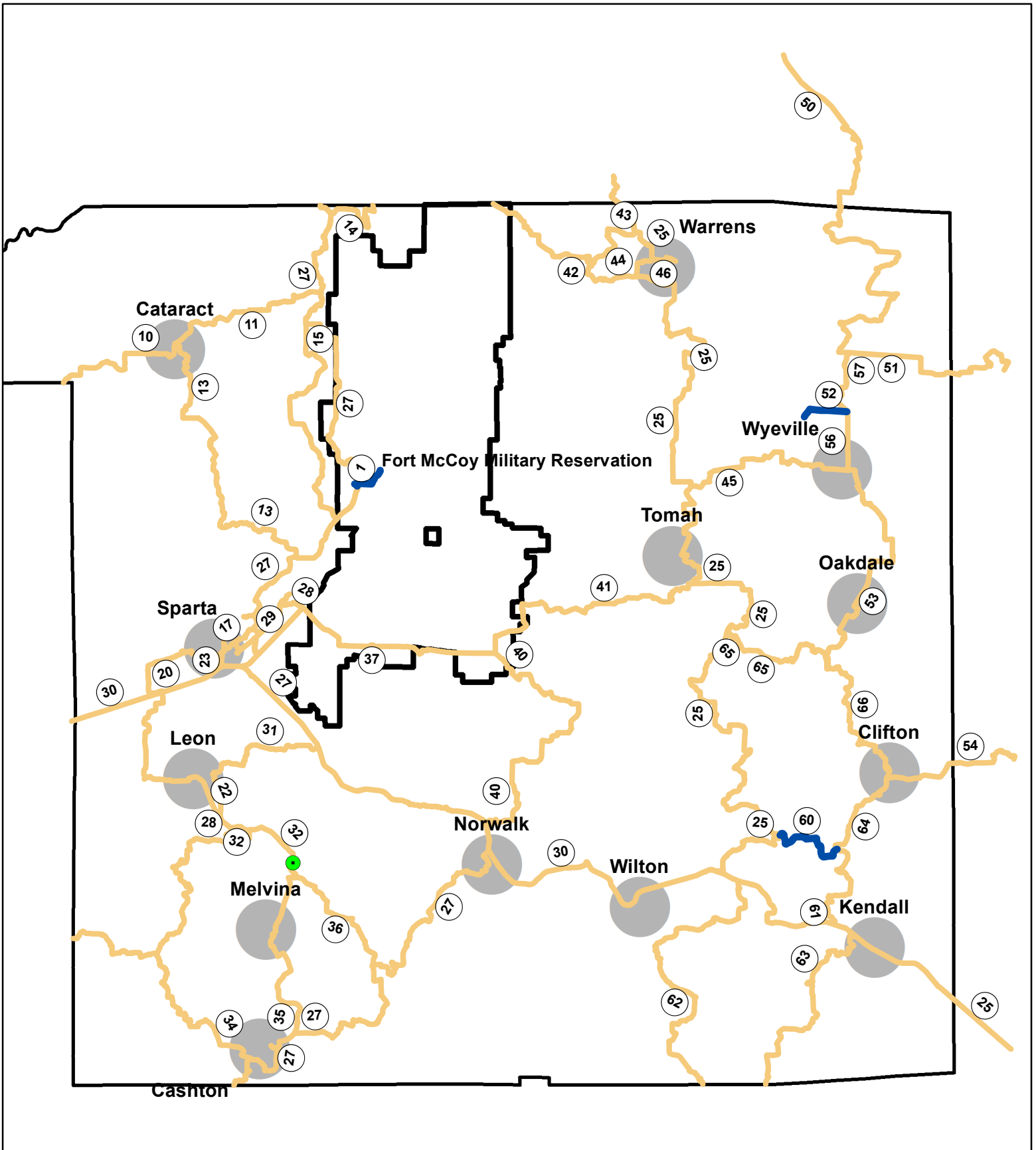
# Monroe County Snowmobile Trails



## Legend

-  Wells Bridge
-  Monroe County Snowmobile Trails
-  Non\_funded\_trails



# Monroe County Snowmobile Trails Wells Bridge



## Legend

 Wells Bridge

 Monroe County Snowmobile Trails

 Non\_funded\_trails

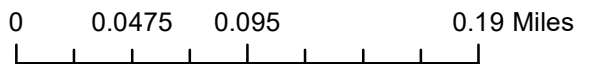

See Page 24.

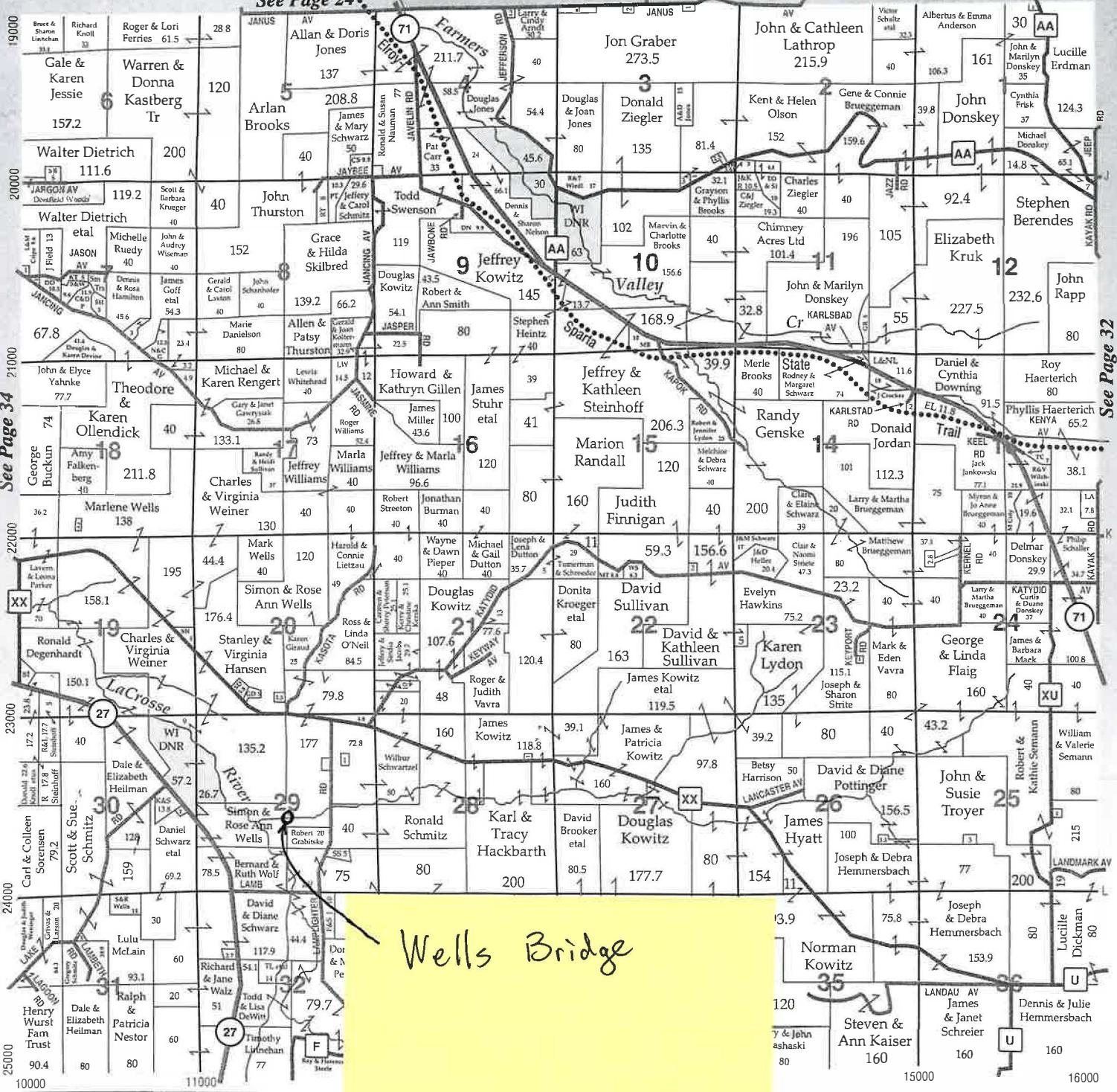

Wells Bridge

WESTFALIA

SURGE

D  
T  
H  
M  
C

**SPARTA**  
 (608) 269-3830  
 1-888-863-0227

- WATER TREATMENT EQUIPMENT
- COMPLETE SANITATION SUPPLIES

IN THE INDUSTRIAL PARK  
 1010 HOESCHLER DRIVE  
 SPARTA, WI

# Monroe County Snowmobile Trails Wells Bridge



## Legend



Wells Bridge



Monroe County Snowmobile Trails



Non\_funded\_trails

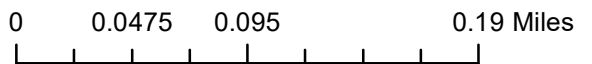



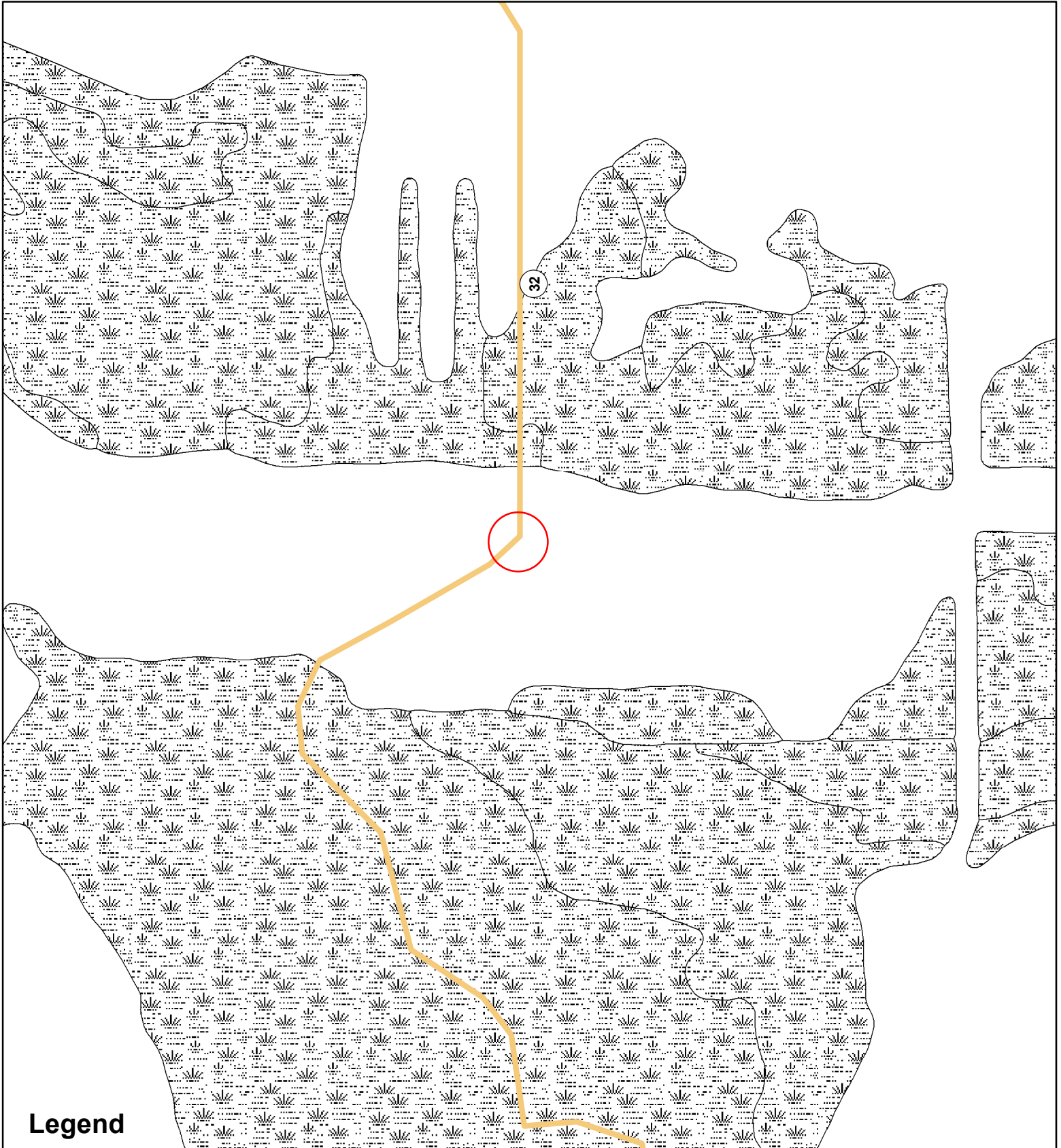

# Monroe County Snowmobile Trails Wells Bridge



## Legend

 Wells Bridge

 Monroe County Snowmobile Trails

 Non\_funded\_trails

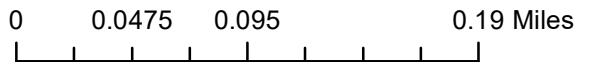





**From:** [Chad Ziegler](#)  
**To:** [Byfield, Kurt A - DNR](#)  
**Cc:** [Steffes, Jillian - DNR](#)  
**Subject:** RE: Wells Bridge Application  
**Date:** Tuesday, June 13, 2023 12:43:32 PM

---

**CAUTION: This email originated from outside the organization.  
Do not click links or open attachments unless you recognize the sender and know the content is safe.**

Kurt,

I reviewed my file on this and spoke with the club representative to gain more insight.

I noticed that I made a typo on the application, the existing bridge is 10' x 27'; the intent is to widen it out to 12'. If you look at the pictures, you'll see that the stream bank is washing out under the south end of the bridge; we would "rebuild" the abutments during the construction project to make the bridge safer for snowmobilers and the groomer operators.

The trail has a corner at the bridge; the club representative mentioned that he usually sees evidence of snowmobile tracks off the trail on the bridge approach; so widening the bridge, adding railings, etc. would make the bridge a safer crossing for the snowmobilers and groomer operators.

The weight load for the bridge wouldn't be over the 25K pounds.

If you have any questions, let me know.

*Chad Ziegler*

Monroe County  
Forest & Parks Administrator  
14345 County Hwy B, Suite 5  
Sparta, WI 54656  
608-269-8635  
Fax: 608-366-1809

<http://www.co.monroe.wi.us/departments/parks-forestry/>

---

**From:** Byfield, Kurt A - DNR <Kurt.Byfield@wisconsin.gov>  
**Sent:** Thursday, June 8, 2023 1:27 PM  
**To:** Chad Ziegler <Chad.Ziegler@co.monroe.wi.us>  
**Subject:** RE: Wells Bridge Application

**CAUTION: This email originated from outside of the Monroe County. Do not click links or open**

**attachments unless you recognize the sender and know the content is safe.**

Hi

Is there anything wrong with the Wells bridge other than the need to increase it's weight bearing capacity? Unless they can document some structural problem to this bridge that affects it's safety/use by snowmobiles, we're going to have to reject this application. . We have a long standing policy of not paying to replace bridges just for the sake of accommodating larger groomers. This is documented in the Snowmobile Program Guidance document on page 5.

“Costs that are not eligible include: replacement of bridge railings only, patching of decking, grading or minor repair of approaches, bridge repairs necessary to bring the bridge structure within existing codes, reinforcement of bridge structures to accommodate weights in excess of 25,000 pounds and deck replacement for the sole purpose of accommodating larger grooming equipment”

And in NR 50.09 (5) ALLOWABLE COSTS, BILLING AND AUDITS. (bn)

2. Costs which are not eligible for development and rehabilitation cost sharing are: construction and replacement of bridge railings only, and patching of decking, grading or minor repair to approaches, construction and bridge repairs to bring bridge structure within any existing codes, construction and reinforcement of bridge structures to accommodate weights in excess of ~~14,000~~ 25,000 pounds and deck construction and replacement for the primary purpose of accommodating larger grooming equipment.

Kurt

**We are committed to service excellence.**

Visit our survey at <http://dnr.wi.gov/customersurvey> to evaluate how I did.

Kurt Byfield

Cell: (608) 501-4274 – **NEW CELL NUMBER**

[Kurt.Byfield@Wisconsin.Gov](mailto:Kurt.Byfield@Wisconsin.Gov)

---

**From:** Chad Ziegler <[Chad.Ziegler@co.monroe.wi.us](mailto:Chad.Ziegler@co.monroe.wi.us)>

**Sent:** Wednesday, April 12, 2023 2:06 PM

**To:** Byfield, Kurt A - DNR <[Kurt.Byfield@wisconsin.gov](mailto:Kurt.Byfield@wisconsin.gov)>

**Subject:** Wells Bridge Application

**CAUTION: This email originated from outside the organization.**

**Do not click links or open attachments unless you recognize the sender and know the content is safe.**

Kurt,

Attached is our Wells Bridge application. I need to take a few updated pictures, get quotes for this bridge and have a discussion with the water management specialist. I'll fill in the blanks as I receive the information.

If you have any questions, let me know.

*Chad Ziegler*

Monroe County

Forest & Parks Administrator

14345 County Hwy B, Suite 5

Sparta, WI 54656

608-269-8635

Fax: 608-366-1809

<http://www.co.monroe.wi.us/departments/parks-forestry/>