

#50 Vilas West Plum Creek Trail Rehab

State of Wisconsin
 Department of Natural Resources
dnr.wi.gov

Motorized Recreation Grant Application

For: (choose all that apply)

Form 8700-159 (R 12/18)

Page 1 of 5

Due Date: April 15

- ATV/UTV Trail Aid
- Snowmobile Trail Aid
- Motorized Stewardship - 20% County match required

Notice: Completion of this form is required under Wisconsin Statutes 23.09(26) and 23.33. Failure to complete this form will result in denial of financial assistance. Personally identifiable information found on this form is not intended to be used for any other purpose. The Department of Natural Resources (DNR) may provide this information to requesters as required by Wisconsin's Open Records law {ss. 19.31 – 19.39, Wis. Stats.}.

Instructions: Applications may combine more than one source of funds. They may be submitted for consideration of traditional ATV, UTV, Snowmobile and Motorized Stewardship funding. Submit one copy of all forms and attachments. See Page 2 for necessary attachments. Send applications to your [Community Services Specialist](#).

DNR Use Only	
Category	Number

Section 1: Applicant Information					
Applicant / Organization Name			Check Recipient: Individual other than authorized individual to act on behalf of the applicant. <input checked="" type="checkbox"/> Select if the same as applicant.		
Vilas County Parks and Recreation					
Individual Authorized to Act on Behalf of Applicant per Resolution			Check Recipient Name (Name to Appear on Check)		
Todd Bierman					
Title			Title		
Park and Recreation Supervisor					
Address			Address		
330 Court Street					
City	State	ZIP Code	City	State	ZIP Code
Eagle River	WI	54521			
Telephone Number		Email Address			
(715) 479-5160		tobier@vilascountywi.gov			

Section 2: Project Information Required for all Projects								
Project Title					Current Funded Miles	New Miles (if applicable)		
Sayner West Plum Trail Rehab					501			
County	Township	Range	Section	¼ ¼	¼	GPS Coordinates:		
Vilas	41 N	7	36			Lat.		
						Long.		

Project Description Summary

Vilas County is proposing to rehab approximately 1.2 miles of Corridor Trail 10 From TIN # 204 to TIN # 205. This trail has been used as a snowmobile trail for 30+ years. The project will consist of improving tight corners with limited sight distances and improve slopes on the hills. There is a developmental cost and there are no bridges on this trail section. Maintenance of this trail has been and will be done by the Sayner Barnstormers snowmobile club. This trail will be groomed with AAA-2 grooming equipment.

I certify that all maintenance land use agreements are on file.

Estimated Cost						
Maintenance	Acquisition	Insurance	Development	Bridge Rehab.	Trail Rehab.	Total Estimated Cost
					\$33,608.57	\$33,608.57

Leave Blank – DNR Use Only						

Applicant Certification	
Printed Name of Authorized Official	Official's Title
Todd Bierman	Vilas County Parks and Recreation Supervisor

As the applicant's authorized official, I certify that, to the best of my knowledge, the information in this application is true and correct.

 Signature of Authorized Official

 Date Prepared

Appendix B – Required for Trail/Qualified Trout Rehab, Reroute, or Development

Trail Rehab Qualified Trout New Trail Trail Reroute (Mandatory or Discretionary)

County	Township	Range	Section	¼ ¼	¼	GPS Coordinates: Lat. Long.
Vilas	42 N	7	36			

Funded Trail Name or Number (SNARS if applicable)	Has this trail ever received development or rehabilitation funds in the past?
Corridor Trail 10	<input type="radio"/> Yes <input checked="" type="radio"/> No Year: _____ \$ _____

Trail is located on: <input type="radio"/> Private property <input checked="" type="radio"/> Public property	Length of Easement or Landowner Use Agreement 5 years	Expiration Date 11/30/2024
---	--	-------------------------------

Landowner Where Trail is Located State of Wisconsin	Telephone Number
--	------------------

What other recreational trail uses are planned for this trail?

None at This Time

If there are other Recreational uses planned, how much of the trail development/rehab. cost will be paid for by other users?

How many miles would be affected if this project is not funded? 0	Will this result in closure of a trail? <input type="radio"/> Yes <input checked="" type="radio"/> No
--	--

Is this a critical section to the overall trail system? <input checked="" type="radio"/> Yes <input type="radio"/> No	Is there a reasonable alternative? No
--	--

Does any section of this trail contain a bridge? <input type="radio"/> Yes <input checked="" type="radio"/> No	Will this bridge require rehabilitation now or in the next few years? <input type="radio"/> Yes <input type="radio"/> No	What is the weight of your puller & drag/grading equipment? lbs.
---	---	---

- Yes No Have you contacted your local [DNR Water Management Specialist \(WMS\)](#) regarding a permit?
- Yes No Is a permit needed? (Please provide any written correspondence from WMS.)
- Yes No Will this project be located near or cross any intermittent or perennial waterway? [Surface Water Data Viewer](#)
- Yes No Will this project be located near or cross any wetland?
- Yes No Will this project involve land disturbance – including clearing and grubbing – of 1 acre or more of land? (Less than 4/10th mile for a typical trail) [DNR Storm Water Contact List](#)

Trail Project Detailed Description

Vilas County is proposing to rehab approximately 1.2 miles of Corridor Trail 10 From TIN # 204 to TIN # 205. This trail has been used as a snowmobile trail for 30+ years. The project will consist of improving tight corners with limited sight distances and improve slopes on the hills. There is a developmental cost and there are no bridges on this trail section. Maintenance of this trail has been and will be done by the Sayner Barnstormers snowmobile club. This trail will be groomed with AAA-2 grooming equipment.

For use with Recreation Grant Application Forms

Project Name: Sayner West Plum Trail Rehab		Prepared By: Todd Bierman	Date 03/31/2023
County Vilas	Project Applicant: Vilas County Parks and Recreation	Landowner Name State of Wisconsin	<input checked="" type="radio"/> Public <input type="radio"/> Private

Indicate - (C) Contract , (F) Force Acct., (D) Donated

DEVELOPMENT PROJECT ITEMS <i>List by individual item or break down by Use Areas (See Item List On Back Of This Form)</i>		Quantity	Unit of Measure	Component Costs	Estimated Total Item Cost
(C)	Wetland Delineation	1	each	\$6,000.00	\$6,000.00
(C)	Storm Water Plan and Permit	1	each	\$10,000.00	\$10,000.00
(C)	Pit Run	70	cuyd	\$28.65	\$2,005.50
(C)	Breaker Run	25	cuyd	\$55.45	\$1,386.25
(C)	Dump truck	11	hrs	\$85.16	\$936.76
(C)	Dozer	24	hrs	\$123.35	\$2,960.40
(C)	Excavator	11	hrs	\$155.00	\$1,705.00
(C)	Skid Steer	10	hrs	\$45.85	\$458.50
(C)	Tractor W/Boom Brush Mower	8	hrs	\$94.52	\$756.16
(C)	Grass Seed	40	lbs	\$35.00	\$1,400.00
(C)	Engineering	1	each	\$6,000.00	\$6,000.00
TOTALS					\$33,608.57

NOTE: For acquisition projects, complete the Acquisition Project Cost Estimate Section



Vilas County Forestry, Recreation & Land

Todd Bierman, Parks & Recreation Supervisor

330 Court Street • 2112 N. Railroad St. (physical address) • Eagle River, WI 54521

715-479-5160

tobier@vilascountywi.gov • www.co.vilas.wi.us/forestry.html

February 28, 2024

Jeff Pennucci
DNR Northern Region
107 Sutliff Avenue
Rhineland, WI 54501

Subject: Variance from non-statutory requirement

Dear Jeff,

The Wisconsin Administrative Code NR 50.09(4)(g) 1 states: Snowmobile trail segments eligible for rehabilitation assistance shall be a minimum of 3 miles in length and shall be a part of the funded trail system of the county for a minimum of 10 years from the date of application for trail rehabilitation except where a natural event or other circumstances beyond the control of the county adversely affected trail safety prior to this 10-year period.

Based on this requirement, Vilas County is requesting a variance to allow rehabilitation of 1.2 miles of snowmobile trail which needs to have some of the curve's widen and hills cut to improve visibility and safety for the trail users. The variance and possible funding will allow for safer and improved maintenance and improved visibility on this section of trail.

If you have any questions or concerns, please contact me at your convenience.

Thank you,
Todd Bierman
Park and Recreation Supervisor

Vilas County Snowmobile Trails/Sayner West Plum Trail

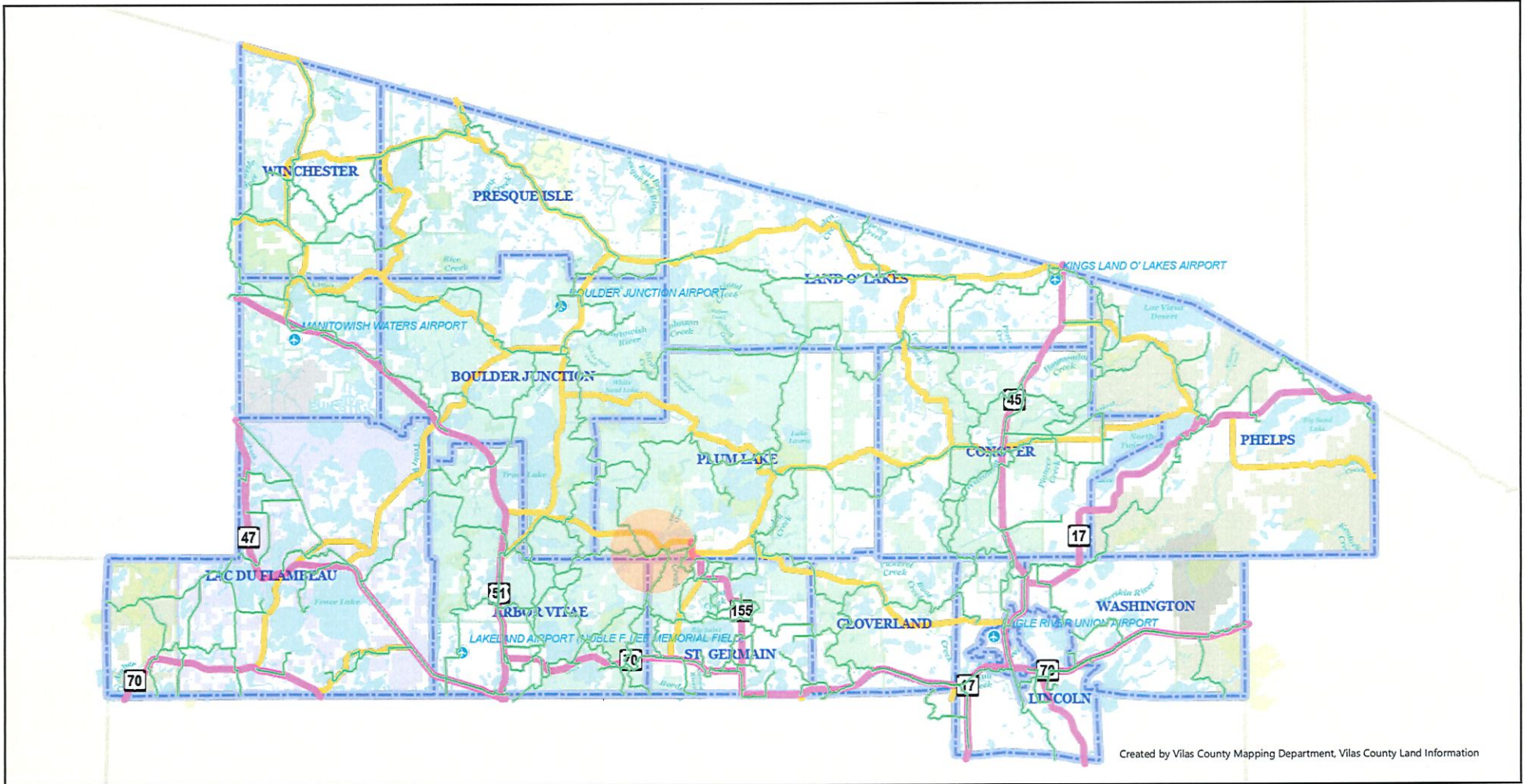

Created by Vilas County Mapping Department, Vilas County Land Information

Scale: 1:253,440

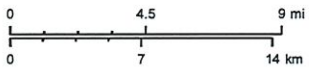

Vilas County Online Mapping

Created 3/21/2023 11:45 AM
 This map is provided courtesy of Vilas County and is to be used for reference purposes only. Vilas County makes every effort to produce and publish the most accurate and current information possible. No warranties, expressed or implied, are provided for the data provided, its use, or its interpretation. Vilas County does not guarantee the accuracy of the material contained herein and is not responsible for any misuse or misrepresentation of this information or its derivatives.
 This map does not represent a survey.

- | | | | |
|--------------------------------|-------------------------|------------------|----------------|
| Snowmobile Trails (Level 8-10) | Funded Snowmobile Trail | Highways | County Highway |
| Primary Type | Club Snowmobile Trail | Type | Airport |
| Corridor Snowmobile Trail | Town/City Boundary | US/State Highway | |

Sayner West Plum Trail Aerial



Scale: 1:4,800
 0 0.08 0.16 mi
 0 0.1 0.2 km
 Vilas County Online Mapping

Created 3/31/2023 11:41 AM
 This map is provided courtesy of Vilas County and is to be used for reference purposes only. Vilas County makes every effort to produce and publish the most accurate and current information possible. No warranties, expressed or implied, are provided for the data provided, its use, or its interpretation. Vilas County does not guarantee the accuracy of the material contained herein and is not responsible for any misuse or misrepresentation of this information or its derivatives.
 This map does not represent a survey.

- | | | | | | | |
|---|---|---|---|---|---|--|
| <p>Snowmobile Trails (Level 4-5)</p> <p>Primary Type</p> <ul style="list-style-type: none"> — Corridor Snowmobile Trail - - - Funded Snowmobile Trail - - - Club Snowmobile Trail | <ul style="list-style-type: none"> • TINS Parcel Boundary Tax Parcel Sub Lines Boundary Line | <ul style="list-style-type: none"> Right of Way Line Source or Lot Line — Meander Line — Natural Feature Owner Last Name Only | <p> Town/City Boundary</p> <p>Minor Roads</p> <p>Type</p> <ul style="list-style-type: none"> Service Road 4WD Road | <p> Runway</p> <p>Major Roads</p> <p>Type</p> <ul style="list-style-type: none"> Collector Road Local Road | <p> Resource Road</p> <p>Highways</p> <p>Type</p> <ul style="list-style-type: none"> US/State Highway County Highway | <p>Water Access</p> <p>Feature Code</p> <ul style="list-style-type: none"> ⊕ Boat Ramp ⊕ Carry-In Lake Access |
|---|---|---|---|---|---|--|

Sayner West Plum Trail Topo

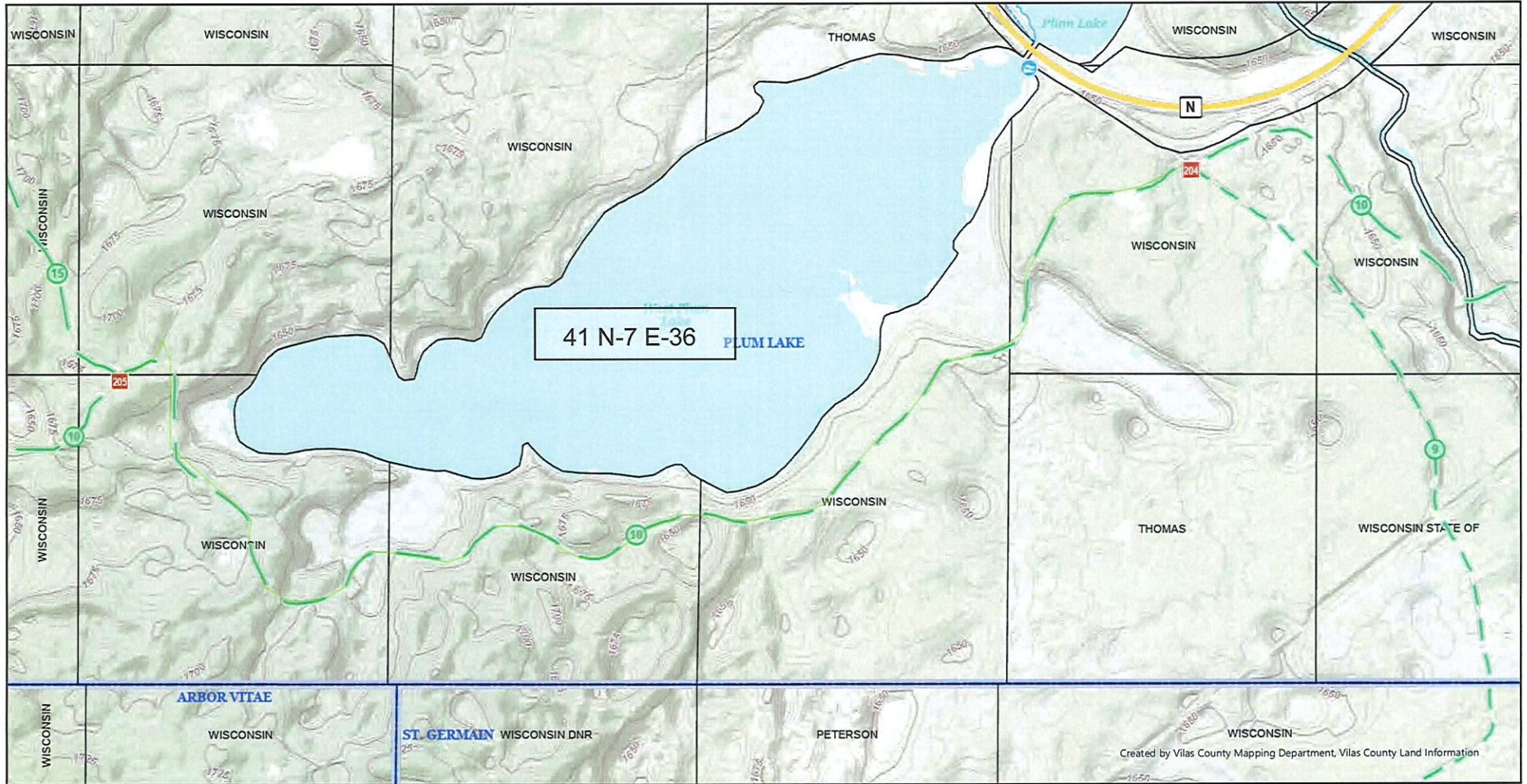

Created by Vilas County Mapping Department, Vilas County Land Information

Scale: 1:4,800

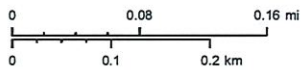

Vilas County Online Mapping

Created 3/31/2023 11:44 AM
 This map is provided courtesy of Vilas County and is to be used for reference purposes only. Vilas County makes every effort to produce and publish the most accurate and current information possible. No warranties, expressed or implied, are provided for the data provided, its use, or its interpretation. Vilas County does not guarantee the accuracy of the material contained herein and is not responsible for any misuse or misrepresentation of this information or its derivatives.
 This map does not represent a survey.

Snowmobile Trails (Level 4-5)

Primary Type

- Corridor Snowmobile Trail
- - - Funded Snowmobile Trail
- - - - - Club Snowmobile Trail

TINS

- Parcel Boundary
- Tax Parcel Sub Lines
- Type
- Boundary Line

- Right of Way Line
- Source or Lot Line
- Meander Line
- Natural Feature
- Owner Last Name Only

- Town/City Boundary
- Minor Roads
- Type
- Service Road
- 4WD Road

- Runway
- Major Roads
- Type
- Collector Road
- Local Road

- Resource Road
- Highways
- Type
- US/State Highway
- County Highway

- Water Access Feature Code
- Boat Ramp
- Carry-In Lake Access



Sayner West Plum Trail Rehab Wetland Map



Legend

- Wetland Class Areas
- Wetland Class Points
- Dammed pond
- Excavated pond
- Filled/draind wetland
- Wetland too small to delineate
- Filled excavated pond
- Filled Points
- Wetland Class Areas
- Filled Areas
- Wetland Class Areas
- Wetland Class Points
- Dammed pond
- Excavated pond
- Filled/draind wetland
- Wetland too small to delineate
- Filled excavated pond
- Filled Points
- Wetland Class Areas
- Filled Areas
- Wetland Identifications and Confirmations
- Municipality
- State Boundaries
- County Boundaries
- Major Roads**
 - Interstate Highway
 - State Highway
 - US Highway
- County and Local Roads**
 - County HWY
 - Local Road
- Railroads
- Tribal Lands
- Rivers and Streams

0.3 0 0.13 0.3 Miles

NAD_1983_HARN_Wisconsin_TM

1: 7,920

DISCLAIMER: The information shown on these maps has been obtained from various sources, and are of varying age, reliability and resolution. These maps are not intended to be used for navigation, nor are these maps an authoritative source of information about legal land ownership or public access. No warranty, expressed or implied, is made regarding accuracy, applicability for a particular use, completeness, or legality of the information depicted on this map. For more information, see the DNR Legal Notices web page: <http://dnr.wi.gov/legal/>

Notes





