

## S-21 Ashland Bridge 4

State of Wisconsin  
Department of Natural Resources  
[dnr.wi.gov](http://dnr.wi.gov)

## Motorized Recreation Grant Application

For: (choose all that apply)

Form 8700-159 (R 02/2024)

Page 1 of 5

Due Date: April 15

☐ ATV/UTV Trail Aid☒ Snowmobile Trail Aid

**Notice:** Completion of this form is required under Wisconsin Statutes 23.09(26) and 23.33. Failure to complete this form will result in denial of financial assistance. Personally identifiable information found on this form is not intended to be used for any other purpose. The Department of Natural Resources (DNR) may provide this information to requesters as required by Wisconsin's Public Records law {ss. 19.31 – 19.39, Wis. Stats.}.

**Instructions:** Applications may combine more than one source of funds. They may be submitted for consideration of traditional ATV, UTV, Snowmobile and Motorized Stewardship funding. Submit one copy of all forms and attachments. See Page 2 for necessary attachments. Send applications to your [Community Services Specialist](#).

## DNR Use Only

Category

Number

## Section 1: Applicant Information

Applicant / Organization Name

Ashland County

Check Recipient: Individual other than authorized individual to act on behalf of the applicant. ☐ Select if the same as applicant.Individual Authorized to Act on Behalf of Applicant per Resolution  
Chris HoffmanCheck Recipient Name (Name to Appear on Check)  
Ashland County Treasurer, Tracy Hoglund

Title

Forest Administrator

Title

County Treasurer

Address

304 W. Michigan St, PO Box 155

Address

PO Box 155

City

Butternut

State

WI

ZIP Code

54514

City

Butternut

State

WI

ZIP Code

54514

Telephone Number

715-769-3777

Email Address

chris.hoffman@ashlandcountyiwi.gov

## Section 2: Project Information Required for all Projects

Project Title

Bridge #4, Deck Replacement

Current Funded Miles

New Miles (if applicable)

County

Ashland

Township

42 N

Range

2 ☐ E  
☒ W

Section

11

1/4 1/4

UN

1/4

UN

GPS Coordinates:

Lat. 46.137

Long. -90.577

## Project Description Summary

Replace bridge decking per inspection report.

☒ I certify that all maintenance land use agreements are on file.

## Estimated Cost

Maintenance	Acquisition	Insurance	Development	Bridge Rehab.	Trail Rehab.	Total Estimated Cost

## Leave Blank – DNR Use Only

				\$63,100		\$63,100
--	--	--	--	----------	--	----------

## Applicant Certification

Printed Name of Authorized Official

CHRIS HOFFMAN

Official's Title

FOREST ADMINISTRATOR

As the applicant's authorized official, I certify that, to the best of my knowledge, the information in this application is true and correct.

Signature of Authorized Official

Date Prepared

4.7.2025

# Motorized Recreation Grant Application

Form 8700-159 (R 02/2024)

Page 3 of 5

## Appendix A – Required for Bridge Rehab/Replace, New, or Reroute with New Bridge

☒ Bridge Rehab/Replace    ☐ New Bridge    ☐ Reroute with new bridge

County Ashland	Township 42 N	Range 2	<input type="radio"/> E <input checked="" type="radio"/> W	Section 11	1/4 1/4 UN	1/4 UN	GPS Coordinates: Lat. 46.137 Long. -90.577
Water Body Name East Fork Chippewa River				Bridge Name		County Inventory Number	
Funded Trail Name or Number (SNARS if applicable) Trail 13				Has this bridge site ever received development or rehabilitation funds in the past? <input checked="" type="radio"/> Yes <input type="radio"/> No Year: _____ \$ _____			
Bridge is located on: <input type="radio"/> Private property <input checked="" type="radio"/> Public property				Old Bridge/Culvert Size 95'x12' New Bridge/Culvert Size _____			
Landowner Where Bridge is Located Town of Jacobs				Telephone Number		Length of Trail Use Agreement (5 year minimum)	
Current maximum load Unknown lbs.		Age of Bridge 23		Bridge Material			
Proposed maximum load _____ lbs.							
Sponsoring Club Name Ashland County Snowmobile Alliance				Club Contact John Westphal		Telephone Number 920-740-5020	
Do you have your trail bridges posted as to maximum load? <input type="radio"/> Yes <input checked="" type="radio"/> No				What is the maximum load of the other bridges on the system if groomed with this bridge?			
What is the weight of your puller & drag/grading equipment? 17000 lbs							
What other recreational trail uses are planned for this bridge? None							
If there are other Recreational uses planned, how much of the bridge cost will be paid for by non-snowmobile or non-ATV users?							
<input type="radio"/> Yes <input checked="" type="radio"/> No Have you contacted your local <a href="#">DNR Water Management Specialist (WMS)</a> regarding a permit? <input type="radio"/> Yes <input checked="" type="radio"/> No Is a permit needed? (Please provide any written correspondence from WMS.) <input type="radio"/> Yes <input checked="" type="radio"/> No Have you contacted your County Zoning Dept. regarding a floodplain determination? <input type="radio"/> Yes <input checked="" type="radio"/> No Will an H & H (hydrologic and hydraulic) study be required?							

### Bridge Project Detailed Description

Existing bridge deck will be removed and will be replaced with new wood timbers. Recommendation to remove from bridge inspection report.

Appendix A (continued)

Summarize Costs in Appropriate Categories:

Bridge Structure

Quote 1

☐ Steel ☐ Wooden

Quote 2

☐ Steel ☐ Wooden

Bridge Dimensions: \_\_\_\_\_

Bridge Manufacturer: \_\_\_\_\_

Design Weight Load \_\_\_\_\_ lbs.

Cost of Structure: 1. Engineering \$ \_\_\_\_\_

2. Structure \$ \_\_\_\_\_

Subtotal \$ \_\_\_\_\_

\$ \_\_\_\_\_

\$ \_\_\_\_\_

\$ \_\_\_\_\_

Quote 1

☐ Contractor or ☐ Sponsor  
Estimate

Quote 2

☐ Contractor or ☐ Sponsor  
Estimate

Installation Costs:

1. Engineering \$ \_\_\_\_\_

2. Site Preparation \$ \_\_\_\_\_

3. Abutments \$ \_\_\_\_\_

4. Pilings/Piers \$ \_\_\_\_\_

5. Approaches \$ \_\_\_\_\_

6. Riprap \$ \_\_\_\_\_

7. Labor \$ \_\_\_\_\_

8. Equipment Rental \$ \_\_\_\_\_

9. Culverts \$ \_\_\_\_\_

10. H & H Study \$ \_\_\_\_\_

11. Wetland Delineation \$ \_\_\_\_\_

12. Other \_\_\_\_\_ \$ \_\_\_\_\_

Subtotal \$ \_\_\_\_\_

Total Cost \$ \_\_\_\_\_

\$ \_\_\_\_\_

\$ \_\_\_\_\_

\$ \_\_\_\_\_

\$ \_\_\_\_\_

\$ \_\_\_\_\_

\$ \_\_\_\_\_

\$ \_\_\_\_\_

\$ \_\_\_\_\_

\$ \_\_\_\_\_

\$ \_\_\_\_\_

\$ \_\_\_\_\_

\$ \_\_\_\_\_

\$ \_\_\_\_\_

\$ \_\_\_\_\_

\$ \_\_\_\_\_

For the application grant, you must take the lowest of the two quotes.

Entire Deck and Railing Projects

☐ Contractor ☐ Sponsor ☐ Club

Bridge Dimensions: 95'x12'

Design Weight Load Unknown lbs.

1. Materials \$ 39600

2. Labor \$ 23500

Total \$ 63100



**Custom Manufacturing, Inc.**

606 Delco Drive, P.O. Box 279

Clinton, WI 53525

608-676-2282 Fax: 608-676-2283

tina@custommfginc.com

# Quotation

  
6667

Please Indicate The Above Number When Ordering

To: Ashland County Snowmobile Alliance  
P.O. Box 345  
Mellen, WI 53546

Date: March 26, 2025	Salesperson: Tina Forrest
Inquiry Date:	Inquiry Number

Estimated Ship Date 8 – 12 weeks	Shipped VIA Best Way	F.O.B Clinton, WI	Terms Net 30
	<b>Description</b>	<b>Price</b>	<b>Total</b>
	2025 GRANT APPLICATION ESTIMATE Bridge #4		
1	95' Bridge x 12' Wide - Redeck with 3 x 12 – 12' And Shipping Charges	\$ 39,600.00	
	Installation – Redecking - Equipment Removal & Disposal of Existing Bridge Decking	23,500.00	
	Total		\$ 63,100.00
	The above prices do not include sales tax or any necessary permits.		

We are pleased to submit the above quotation for your consideration. Should you place an order, be assured it will receive our prompt attention. This quotation is valid for 30 days. Thereafter it is subject to change without notice.

BY: Tina Forrest ACCEPTED: \_\_\_\_\_ DATE: \_\_\_\_\_



Guidelines for Applicant

Complete this form for each bridge structure you are submitting a grant application for. Provide any additional documents not requested on application checklist to substantiate your points, including actual deeded easements.

Category		Possible Points	Actual Points
1	<b>Condition of the Structure</b> (max of 10 points)		
	Has a certified bridge inspection report that supports the project & demonstrates need (see example, must provide copy of report by August 1 for 2024 only)	10	10
2	<b>Permits</b> (maximum points 4)		
	Consultation with DNR Water Mgmt Specialist has occurred & permit is likely, if needed	1	
	Permit in hand / Bridge already permitted	3	
3	<b>Funding</b> (maximum points 2) Are other funds already committed?		
	50% or greater from other funding source(s)?	2	
	11% - 49% from other funding source(s)?	1	
4	<b>Length of Written Easements or Land Use Agreement</b> (max points 5)(ch. 23.09(26)(am)1 WI Stats)		
	On public land (County, State, Federal)	5	
	10 or more year <b>deeded easement</b> on private land or other public land, for <u>all portions of that trail to the nearest road</u> on each side of the bridge	5	
	3-9 year <b>deeded easement</b> on private land or other public land, for <u>all portions of that trail to the nearest road</u> on each side of the bridge	4	
	10 or more year <b>deeded easement</b> on private land or other public land, for <u>just the bridge site</u>	3	
	3-9 <b>deeded easement</b> on private land or other public land, for <u>just the bridge site</u>	2	
	10 or more year land use agreement (LUA, not deeded) on private land or other public land	1	1
	3-9 year land use agreement (LUA, not deeded) on private land or other public land	0	
5	<b>Miles Impacted</b> – How many miles will need to rerouted if the structure is not replaced? Measured from nearest intersection on both sides of the bridge. (max 4 points)		
	Less than 20 miles	1	1
	20 miles or more	3	
	No other snowmobile trails connect. Explain:	4	
	<b>DEDUCTIONS</b>		
6	<b>County Active Project Deduction</b> (maximum deduction 1 point) A snowmobile active project is one that has exceeded it's initial grant period.		
	Two or more active projects - deduct 1 point	-1	
<b>GRAND TOTAL</b>			<b>12</b>

Comments/Notes:

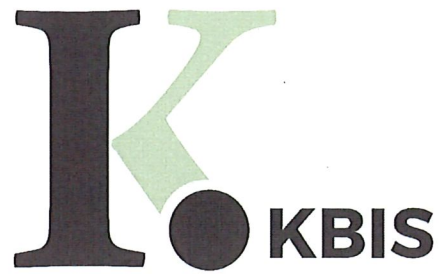

# Trail Bridge Inspection

## Ashland County

Bridge Name

Ashland 4

Inspected By:

Patrick Hampston, P.E.  
William S. Knaack Jr, P.E.

02/23/2024

Prepared By

KBIS, LLC





W7218 Hickory Lane  
Phillips, WI 54555  
wm.kbis@gmail.com  
715.820.0095

## Bridge Inspection Report

---

### General Information

The structure in this report was inspected by certified Wisconsin Department of Transportation Bridge Inspectors. Both Inspectors are Bridge Inspection Team Leaders and NSTM certified inspectors.

The bridge was inspected with trail use in mind, using normal vehicle bridge standards to determine the condition of the structure.

All recommendations made in the report are also considering the use of the trail. Trail bridges in general should have a load rating considering all the possible uses of the structure. Even though the bridges may be just for snowmobiles, several types of vehicles may use the structure. A load rating is provided in conjunction with this report.

### Location information/General Description:

Located just East of the STH 13 bridge, middle of Glidden.

### Bridge Condition

Condition State (CS) 1-Good, CS2-Fair, CS3-Poor, CS4-Critical

Then entire area around the bridge is well maintained, all bridges should look like this one.

Both abutments looks good condition.

Truss is self-weathering steel, in good condition, the rust is still tight.

The deck boards have widespread major rot in top layer.

Minor erosion NE and SE corner.

No Bridge ahead signs. Object markers are fair as they are faded.

Approaches-8 inch low South end, and 4 inch low on North end.

Length 94.1 ft, Width 12.1, 12.8 ft, and 10 plus feet clearance on stream.





W7218 Hickory Lane  
Phillips, WI 54555  
wm.kbis@gmail.com  
715.820.0095

## Bridge Inspection Report

### Report Summary

**NBI Ratings: 9-7 Good, 6-5 Fair, 4-3 Poor, 2-1 Critical, 0-Closed**

Deck	# 5
Superstructure	# 7
Substructure	# 7
Channel	# 6

Overall Condition Fair

### **Recommendations/Maintenance Items:**

Recommend doing a load rating as long span, and good to have posted to protect the structure and the public.  
Fill in the approaches.

Clean all the bearing areas.

Replace the top layer of deck boards, when the top layer is off, inspect the bottom layer for rot. Consider replacing both layers of decking with 3 inch thick boards treated with copper naphthanate.

Add bridge ahead signs, and replace all the object markers.

Signed By:

Digitally signed by William  
S. Knaack Jr., P.E.

Date: 2024.03.04 09:42:16  
-06'00'

William S. Knaack Jr., P.E.

## Bridge Inspection Report

### Photo Observations



Looking North



## Bridge Inspection Report

### Photo Observations



Deck Rot, measurable section loss.



## Bridge Inspection Report

### Photo Observations



Looking West

## Bridge Inspection Report

### Photo Observations



Looking South.



## Bridge Inspection Report

### Photo Observations



Deck Rot



## Bridge Inspection Report

### Photo Observations



Looking South

## Bridge Inspection Report

### Photo Observations



Looking East



## Bridge Inspection Report

### Photo Observations



South Abutment



## Bridge Inspection Report

### Photo Observations

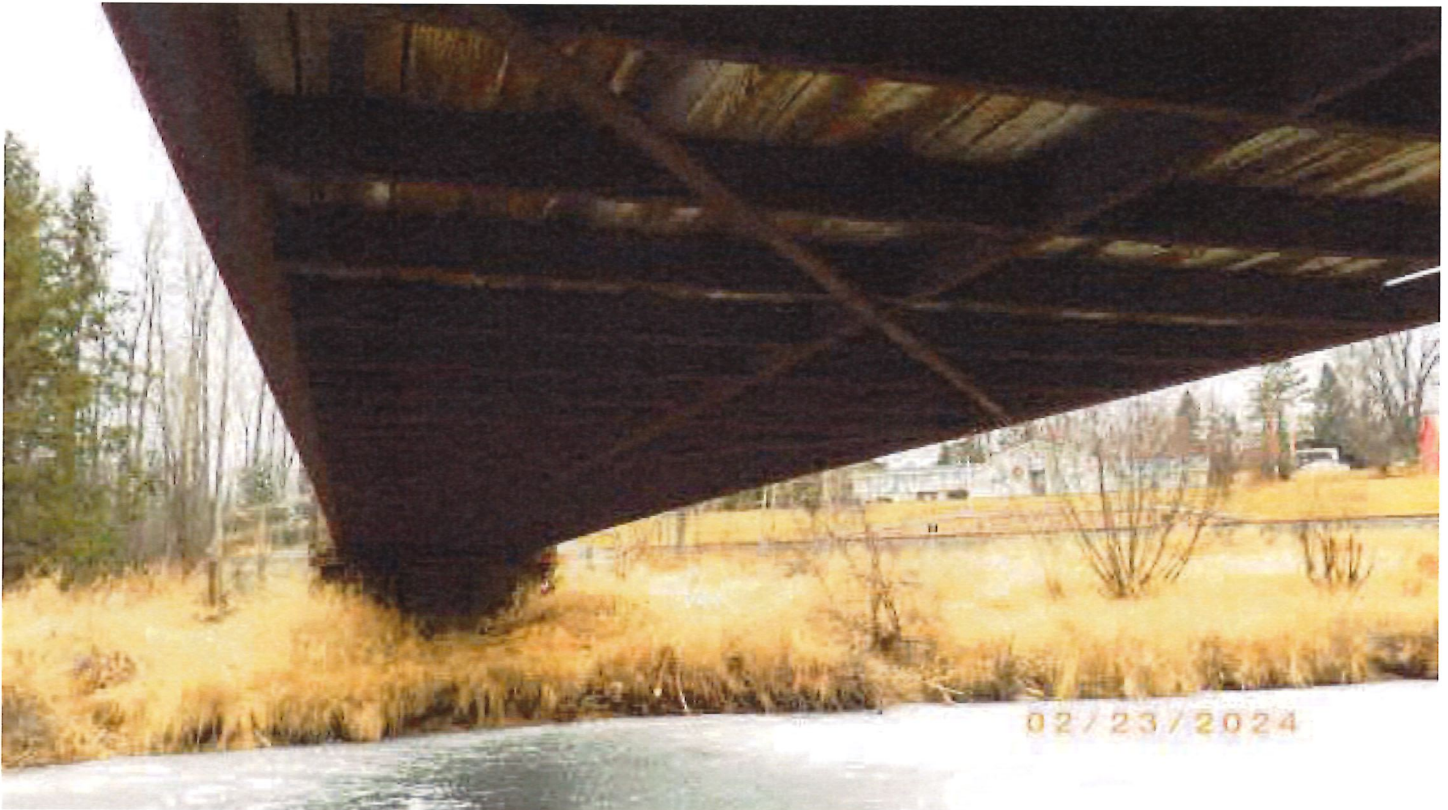

Bottom of deck, typical, looking West.





# Surface Water Data Viewer Map



## Legend

- Lake Class Areas
- Riverine/ditch Class Areas
- Wetland Class Areas
- Wetland Class Points
  - Dammed pond
  - Excavated pond
  - Filled/draind wetland
  - Wetland too small to delineate
  - Filled excavated pond
- Filled Points
- Wetland Class Areas
- Filled Areas
- Wetland Identifications and Confirmations
- Township
- Section
- Quarter-Quarter
- County Boundary
- Cities, Towns & Villages
  - City
  - Village
  - Civil Town
- Railroads

## Notes

Bridge #3 and #4

0.1 0 0.03 0.1 Miles

NAD\_1983\_HARN\_Wisconsin\_TM

1: 1,980

DISCLAIMER: The information shown on these maps has been obtained from various sources, and are of varying age, reliability and resolution. These maps are not intended to be used for navigation, nor are these maps an authoritative source of information about legal land ownership or public access. No warranty, expressed or implied, is made regarding accuracy, applicability for a particular use, completeness, or legality of the information depicted on this map. For more information, see the DNR Legal Notices web page: <http://dnr.wi.gov/legal/>



# Legend



Bridge



state\_highway



Streams

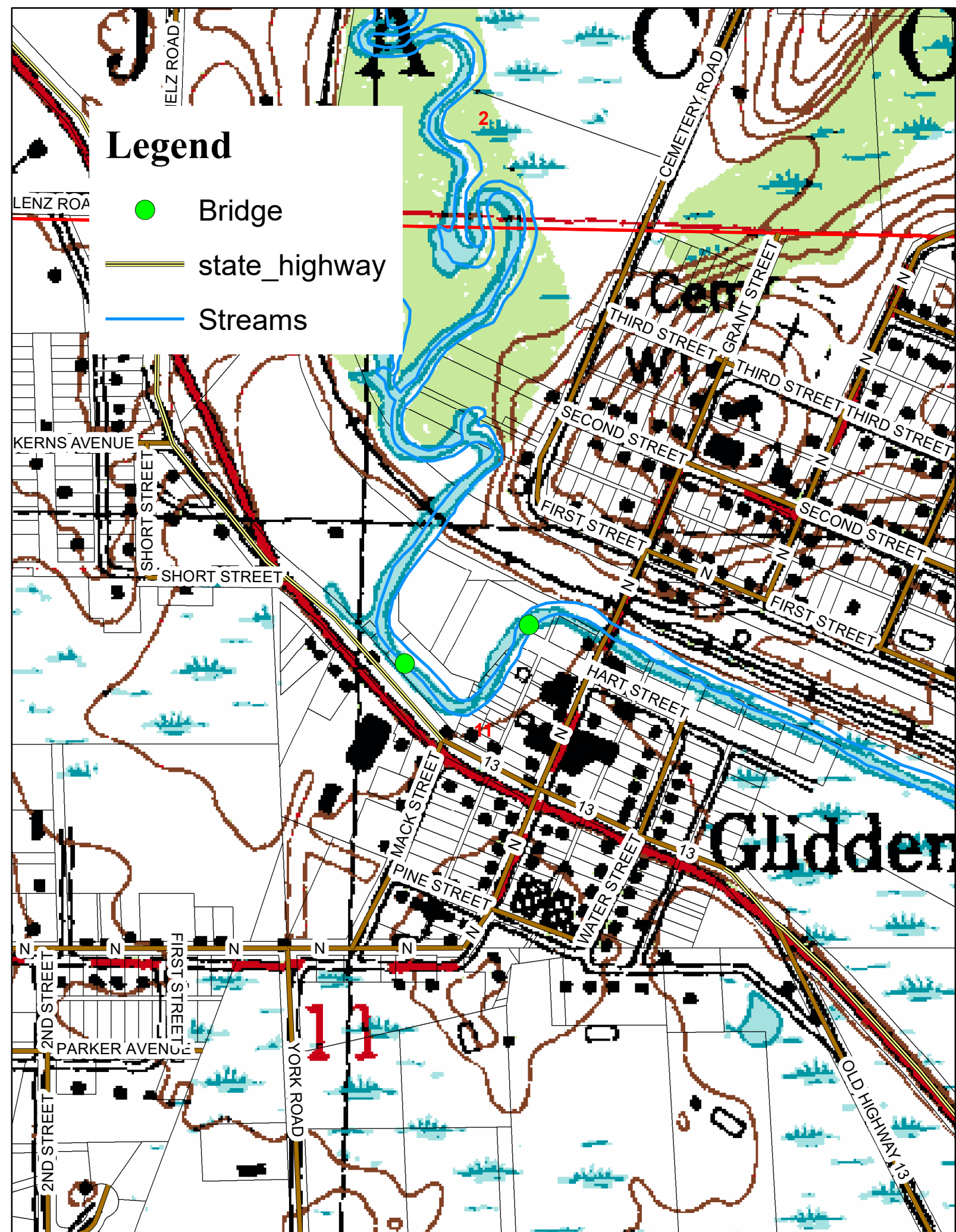



10	J	14.77
10	K	5
10	L	5
11	A	0.3
11	A	0.48
11	A	0.75
11	A	0.75
11	AA	1.42
11	B	5.6
11	B	13.56
11	C	10
11	CC	3.67
11	D	6.43
11	DD	2.97
11	E	0.79
11	EE	7.54
11	F	0.46
11	FF	8.71
11	G	0.8
11	GG	5
11	H	10.92
11	HH	15.8
11	I	2.92
11	II	2.5
11	J	1.43
11	J	0.86
11	J	0.39
11	J	2.71
11	J	1.6
11	JJ	1.3
11	K	2.57
11	K	0.56
11	K	0.72
11	K	0.57
11	K	0.38
11	K	1.12
11	K	0.34
11	K	0.34
11	K	0.69
11	K	0.34
11	K	1.12
11	K	0.55
11	K	8.59
11	KK	7.75
11	L	0.41
11	L	8
11	L	0.76
11	L	0.23
11	L	0.26
11	L	0.65
11	LL	6.04
11	M	6
11	MM	3.8
11	N	4
11	NN	8
11	O	0.34
11	OO	8
11	P	1.36
11	P	0.5
11	P	0.26
11	P	0.26
11	P	0.34

SEE PAGE 14

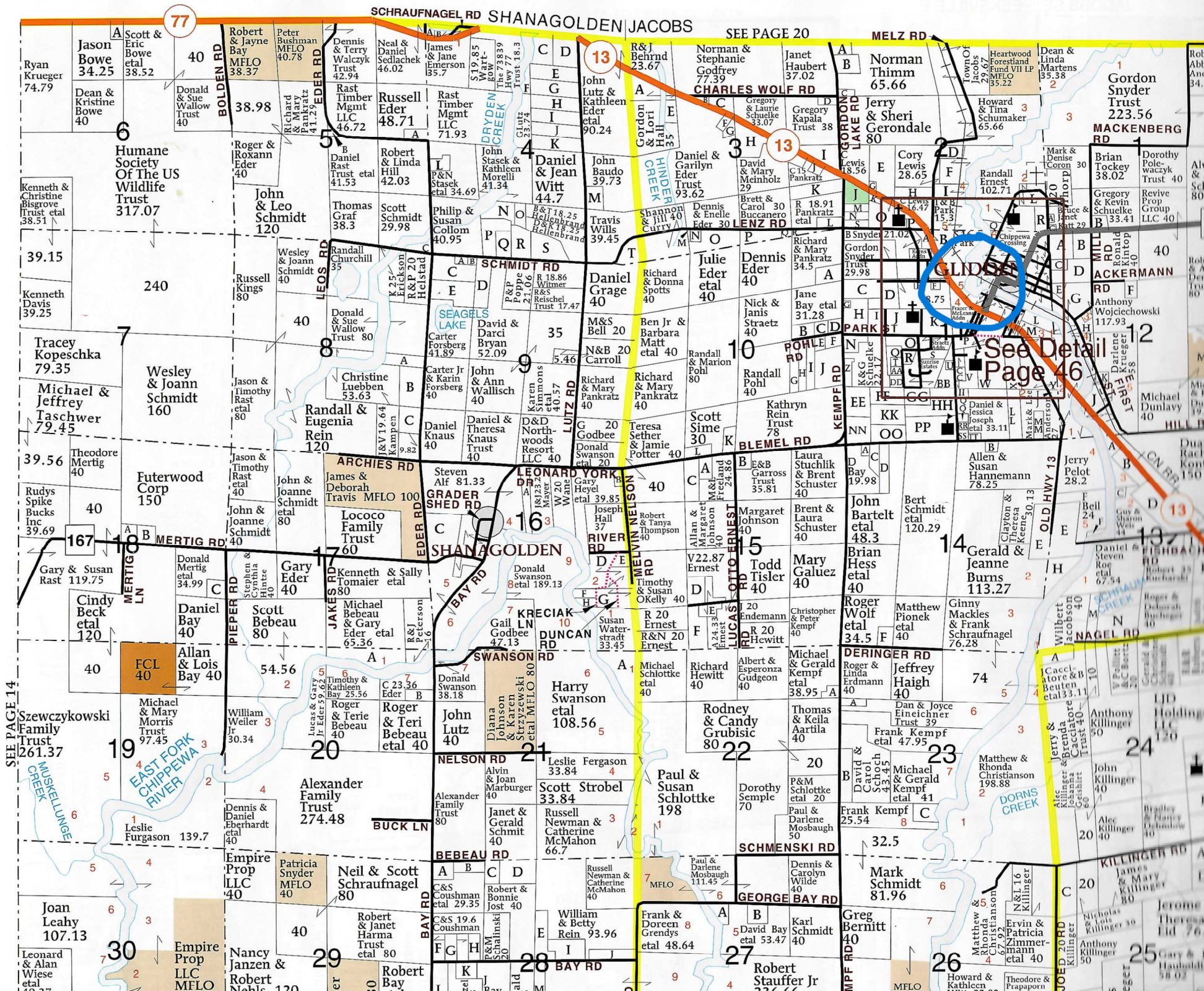

See Detail  
Page 46



