

## #14 Marathon County Little Rib River Redecking

State of Wisconsin  
 Department of Natural Resources  
[dnr.wi.gov](http://dnr.wi.gov)

### Motorized Recreation Grant Application

For: (choose all that apply)

Form 8700-159 (R 04/22)

**Due Date: April 15**

- ATV/UTV Trail Aid  
 Snowmobile Trail Aid

**Notice:** Completion of this form is required under Wisconsin Statutes 23.09(26) and 23.33. Failure to complete this form will result in denial of financial assistance. Personally identifiable information found on this form is not intended to be used for any other purpose. The Department of Natural Resources (DNR) may provide this information to requesters as required by Wisconsin's Public Records law {ss. 19.31 – 19.39, Wis. Stats.}.

**Instructions:** Applications may combine more than one source of funds. They may be submitted for consideration of traditional ATV, UTV, Snowmobile and Motorized Stewardship funding. Submit one copy of all forms and attachments. See Page 2 for necessary attachments. Send applications to your [Community Services Specialist](#).

DNR Use Only	
Category	Number

#### Section 1: Applicant Information

Applicant / Organization Name Marathon County				Check Recipient: Individual other than authorized individual to act on behalf of the applicant. <input type="checkbox"/> Select if the same as applicant.			
Individual Authorized to Act on Behalf of Applicant per Resolution Daniel Schmid				Check Recipient Name (Name to Appear on Check) Marathon County Treasurer			
Title Recreation Coordinator				Title			
Address 212 River Drive				Address 500 Forest Street			
City Wausau	State WI	ZIP Code 54403		City Wausau	State WI	ZIP Code 54403	
Telephone Number 715-262-1558		Email Address daniel.schmid@co.marathon.wi.us					

#### Section 2: Project Information Required for all Projects

Project Title Rib Knights Little Rib River Bridge Redeck				Current Funded Miles 29.99		New Miles (if applicable)	
County Marathon	Township 29 N	Range 7	Section 29	1/4 1/4 <input checked="" type="radio"/> E <input type="radio"/> W	1/4 <input checked="" type="checkbox"/>	GPS Coordinates: Lat. 44.97143 Long. 89.70999	

#### Project Description Summary

Rib Knights is seeking funding for the resurfacing/redecking of their Little Rib River Bridge. Bridge is roughly 10' x 60' and is steel construction. Has been in place for decades and is in sound condition. Serves a high traffic route for Wausau City Proper.

I certify that all maintenance land use agreements are on file.

#### Estimated Cost

Maintenance	Acquisition	Insurance	Development <b>#8,677.50</b>	Bridge Rehab.	Trail Rehab.	Total Estimated Cost
Leave Blank – DNR Use Only						

#### Applicant Certification

Printed Name of Authorized Official	Official's Title
-------------------------------------	------------------

As the applicant's authorized official, I certify that, to the best of my knowledge, the information in this application is true and correct.

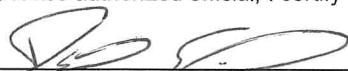
  
 Signature of Authorized Official

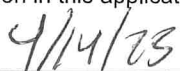
  
 Date Prepared

# Motorized Recreation Grant Application

Form 8700-159 (R 04/22)

Page 3 of 5

**Appendix A – Required for Bridge Rehab/Replace, New, or Reroute with New Bridge**

Bridge Rehab/Replace    
  New Bridge    
  Reroute with new bridge

County Marathon	Township 29 N	Range 7	<input checked="" type="radio"/> E <input type="radio"/> W	Section 29	¼ ¼	¼	GPS Coordinates: Lat. 44.97143 Long. 89.70999	
Water Body Name Little Rib River				Bridge Name Little Rib River Bridge			County Inventory Number	
Funded Trail Name or Number (SNARS if applicable) Little Rib Trail				Has this bridge site ever received development or rehabilitation funds in the past? <input type="radio"/> Yes <input checked="" type="radio"/> No    Year: _____ \$ _____				
Bridge is located on: <input checked="" type="radio"/> Private property <input type="radio"/> Public property				Old Bridge/Culvert Size    10' x 60'				
Landowner Where Bridge is Located Diane Heine & Lawrence Erdman				Telephone Number		Length of Trail Use Agreement (5 year minimum)		
Current maximum load    20,000 lbs.		Age of Bridge 33 years		Bridge Material Steel Construction, wood deck				
Proposed maximum load    20,000 lbs.								
Sponsoring Club Name Rib Knights				Club Contact Joe Bauer		Telephone Number 715-432-5543		
Do you have your trail bridges posted as to maximum load? <input checked="" type="radio"/> Yes <input type="radio"/> No				What is the maximum load of the other bridges on the system if groomed with this bridge?				
What is the weight of your puller & drag/grading equipment? 15,000								
What other recreational trail uses are planned for this bridge? Winter ATV								
If there are other Recreational uses planned, how much of the bridge cost will be paid for by non-snowmobile or non-ATV users?								

- Yes     No    Have you contacted your local [DNR Water Management Specialist \(WMS\)](#) regarding a permit?
- Yes     No    Is a permit needed? (Please provide any written correspondence from WMS.)
- Yes     No    Have you contacted your County Zoning Dept. regarding a floodplain determination?
- Yes     No    Will an H & H (hydrologic and hydraulic) study be required?

**Bridge Project Detailed Description**

Rib Knights is seeking funding for the resurfacing/redecking of their Little Rib River Bridge. Bridge is roughly 10' x 60' and is steel construction with wooden deck. Has been in place for decades and is in sound condition. Serves a high traffic route for Wausau City Proper.

**Appendix A (continued)**

**Summarize Costs in Appropriate Categories:**

<b>Bridge Structure</b>
-------------------------

**Quote 1**

Steel     Wooden

**Quote 2**

Steel     Wooden

Bridge Dimensions: \_\_\_\_\_

Bridge Manufacturer: Clu \_\_\_\_\_

Schill Construction \_\_\_\_\_

Design Weight Load \_\_\_\_\_ lbs.

\_\_\_\_\_ lbs.

Cost of Structure: 1. Engineering \$ \_\_\_\_\_

\$ \_\_\_\_\_

2. Structure \$ \_\_\_\_\_

\$ \_\_\_\_\_

**Subtotal** \$ \_\_\_\_\_

\$ \_\_\_\_\_

**Quote 1**

Contractor or  Sponsor Estimate

**Quote 2**

Contractor or  Sponsor Estimate

**Installation Costs:**

1. Engineering \$ \_\_\_\_\_

\$ \_\_\_\_\_

2. Site Preparation \$ \_\_\_\_\_

\$ \_\_\_\_\_

3. Abutments \$ \_\_\_\_\_

\$ \_\_\_\_\_

4. Pilings/Piers \$ \_\_\_\_\_

\$ \_\_\_\_\_

5. Approaches \$ \_\_\_\_\_

\$ \_\_\_\_\_

6. Riprap \$ \_\_\_\_\_

\$ \_\_\_\_\_

7. Labor \$ 2,088.00

\$ 4,100.00

8. Equipment Rental \$ 834.00

\$ 500.00

9. Culverts \$ \_\_\_\_\_

\$ \_\_\_\_\_

10. H & H Study \$ \_\_\_\_\_

\$ \_\_\_\_\_

11. Wetland Delineation \$ \_\_\_\_\_

\$ \_\_\_\_\_

12. Other \_\_\_\_\_ \$ 5,755.50

\$ 6,300.00

**Subtotal** \$ 8,677.50

\$ 10,900.00

**Total Cost** \$ 8,677.50

\$ 10,900.00

**For the application grant, you must take the lowest of the two quotes.**

<b>Entire Deck and Railing Projects</b>	<input type="radio"/> Contractor <input type="radio"/> Sponsor <input type="radio"/> Club
---	---

Bridge Dimensions: \_\_\_\_\_

Design Weight Load \_\_\_\_\_ lbs.

1. Materials \$ \_\_\_\_\_

2. Labor \$ \_\_\_\_\_

**Total** \$ \_\_\_\_\_

## Rib Knights Snowmobile Club Inc.

### Wausau, Wi

Little Rib River bridge redeck proposal/T29N. -R.7E section 29

Bridge size is 10' by 60' metal fabricated

Project plans:

Project involves removing existing wooden deck boards and disposing of them

To install new 12" by 10' rough sawn white oak lumber to deck

To level any rutting to landowners land

Materials:

Bridge decking lumber (12" x 10' white oak)	\$5148.00
---	-----------

Galvanized bolts & nuts (for fastening deck boards)	\$67.00
---	---------

Equipment:

Skid-steer-50-99 Hp 10 Hours/\$33/Hr	\$330.00
--------------------------------------	----------

Pickups 15 Hours / \$16/Hr	\$240.00
----------------------------	----------

Trailer 6 Tons 8 Hours \$26/Hr	\$208.00
--------------------------------	----------

Trailer 1-4 Tons 5 Hours \$15/Hr	\$60.00
----------------------------------	---------

Portable Electric Generator 28 Hours \$18/Hr	\$504.00
--	----------

Chainsaw 5 hours \$6.50/Hr	\$32.50
----------------------------	---------

Labor:

232 Hours/\$9.00/Hr	\$2088.00
---------------------	-----------

Total	\$8677.50
-------	-----------

# Proposal

Page # \_\_\_\_\_ of \_\_\_\_\_ pages

Schill Construction  
150215 Black Creek Dr.  
Mosinee, WI 54455  
715-370-7942

2nd Estimate

PROPOSAL SUBMITTED TO: <b>Rib Knights snowmobile club</b>		JOB NAME <b>Bridge Redeck #2</b>	JOB # <b>2</b>
ADDRESS <b>Little Rib River Bridge T29N.-R7E Section 29</b>		JOB LOCATION	
PHONE #		DATE	DATE OF PLANS <b>4/9/23</b>
FAX #		ARCHITECT <b>N/A</b>	

We hereby submit specifications and estimates for: **Resurfacing/redocking a snowmobile bridge.**

\* Bridge is roughly 10' x 60' and is steel constructed.

- 61' 12" x 10' white oak rough sawn lumber 5500\$
- 60# of Galvanized Nuts and bolts to be placed on ones 475\$
- Brushing trail for Equipment and trailer 800\$
- Fixing any trail damage (skid steer) 500\$
- Removing and disposal of old deck boards 1700\$ 85 hrs
- Reinstalling new deck boards 2400\$ 100 hrs

~~\$ 11,325~~  
~~- 475~~  

---

**\$ 10,900**









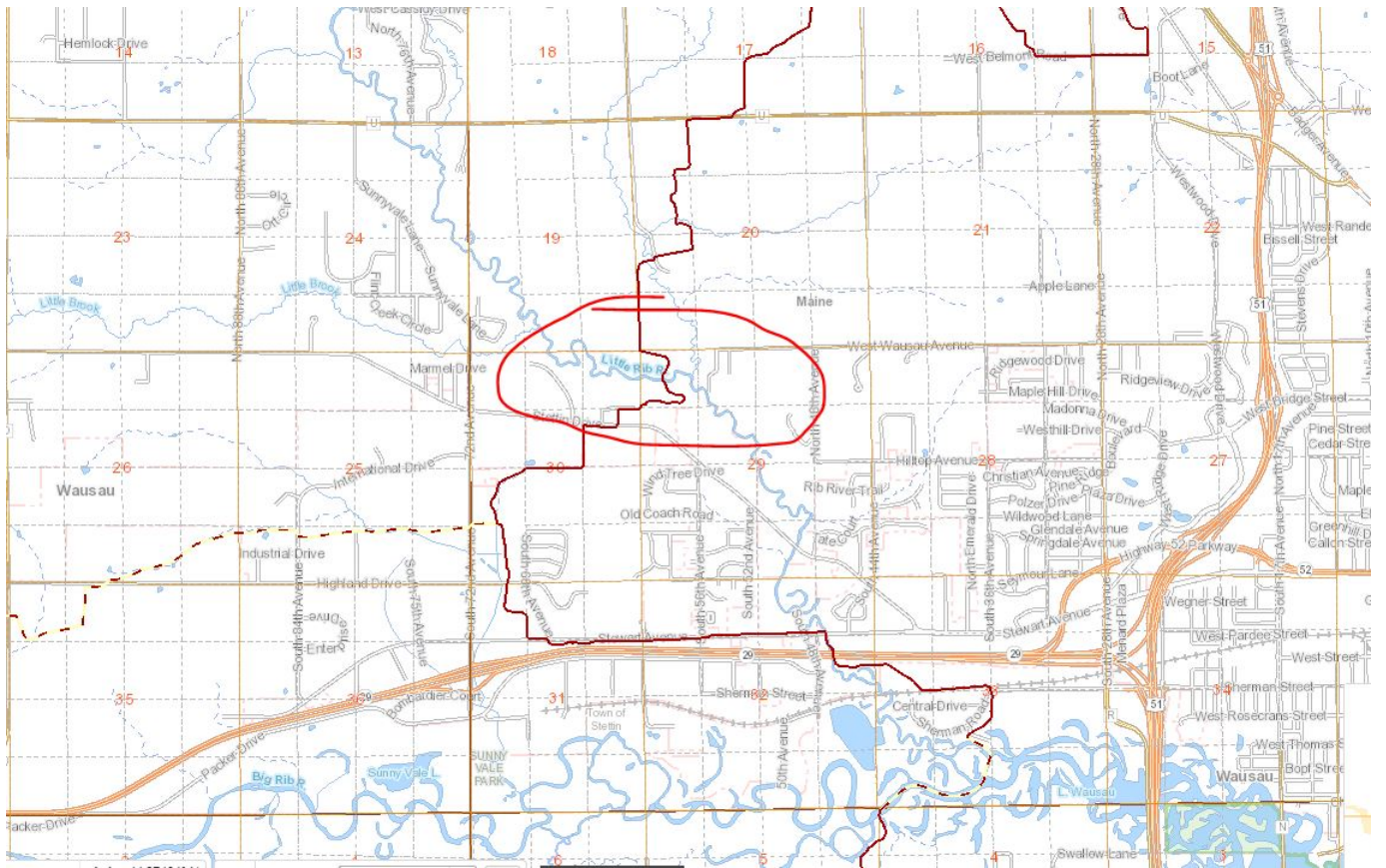

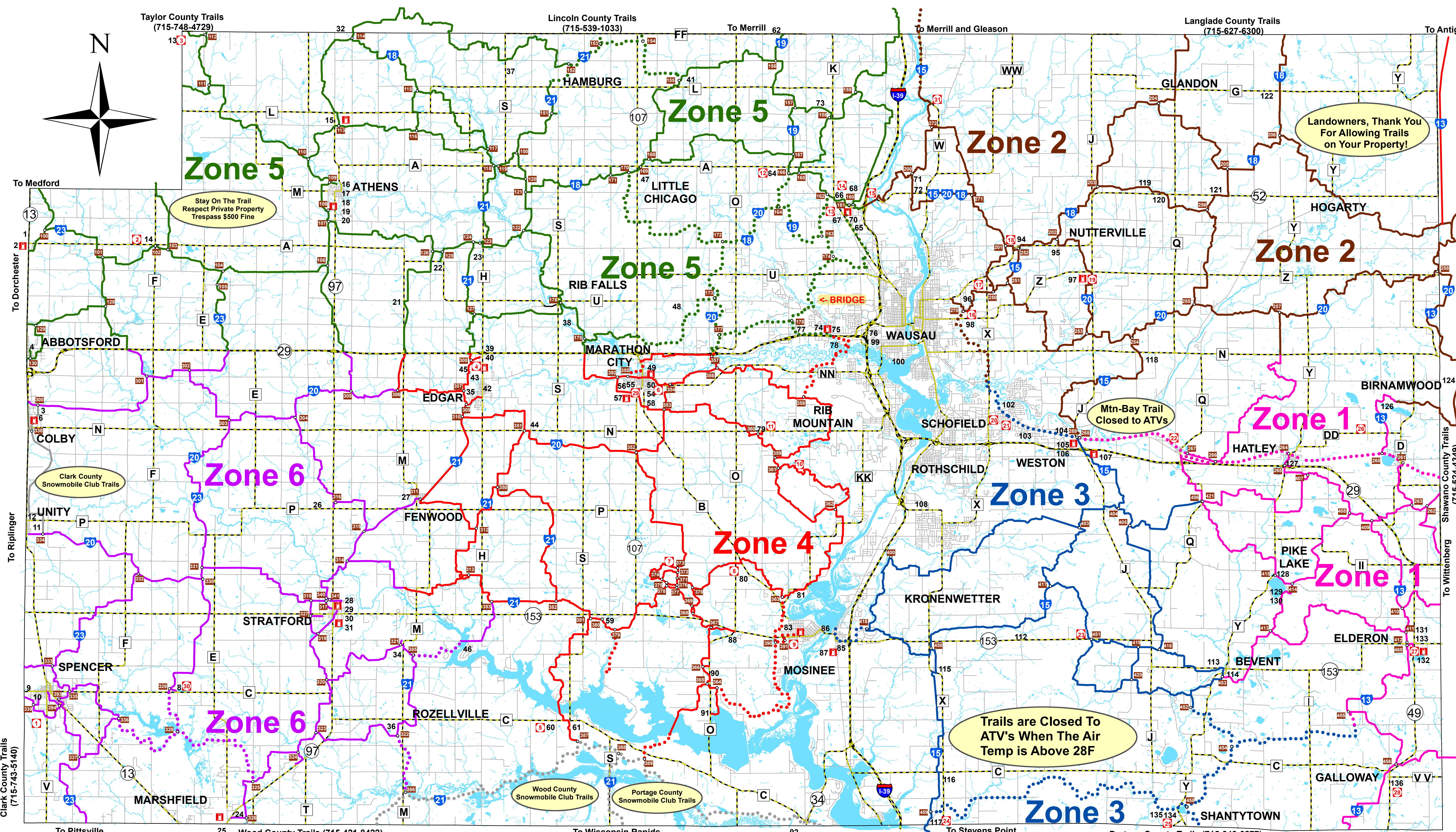

**Legend**

- Trails Open to ATV
- .... Trails Closed to ATV
- Highways
- County Roads
- Local Roads
- Lakes
- Rivers
- 23 Corridor Trails
- 196 Intersection Numbers
- F Fuel Stations
- H Hotels
- 11 Food

1-136 Map Ads (see back)

0 2.5 5 Miles

**Park And Ride**

- 1 Spencer Snowmobile Club, 403 W. Cedar St., Spencer
- 2 Jerkwater Express, 2706 Co. Rd. A, Dorchester
- 3 Gad Bar, 2423 Co. Rd. C, Medford
- 4 River Country Co-op, 127588 Opportunity Lane, Edgar
- 5 Halder Bridge Bar, 133071 Co. Rd. C, Mosinee
- 6 Marathon City Sports Center, 1200 State Hwy. 107, Marathon City
- 7 Burma Rd. County Forest, 139645 Burma Rd., Mosinee
- 8 Hammer Down Bar, 216050 Co. Rd. B, Mosinee
- 9 Mosinee Youth Baseball, 205 S. Rangeline Rd., Mosinee
- 10 Nine Mile County Forest, 221700 Red Bud Rd., Wausau
- 11 Charlie's Bar, 144746 Co. Rd. N, Marathon City
- 12 Schmidt's Ballroom Bar & Grill, 7085 Co. Rd. A, Wausau
- 13 Trailmates Snowmobile Club, 3625 Co. Rd. WW, Wausau
- 14 Pro-Motor Sports, 5900 N. 32nd Ave., Wausau
- 15 Village of Maine @ Co. Rd. WW
- 16 The Loading Zone, 2704 E. Hamilton St., Wausau
- 17 Jamar's Countryside Bar, 4011 E. Wausau Ave., Wausau
- 18 Chico's Restaurant, 235415 Chico Rd. Hwy. 52, Wausau
- 19 Sunset Country Store, 10405 Co. Rd. Z, Wausau
- 20 Mountain-Bay Trailhead, 5550 Municipal St., Weston
- 21 Dale's Weston Lanes, 5902 Schofield Ave., Weston
- 22 Mountain-Bay Trailhead, 223200 Abt Rd., Ringle
- 23 Kronenwetter Co. Forest, 4420 E. St. Hwy. 153, Mosinee
- 24 Ashley Tavern & Ballroom, 201100 Co. Rd. X, Mosinee
- 25 Corky's In Shantytown, 201282 Co. Rd. J, Rosholt
- 26 Hatley Snowmobile Club, N4480 Co. Rd. DD, Birnamwood
- 27 Elderon Food Store, 211212 St. Hwy. 49, Elderon
- 28 Jen & Tonics, 203550 St. Hwy. 49, Galloway
- 29 Marathon City Sports Center, 1200 St. Hwy. 107, Marathon
- 30 Outer Limits Food, Sports & Spirits, 109300 County Rd. C, Spencer
- 31 Wisconsin Valley Sno-Jets, 244049 County Rd. W, Wausau

- |   |  |   |  |   |  |  |
|---|--|---|--|---|--|--|
| <ul style="list-style-type: none"> <li>1 Boozler's Bar &amp; Grill</li> <li>2 River Country Co-op, Dorchester</li> <li>3 Rodeway Inn, Colby</li> <li>4 Abby Inn, Abbotsford</li> <li>6 Provision Partners C-Store, Colby</li> <li>8 Outer Limits Food, Sport &amp; Spirits</li> <li>9 Little Club</li> <li>10 Nutz Deep II North</li> <li>11 Perla's Place Bar &amp; Grill</li> <li>12 Fish and Carmen's One More Cast, Unity</li> <li>13 Gad Bar</li> <li>14 Jerkwater Express</li> <li>15 Balz Inn, Athens</li> <li>16 The Landmark Bar &amp; Grill</li> <li>17 The Hall Bar &amp; Bowl, Athens</li> <li>18 Cocina On The Square, Athens</li> <li>19 R &amp; J Athens Cafe, LLC.</li> <li>20 River Country Co-op, Athens</li> </ul> | <ul style="list-style-type: none"> <li>21 Pam's Sunshine Inn</li> <li>22 C &amp; J's Central Pub</li> <li>23 Poniatowski Dare Devils Snowmobile Club</li> <li>24 Weiler Convenience Store</li> <li>25 Power Pac Equipment &amp; Motorsports</li> <li>26 The Fresh Country Aire</li> <li>27 Illusions Bar &amp; Grill</li> <li>28 Just 4 One</li> <li>29 Bill's Service Center</li> <li>30 Telschow Oil Inc., Stratford</li> <li>31 Provision Partners C-Store, Stratford</li> <li>32 The Rundown, Taylor County</li> <li>34 Sammy's Shack</li> <li>35 Edgar Lanes, Edgar</li> <li>36 Edwin Memorial Lanes</li> <li>37 Eddie's Bar &amp; Grill</li> <li>38 Weiks Pub &amp; Grill</li> <li>39 Edgar Family Restaurant</li> </ul> | <ul style="list-style-type: none"> <li>40 River Country Co-op - Truck Stop</li> <li>41 Pagel's Pub &amp; Grub</li> <li>42 Home Bar &amp; Grill</li> <li>43 Jam'erz Bar</li> <li>44 Cassel Bar &amp; Grill</li> <li>45 E.L.M. Repair &amp; Refrigeration</li> <li>46 Hotchkiss's Last Cast</li> <li>47 Jumper's Bar</li> <li>48 Rent-A-Flash</li> <li>49 Wagner Shell, Marathon</li> <li>50 3 Amigos Mexican Bar &amp; Grill</li> <li>54 Arrow Tap Bar</li> <li>55 The Local Pub &amp; Grill</li> <li>56 Dodson Auto/Parts City</li> <li>57 Hurtis Companies</li> <li>58 Marathon City Sports Center</li> <li>60 Halder Bridge Bar</li> <li>61 Sparky's Pub</li> </ul> | <ul style="list-style-type: none"> <li>62 Schult's Country Inn</li> <li>64 Schmidt's Bar &amp; Grill</li> <li>65 Brokaw Convenience</li> <li>66 ARITE Home Exterior Specialist</li> <li>67 Trailmates Snowmobile Club</li> <li>68 Pro Motorsports</li> <li>70 Richard's Restaurant &amp; Bar</li> <li>73 Red Granite Bar &amp; Grill</li> <li>74 Burk's Bar</li> <li>75 Wagner Shell, Wausau</li> <li>76 Duwayne Kreager Insurance Center</li> <li>77 Todd &amp; Peggy's Whiskey River Bar &amp; Grill</li> <li>78 Trails End Lodge</li> <li>79 Charlie's Bar</li> <li>80 Hammer Down Bar</li> <li>81 Chang's Half Moon Lake View Bar &amp; Grill</li> </ul> | <ul style="list-style-type: none"> <li>83 Lietz's Shell Service, Mosinee</li> <li>85 Gorski's Restaurant, Mosinee</li> <li>86 Martin's Auto Repair</li> <li>87 Wagner East Town Shell, Mosinee</li> <li>88 Hog Creek Bar &amp; Grill</li> <li>90 Doyle's Moon Saloon</li> <li>91 Reservoir Dog Saloon</li> <li>92 Lynda's Wolf Den</li> <li>94 Chico's Restaurant</li> <li>95 Homestead On 52</li> <li>96 Nancy's Jamar's Country Side Bar</li> <li>97 Sunset Country Store</li> <li>98 Loading Zone</li> <li>99 FULLY PROMOTED</li> <li>100 Wausau Eagles Club</li> <li>102 Kelly Club Sports Bar &amp; Grill</li> <li>103 Dale's Weston Lanes</li> <li>104 Kluck's Callon Saloon</li> </ul> | <ul style="list-style-type: none"> <li>105 The Store, Weston</li> <li>106 Trailside Sports Bar &amp; Grill</li> <li>107 Commerce Crossing Shell, Weston</li> <li>108 Lang Equipment, LLC.</li> <li>112 Sitko's Bar</li> <li>113 Eagle Lodge Mercantile, Bevent</li> <li>114 Family Tradition Bar</li> <li>115 Hunter's Bar</li> <li>116 Z Place 2-Bn</li> <li>117 Ashley Tavern &amp; Ballroom</li> <li>118 Clubhouse Bar &amp; Grill</li> <li>119 Rick's Sunrise Bar</li> <li>120 The Corral Bar on 52</li> <li>121 Phil's Round 2</li> <li>122 Da Bar</li> <li>123 Little Rock Bar, Aniwa</li> <li>124 Chet &amp; Emil's</li> <li>125 Melody Mill</li> </ul> | <ul style="list-style-type: none"> <li>126 Wildlife Bar &amp; Campground</li> <li>127 Rightway &amp; Stratford Propane, Hatley</li> <li>128 PK Slammer's Bar &amp; Grill</li> <li>129 Pike Lake Resort</li> <li>130 Lisa's at Lakeside</li> <li>131 Mama's Place Bar &amp; Grill</li> <li>132 Elderon Food Store</li> <li>133 Straight Home Bar &amp; Grill</li> <li>134 Corky's In Shantytown</li> <li>135 Shantytown Snowmobile Club</li> <li>136 Jen &amp; Tonic's</li> </ul> |
|---|--|---|--|---|--|--|

Trails are subject to change at any time and can be found at:  
<https://www.co.marathon.wi.us/Departments/ParksRecreationForestry/Recreation/Snowmobiling.aspx>