

**Motorized Recreation Grant Application**

For: (choose all that apply)

Form 8700-159 (R 02/2024)

- ATV/UTV Trail Aid
- Snowmobile Trail Aid

**Due Date: April 15**

**Notice:** Completion of this form is required under Wisconsin Statutes 23.09(26) and 23.33. Failure to complete this form will result in denial of financial assistance. Personally identifiable information found on this form is not intended to be used for any other purpose. The Department of Natural Resources (DNR) may provide this information to requesters as required by Wisconsin's Public Records law {ss. 19.31 – 19.39, Wis. Stats.}.

**Instructions:** Applications may combine more than one source of funds. They may be submitted for consideration of traditional ATV, UTV, Snowmobile and Motorized Stewardship funding. Submit one copy of all forms and attachments. See Page 2 for necessary attachments. Send applications to your [Community Services Specialist](#).

DNR Use Only	
Category	Number

**Section 1: Applicant Information**

Applicant / Organization Name Langlade County Forestry, Parks and Recreation Dept.			Check Recipient: Individual other than authorized individual to act on behalf of the applicant. <input type="checkbox"/> Select if the same as applicant.		
Individual Authorized to Act on Behalf of Applicant per Resolution Cody Brauner			Check Recipient Name (Name to Appear on Check) Treasurer		
Title Assistant Forest Administrator			Title Treasurer		
Address 1633 Neva Road			Address 1633 Neva Road		
City Antigo	State WI	ZIP Code 54409	City Antigo	State WI	ZIP Code 54409
Telephone Number (715) 627-6300		Email Address cbrauner@co.langlade.wi.us			

**Section 2: Project Information Required for all Projects**

Project Title Langlade County Bridge 6 Rehab					Current Funded Miles	New Miles (if applicable)
County Langlade	Township 34 N	Range 10	Section 20	¼ ¼ <input checked="" type="radio"/> E <input type="radio"/> W	¼	GPS Coordinates: Lat. 45.4241 Long. -89.26847

**Project Description Summary**

Langlade County Bridge 6 was last professionally inspected in 2023 and was reported in fair condition. Since that time the bridge deck has continued to decay with failure of several deck boards and is in need of a full deck replacement. In addition the bridge was load rated and has since been posted at a 5 ton weight limit. The bridge manufacturer recommends re-decking with a double deck to bring the load rating up to 25,000 lbs. Scope of work will consist of supplying materials and labor to remove and dispose of the existing deck and to replace the railings and deck with a double deck. Contractor will also supply sealed engineered drawings to support the load limits for the bridge.

Project costs to be split 50/50 with ATV and Snowmobile. -- \$18,394.50 each.

I certify that all maintenance land use agreements are on file.

**Estimated Cost**

Maintenance	Acquisition	Insurance	Development	Bridge Rehab.	Trail Rehab.	Total Estimated Cost
				<del>\$37,089.00</del>		<del>\$37,089.00</del>
Leave Blank – DNR Use Only						
				\$36,789.00		\$36,789.00

**Applicant Certification**

Printed Name of Authorized Official Cody Brauner	Official's Title Assistant Forest Administrator
---	--

As the applicant's authorized official, I certify that, to the best of my knowledge, the information in this application is true and correct.

  
 Signature of Authorized Official

4/11/2026  
 Date Prepared

**Appendix A – Required for Bridge Rehab/Replace, New, or Reroute with New Bridge**

Bridge Rehab/Replace     New Bridge     Reroute with new bridge

County Langlade	Township 34 N	Range 10	Section 20	1/4 1/4 1/4	GPS Coordinates: Lat. 45.4241 Long. -89.26847
Water Body Name Prairie River			Bridge Name Bridge 6		County Inventory Number 6
Funded Trail Name or Number (SNARS if applicable)			Has this bridge site ever received development or rehabilitation funds in the past? <input checked="" type="radio"/> Yes <input type="radio"/> No    Year: 2002 \$ 9,757.00		
Bridge is located on: <input type="radio"/> Private property <input checked="" type="radio"/> Public property			Old Bridge/Culvert Size 12x25 New Bridge/Culvert Size		
Landowner Where Bridge is Located Langlade County			Telephone Number (715) 627-6300	Length of Trail Use Agreement (5 year minimum)	
Current maximum load	10,000 lbs.	Age of Bridge	Bridge Material		
Proposed maximum load	25,000 lbs.	23	Steel / Wood Deck		
Sponsoring Club Name Parrish Highlanders and SnoDeviIs			Club Contact	Telephone Number	
Do you have your trail bridges posted as to maximum load? <input checked="" type="radio"/> Yes <input type="radio"/> No			What is the maximum load of the other bridges on the system if groomed with this bridge? 10,000+		
What is the weight of your puller & drag/grading equipment? 25,000					
What other recreational trail uses are planned for this bridge? None.					
If there are other Recreational uses planned, how much of the bridge cost will be paid for by non-snowmobile or non-ATV users?					

- Yes  No Have you contacted your local [DNR Water Management Specialist \(WMS\)](#) regarding a permit?
- Yes  No Is a permit needed? (Please provide any written correspondence from WMS.)
- Yes  No Have you contacted your County Zoning Dept. regarding a floodplain determination?
- Yes  No Will an H & H (hydrologic and hydraulic) study be required?

**Bridge Project Detailed Description**

Scope of work will consist of supplying materials and labor to remove and dispose of the existing deck and to replace the railings and deck with a double deck. Contractor will also supply sealed engineered drawings to support the load limits for the bridge.

This bridge is permitted and re-decking will be covered as maintenance under the existing permit.

**Appendix A (continued)**

**Summarize Costs in Appropriate Categories:**

**Bridge Structure**

	Quote 1	Quote 2
	<input type="radio"/> Steel <input type="radio"/> Wooden	<input type="radio"/> Steel <input type="radio"/> Wooden
Bridge Dimensions:	_____	_____
Bridge Manufacturer:	_____	_____
Design Weight Load	_____ lbs.	_____ lbs.
Cost of Structure:		
1. Engineering	\$ _____	\$ _____
2. Structure	\$ _____	\$ _____
<b>Subtotal</b>	<b>\$ _____</b>	<b>\$ _____</b>

	Quote 1	Quote 2
	<input type="radio"/> Contractor or <input type="radio"/> Sponsor Estimate	<input type="radio"/> Contractor or <input type="radio"/> Sponsor Estimate
<b>Installation Costs:</b>		
1. Engineering	\$ _____	\$ _____
2. Site Preparation	\$ _____	\$ _____
3. Abutments	\$ _____	\$ _____
4. Pilings/Piers	\$ _____	\$ _____
5. Approaches	\$ _____	\$ _____
6. Riprap	\$ _____	\$ _____
7. Labor	\$ _____	\$ _____
8. Equipment Rental	\$ _____	\$ _____
9. Culverts	\$ _____	\$ _____
10. H & H Study	\$ _____	\$ _____
11. Wetland Delineation	\$ _____	\$ _____
12. Other _____	\$ _____	\$ _____
<b>Subtotal</b>	<b>\$ _____</b>	<b>\$ _____</b>
<b>Total Cost</b>	<b>\$ _____</b>	<b>\$ _____</b>

**For the application grant, you must take the lowest of the two quotes.**

**Entire Deck and Railing Projects**       Contractor    Sponsor    Club

Bridge Dimensions:	12x25 _____
Design Weight Load	_____ 25,000 lbs.
1. Materials	\$ 20,300 _____
2. Labor	\$ 15,550 _____
<b>Total</b>	<b>\$ 35,850 _____</b>



Guidelines for Applicant

Complete this form for each bridge structure you are submitting a grant application for. Provide any additional documents not requested on application checklist to substantiate your points, including actual deeded easements.

This ranking tool is used for both **Snowmobile** and **ATV/UTV** Trail Aids programs, though each program may score things differently. If you are seeking funding from BOTH programs for a dual use bridge, please score ALL questions

Category	Possible Points	Snow Points	ATV/UTV Points
<b>1 Condition of the Structure</b> (max of 10 points)			
Has a certified bridge inspection report that supports the project & demonstrates need. Copy of report needed. <b>Snowmobile Funded Projects</b>	10	10	
Calculation: 10 minus NBI Rating Score (0-9) <b>ATV Funded Projects</b> <i>Use overall NBI # if provided, or an average of the components. Redecking projects should just use the deck NBI #.</i>	10		3
<b>2 Permits</b> (maximum points 4)			
Consultation with DNR Water Mgmt Specialist has occurred & permit is likely, if needed	1	0	0
Permit in hand / Bridge already permitted	3	3	3
<b>3 Funding</b> (maximum points 2) Has an application been submitted for other funding			
50% or greater from other funding source(s)? (includes 50/50 Snow/ATV projects)	2	2	2
11% - 49% from other funding source(s)?	1	—	—
<b>4 Length of Written Easements or Land Use Agreement</b> (max points 5)(ch. 23.09(26)(am)1 WI Stats)			
On public land (County, State, Federal)	5	5	5
10 or more year <b>deeded easement</b> on private land or other public land, for <u>all portions</u> of that trail to the nearest road on each side of the bridge	5	—	—
3-9 year <b>deeded easement</b> on private land or other public land, for <u>all portions</u> of that trail to the nearest road on each side of the bridge	4	—	—
10 or more year <b>deeded easement</b> on private land or other public land, for <u>just the bridge</u> site	3	—	—
3-9 <b>deeded easement</b> on private land or other public land, for just the bridge site	2	—	—
10 or more year land use agreement (LUA, not deeded) on private land or other public land	1	—	—
3-9 year land use agreement (LUA, not deeded) on private land or other public land	0	—	—
<b>5 Miles Impacted</b> – How many miles will need to rerouted if the structure is not replaced? Measured from nearest intersection on both sides of the bridge. (max 4 points)			
Less than 20 miles <b>Snowmobile Funded Projects</b>	1	1	
20 miles or more <b>Snowmobile Funded Projects</b>	3	—	
No other snowmobile trails connect. <b>Snowmobile Funded</b> Explain:	4	—	
For ATV/UTV projects, describe the relocation (on routes? Trail?) Include sketch/map		—	
<b>6 If ATV/UTV, Seasons of Use</b> (max 3 points)			
Year-Round or Summer Only <b>ATV/UTV Trail</b>	3		3
Winter Only <b>ATV/UTV Trail</b>	1		—
<b>DEDUCTIONS</b>			
<b>7 County Active Project Deduction</b> (maximum deduction 1 point) A snowmobile active project is one that has exceeded it's initial grant period.			
Two or more active projects - deduct 1 point	-1	-1	
<b>GRAND TOTAL</b>		<b>20</b>	<b>16</b>



**Custom Manufacturing, Inc.**  
 606 Delco Drive, P.O. Box 279  
 Clinton, WI 53525  
 608-676-2282 Fax: 608-676-2283  
 connor@custommfginc.com

# Quotation

6805

Please Indicate The Above Number When Ordering

To: Langlade Co. Forestry Dept.  
 1633 Neva Road  
 Antigo, WI 54409

Date: February 27, 2026	Salesperson: Connor Campbell
Inquiry Date:	Inquiry Number

Estimated Ship Date 8 - 12 weeks	Shipped VIA Best Way	F.O.B Clinton, WI	Terms Net 30		
			<b>Description</b>	<b>Price</b>	<b>Total</b>
			2026 GRANT APPLICATION ESTIMATE		
			Redeck and Upgrade Existing 2002 Bridge to 25,000# Load Limit		
1			New Deck Material, Railing and Hardware for existing 2002 bridge	\$ 20,300.00	
			Stamped Engineered Drawings	\$ 2,500.00	
			Installation - Removal - Disposal	\$ 12,750.00	
			Total		\$ 35,550.00
			The above prices do not include sales tax or any necessary permits.		
			Bridge kit includes all Steel I-Beams and Crossmembers, which are predrilled and have a red oxide primer finish, MCA Southern Yellow Pine treated lumber and all hardware. All lumber is Pre-Stained.		
			Bridge Kit Meets - WI DNR Guidelines - 25,000# Load		

We are pleased to submit the above quotation for your consideration. Should you place an order, be assured it will receive our prompt attention. This quotation is valid for 30 days. Thereafter it is subject to change without notice.

BY: Connor Campbell

ACCEPTED: \_\_\_\_\_

DATE: \_\_\_\_\_

# Bridge 6 Rehabilitation Project

Langlade County Wisconsin

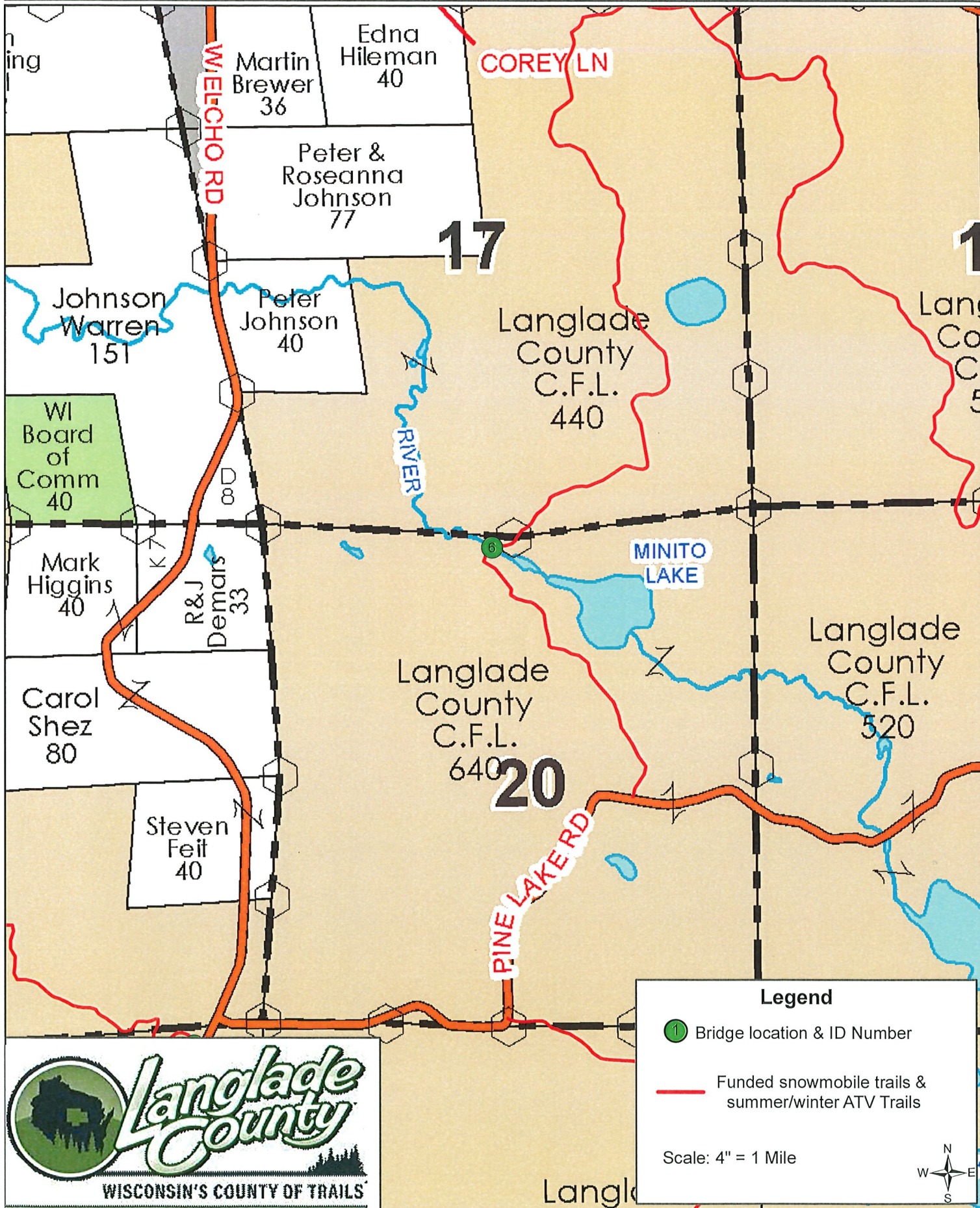

# Bridge 6 Rehabilitation Project

## Langlade County Wisconsin

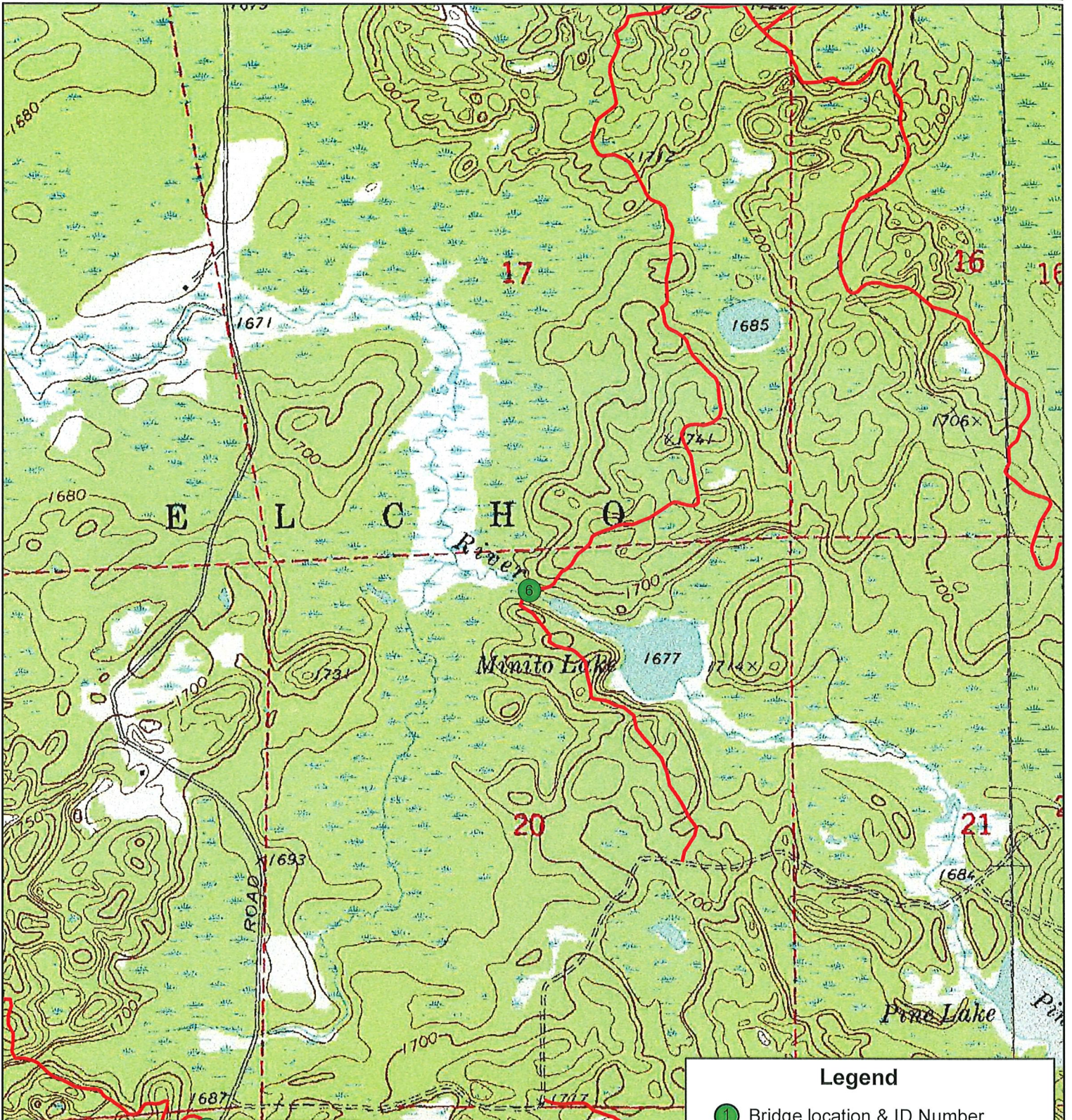

### Legend







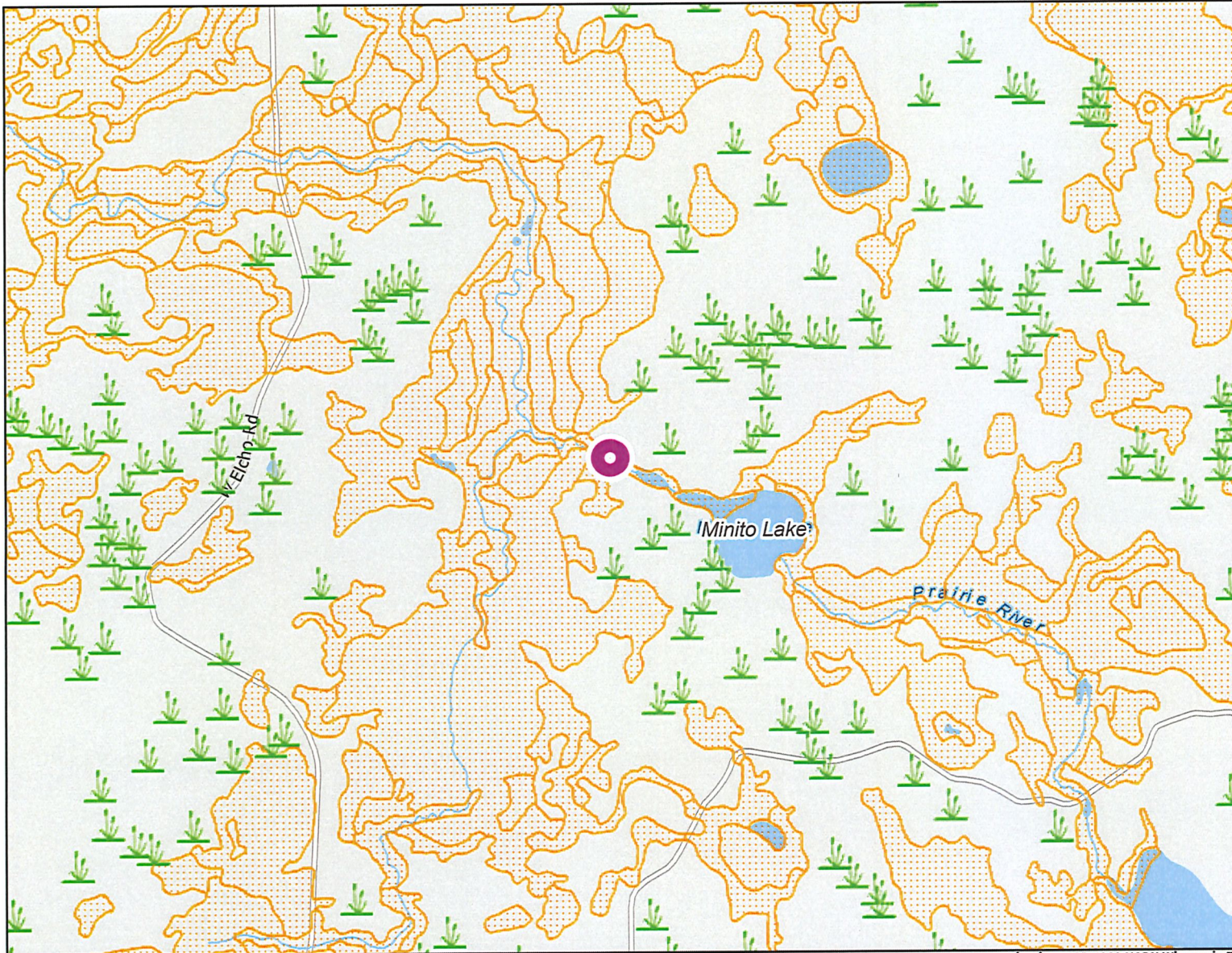





-  Bridge location & ID Number
-  Funded snowmobile trails & summer/winter ATV Trails

Scale: 4" = 1 Mile





**Legend:** (some map layers may not be displayed)

- Wetland Class Points
  -  Wetland too small to delineate
- Wetland Class Points
  -  Wetland too small to delineate
- Wetland Class Areas
  -  Wetland Class Areas
  -  Wetland Class Areas
- Wetland Class Points
  -  Wetland too small to delineate
- Wetland Class Points
  -  Wetland too small to delineate
  -  Wetland Class Areas
  -  Wetland Class Areas
- Rivers and Streams
  -  Rivers and Streams
  -  Intermittent Streams
- Open Water
  -  Open Water
- Rivers and Streams
  -  Rivers and Streams
  -  Intermittent Streams

**Notes:**

Scale: 1:15,840

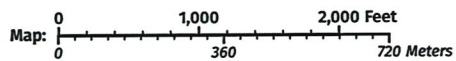

Service Layer Credits:  
 DNR Basic Feature VTL (WTM): Wisconsin Department of Natural Resources, GIS Section, Surface Water;  
 WiDNR, USGS, and other data, Wetland Inventory NWI (Cached);

Map projection: NAD 1983 HARN Wisconsin TM

This map is a product generated by a DNR web mapping application.

This map is for informational purposes only and may not have been prepared for or be suitable for legal, engineering, or surveying purposes. The user is solely responsible for verifying the accuracy of information before using for any purpose. By using this product for any purpose user agrees to be bound by all disclaimers found here: <https://dnr.wisconsin.gov/legal>

Date Printed: 3/11/2026 8:00 AM







# Trail Bridge Inspection

## Langlade County

**Bridge #**  
6

**Inspected By:**  
William S. Knaack Jr., P.E.  
William S Knaack Sr.

10/6/2023

**Prepared By**  
KBIS, LLC





W7218 Hickory Lane  
Phillips, WI 54555  
wm.kbis@gmail.com  
715.820.0095

## Bridge Inspection Report

---

### General Information

The structure in this report was inspected by certified Wisconsin Department of Transportation Bridge Inspectors. William S Knaack Jr., P.E., is Program Manager, Team Leader, Fracture Critical Inspector, and Underwater Inspector qualified. William S Knaack Sr, is Program Manager, Team Leader qualified.

The bridge was inspected with trail use in mind, using normal vehicle bridge standard to determine the condition of the structure.

All recommendations made in the report are also considering the use of the trail. Trail bridges in general should have a load rating considering all the possible uses of the structure. Even though the bridges may be just for snowmobiles, several types of vehicles may use the structure.

KBIS, recommends as a minimum that bridge owners load rate all the structures in their inventory and post a single ton sign at each bridge. It is a "insurance" policy for the owner if the bridge is damaged by a user that should not be using the structure. Also, grooming/trail equipment is getting large every year, so bridges again should be rated.

### Location information/General Description:

Lat and Long: See attached map.

### Bridge Condition

Wearing surface is covered with gravel preventing a complete inspection.

Railing has 8 LF of damage, SE and SW corner.

NW and SE object markers have minor damage.

Both Bridge Ahead signs have minor damage.

Both Caution signs have minor damage.

Both approaches to the bridge are good.

6 diaphragms per girder bay, good.

Scour around both abutments

Girders have CS2 corrosion, minor rust.

Abutments are twin timber planks forming a sill, good condition.

Length 25 ft, Width 12 ft. Clearance 3+ft, 5 steel girders,



W7218 Hickory Lane  
Phillips, WI 54555  
wm.kbis@gmail.com  
715.820.0095

## Bridge Inspection Report

### Report Summary

**NBI Ratings: 9-7 Good, 6-5 Fair, 4-3 Poor, 2-1 Critical, 0-Closed**

Deck	# 6
Superstructure	# 7
Substructure	# 6
Channel	# 7

Overall Condition Fair

### **Recommendations/Maintenance Items:**

**The brush needs to be cut 4 ft away from the bridge, around the entire bridge. It is not good for any part of that bridge. Throw the brush away from the bridge not to impede the next inspection. The brush on this bridge is particularly ridiculous. Get the brush around all the signs also.**

**The bridge should be cleaned annually. Keep all components clear of soil, trees, debris. Gravel and soil on the deck shorten the life span of the wood greatly.**

This bridge is open to all vehicles. The bridge needs a load rating done and signs placed to protect the user and Langlade County. KBIS can do the load rating and provide the calculations and tonnage for the signs. I have informed the Highway Commissioner that I am recommending to you to that this bridge needs tonnage signs for public safety.

Repair railing boards on SE and SW corners.

Grout in the bottom of the sill plates on both abutments.

Signed By:

William S. Knaack Jr., P.E.

10/6/23

Date

## Bridge Inspection Report

### Photo Observations



Looking West, damaged railing.

## Bridge Inspection Report

### Photo Observations



CS2 corrosion, typ.

## Bridge Inspection Report

### Photo Observations



Stacked timber sill

## Bridge Inspection Report

### Photo Observations

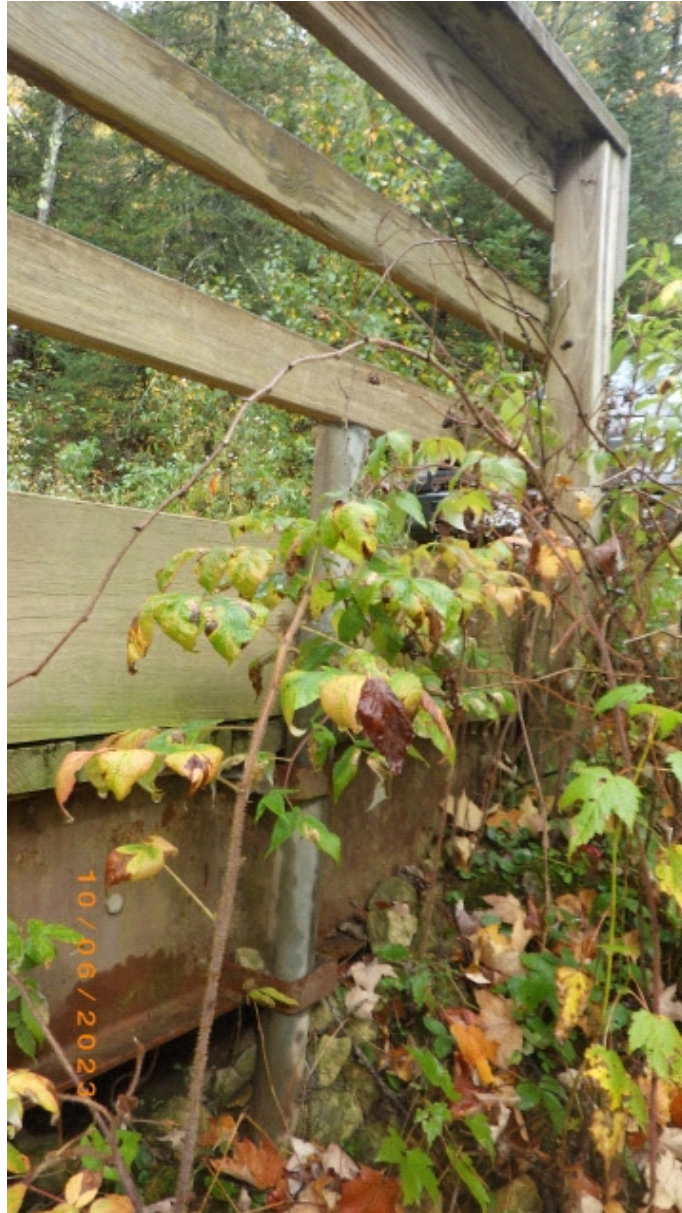

Steel post staking bridge in place, all 4 corners.

## Bridge Inspection Report

---

### Photo Observations



North Bridge Ahead sign

## Bridge Inspection Report

### Photo Observations



Looking South

## Bridge Inspection Report

### Photo Observations



SE C2 Object marker.

## Bridge Inspection Report

### Photo Observations



Damage railing.

## Bridge Inspection Report

### Photo Observations



North Sign, minor damage.

# Langlade County

## Bridge 6 Location

